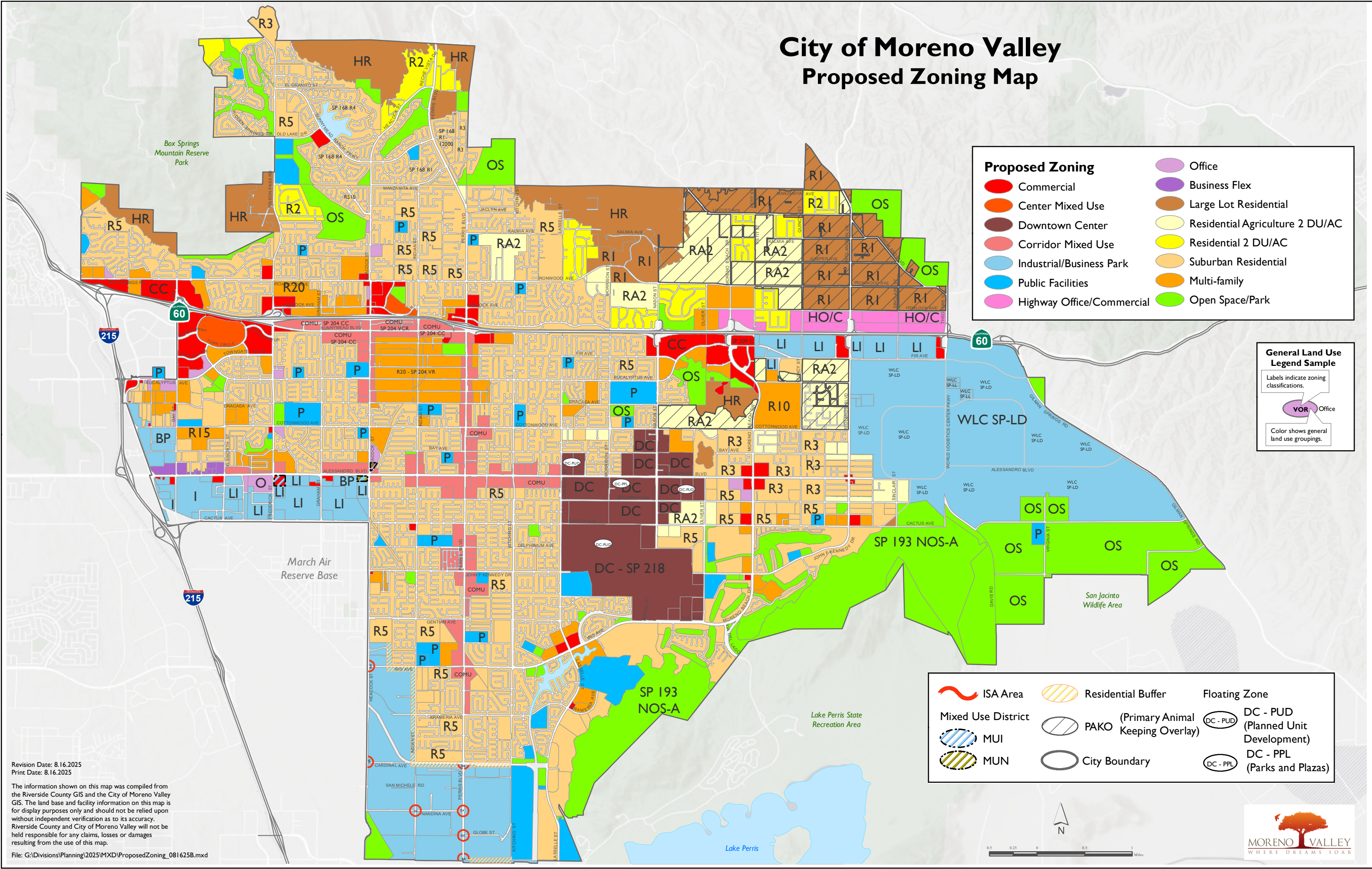

Exhibit B: Map Amendments

City of Moreno Valley Proposed Zoning Map



Proposed Zoning	
●	Commercial
●	Center Mixed Use
●	Downtown Center
●	Corridor Mixed Use
●	Industrial/Business Park
●	Public Facilities
●	Highway Office/Commercial
●	Office
●	Business Flex
●	Large Lot Residential
●	Residential Agriculture 2 DU/AC
●	Residential 2 DU/AC
●	Suburban Residential
●	Multi-family
●	Open Space/Park

General Land Use Legend Sample

Labels indicate zoning classifications.

VOR Office

Color shows general land use groupings.

~	ISA Area	DC - PUD	DC - PUD (Planned Unit Development)
MUI	Mixed Use District	DC - PPL	DC - PPL (Parks and Plazas)
MUN		PAKO	PAKO (Primary Animal Keeping Overlay)
City Boundary	City Boundary		
Residential Buffer	Residential Buffer		
		Floating Zone	

Revision Date: 8.16.2025
Print Date: 8.16.2025

The information shown on this map was compiled from the Riverside County GIS and the City of Moreno Valley GIS. The land base and facility information on this map is for display purposes only and should not be relied upon without independent verification as to its accuracy. Riverside County and City of Moreno Valley will not be held responsible for any claims, losses or damages resulting from the use of this map.

File: G:\Divisions\Planning\2025\IMXD\ProposedZoning_081625B.mxd

PEN25-0020 – MoVal 2040 Project: 2040 General Plan Update, Municipal Code and Zoning (including Zoning Atlas) Amendments, and Climate Action Plan

City of Moreno Valley Zoning Atlas			
<u>Revised Sheet Numbers</u>			
47	71	97	128
50	72	98	140
51	75	99	141
52	81	100	155
56	82	111	
57	83	112	
58	84	113	
59	85	114	
68	86	125	
70	87	126	

The information shown on this map was compiled from the Riverside County GIS and the City of Moreno Valley GIS. The best care and utility of information on this map is for display purposes only and should not be relied on as a book. The reader is cautioned to be accurate. Riverside County is the City of Moreno Valley and for the best results, please refer to the City of Moreno Valley GIS.

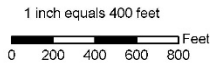
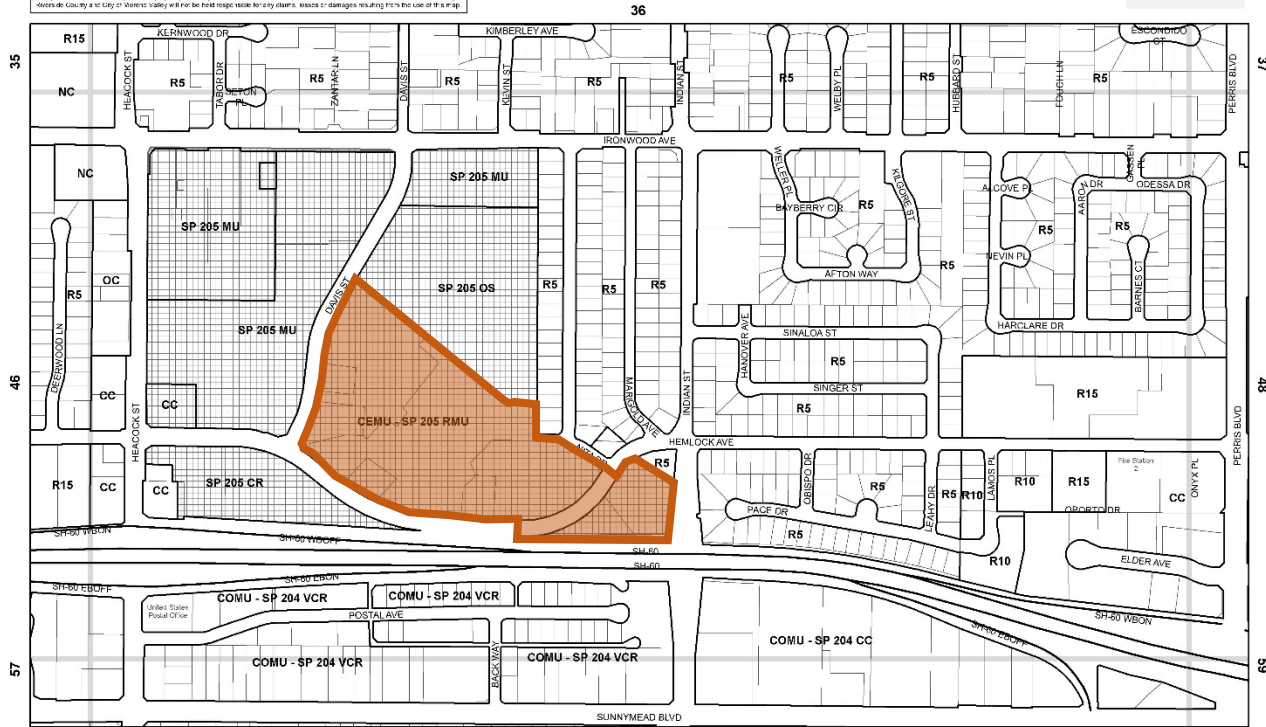

City of Moreno Valley Zoning Atlas



47

Current Zoning: SP 205 RMU
Proposed Zoning: CEMU SP 205 RMU



The information shown on this map was compiled from the Kinross County GIS and the City of Moreno Valley GIS. The base and utility information on this map is for display purposes only and should not be used as a final record or contractor site to its accuracy. Kinross County and City of Moreno Valley will not be held liable for any errors, omissions or damages resulting from the use of this map.

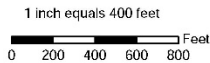
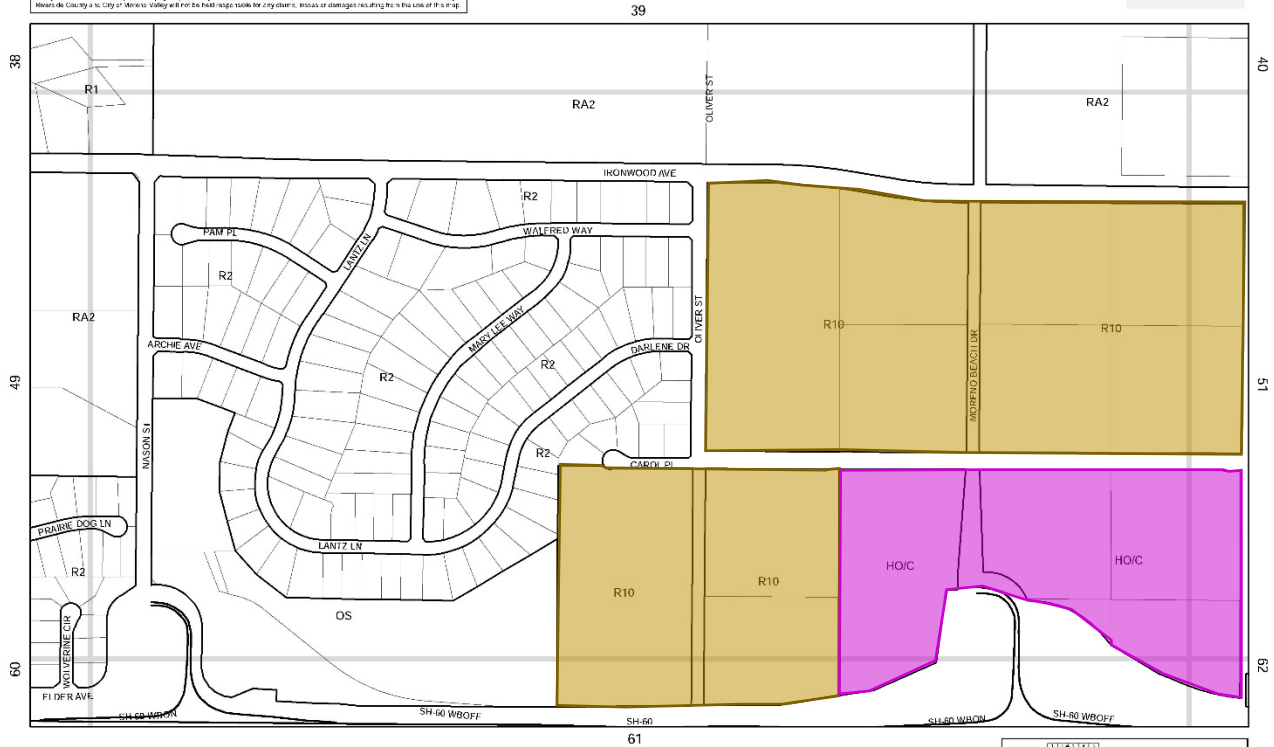

City of Moreno Valley Zoning Atlas

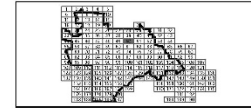

50

Current Zoning: R2 & RA2
Proposed Zoning: R10



Current Zoning: OC
Proposed Zoning: HO/C



The information shown on this map was compiled by the Riverside County GIS and the City of Moreno Valley GIS. The information is for informational purposes only and should not be relied upon without independent verification. Riverside County and City of Moreno Valley will not be responsible for any claims, losses or damages resulting from the use of this map.

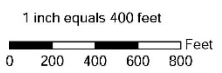
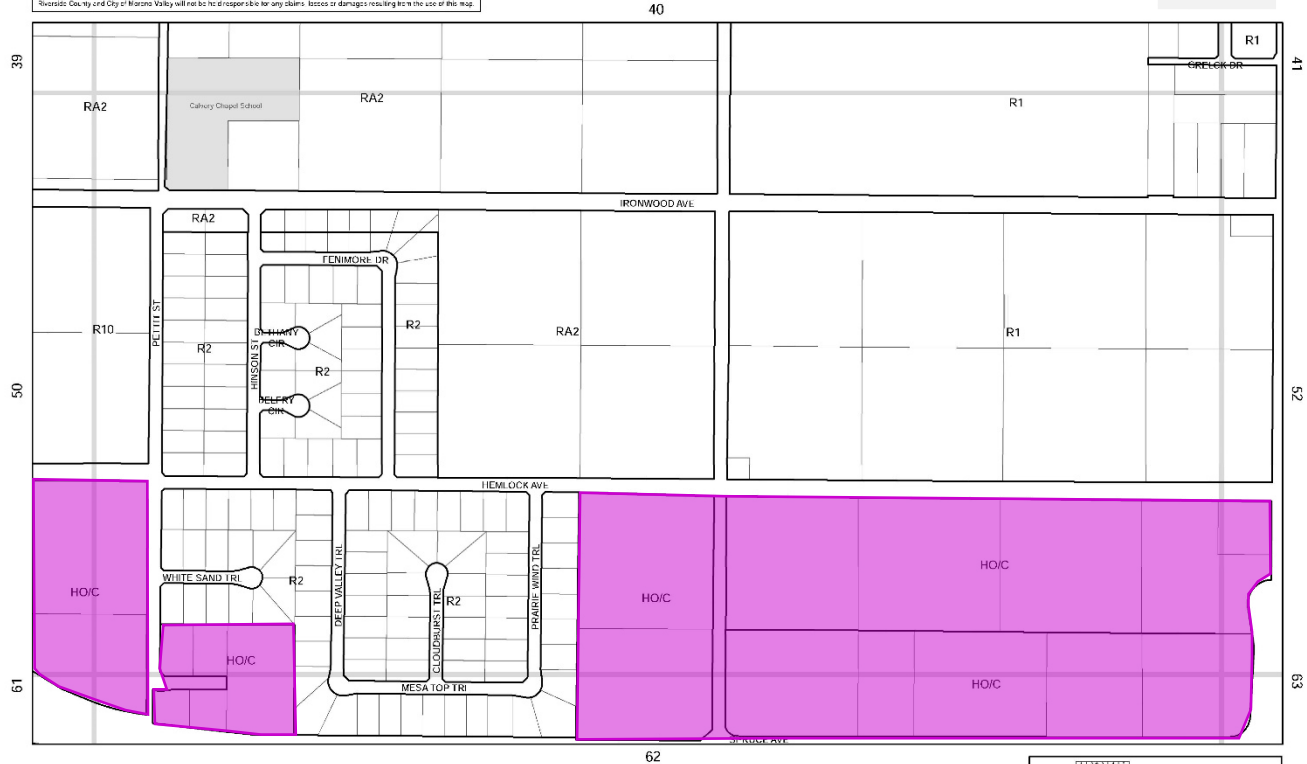

City of Moreno Valley Zoning Atlas

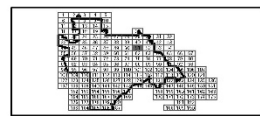

Current Zoning: R1, R2, RA2 & O
 Proposed Zoning: HO/C

An electronic version of this map was originally filed in the Kern County GIS and the City of Moreno Valley GIS. The board has a right to be notified of any changes to the map and shall be notified by the City of Moreno Valley. The City of Moreno Valley will not be liable for any claims, losses or damages resulting from the use of this map.

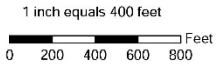
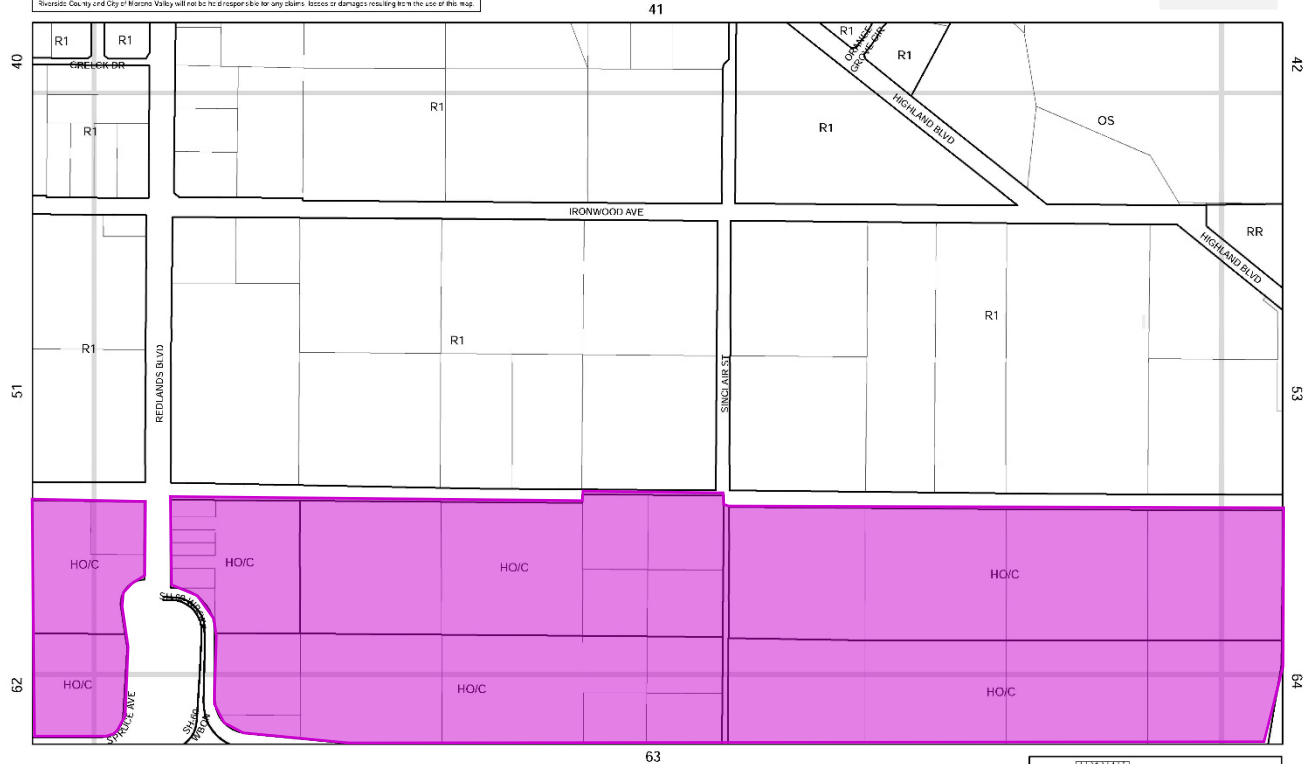

City of Moreno Valley Zoning Atlas



Current Zoning: R1 & O
Proposed Zoning: HO/C

All information shown on this map was compiled by the Inland Empire GIS for the City of Moreno Valley GIS. The City of Moreno Valley is not responsible for any errors or omissions on this map. Inland Empire GIS is not responsible for any errors or omissions on this map. Riverside County and City of Moreno Valley will not be held responsible for any claims, losses or damages resulting from the use of this map.

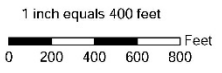
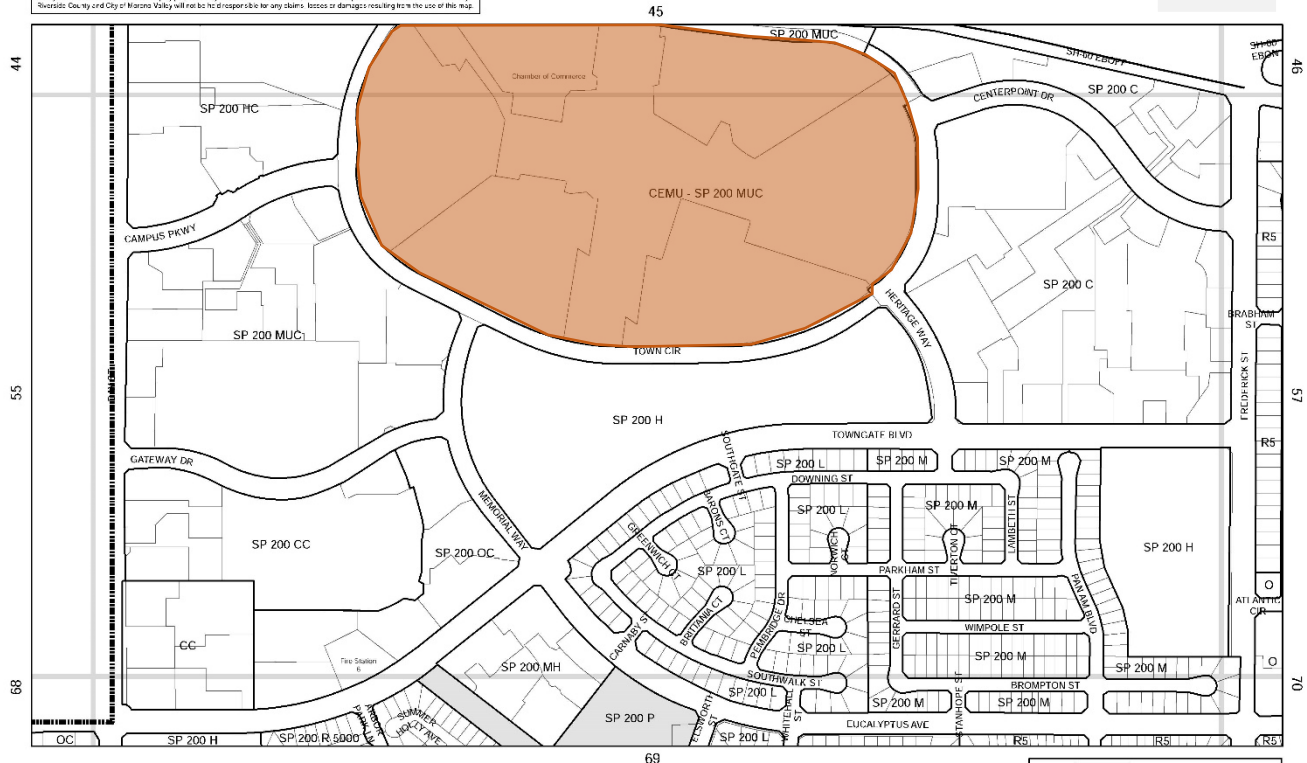

City of Moreno Valley Zoning Atlas

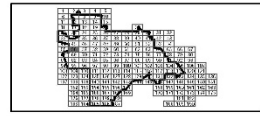

Current Zoning: SP 200 MUC
 Proposed Zoning: CEMU SP 200 MUC

The information shown on this map was compiled from the Incentive Company GIS and the City of Moreno Valley GIS. The board makes a best effort to ensure the information on this map is for informational purposes only and does not constitute a warranty, representation or endorsement. Riverside County and City of Moreno Valley will not be held responsible for any claims, losses or damages resulting from the use of this map.

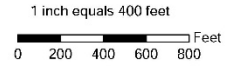
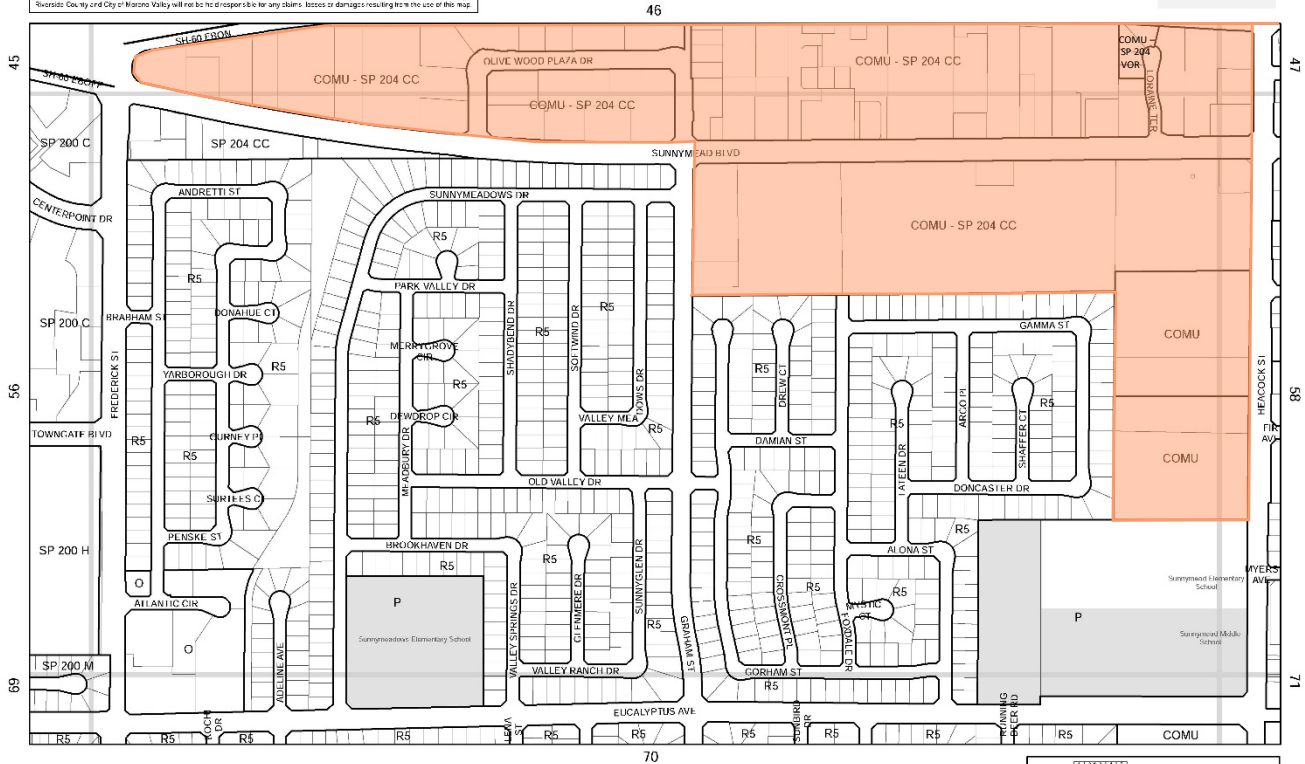

City of Moreno Valley Zoning Atlas



Current Zoning: SP 204 CC & VOR	
Proposed Zoning: COMU- SP 204 CC & VOR	
Current Zoning: CC & O	
Proposed Zoning: COMU	

The information shown on this map was compiled by the Riverside County GIS and the City of Moreno Valley GIS. The board does not warrant information on this map for planning purposes only and does not warrant to any other. The City of Moreno Valley and the City of Riverside County will not be held responsible for any claims, losses or damages resulting from the use of this map.

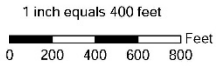
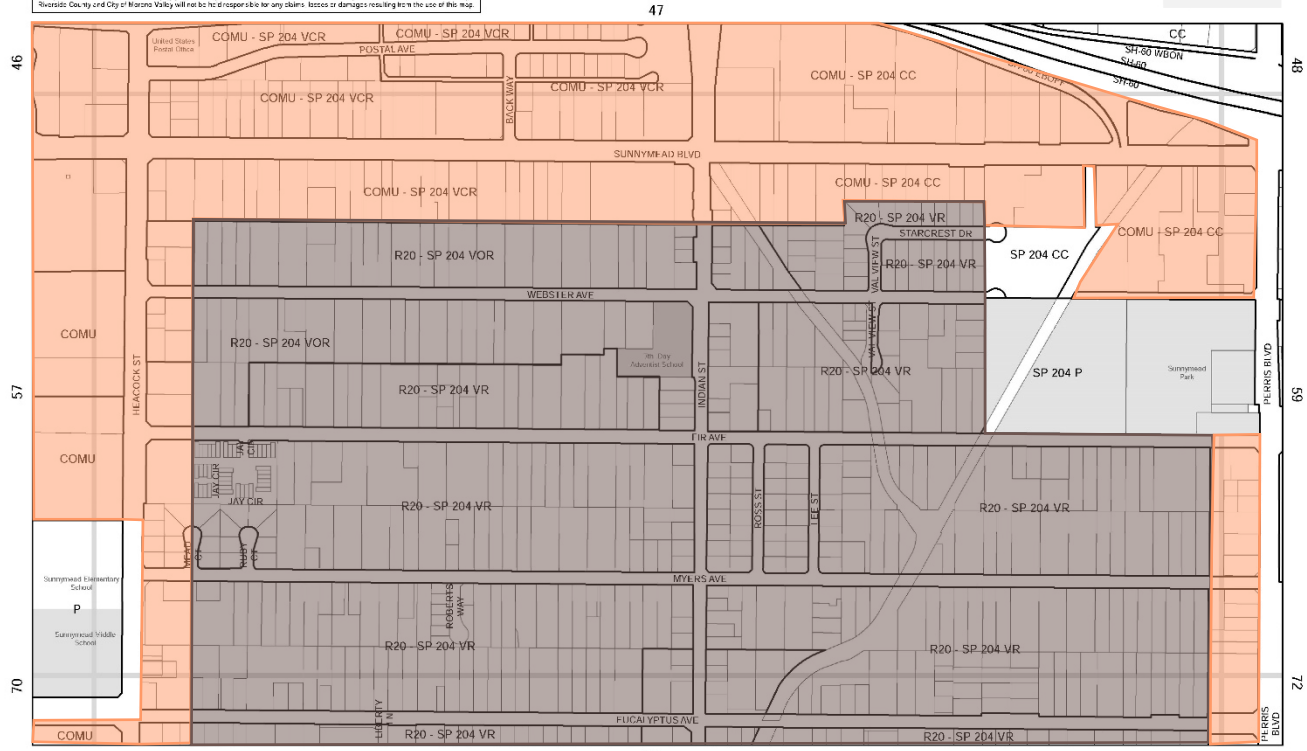

City of Moreno Valley Zoning Atlas



Current Zoning: SP 204 CC, VCR & VOR
 Proposed Zoning: COMU- SP 204 CC, VCR & VOR

Current Zoning: CC & O
 Proposed Zoning: COMU

Current Zoning: SP 204 VR
 Proposed Zoning: R20 - SP 204 VR

The information shown on this map was compiled from the Riverside County GIS and the City of Moreno Valley GIS. The lot, area and zoning information on this map is for display purposes only and should not be used for a final decision. No warranty is made by the City of Moreno Valley for the accuracy of the information shown on this map. Errors or omissions notwithstanding, the City of Moreno Valley will not be held liable for any claims, losses or damages resulting from the use of this map.

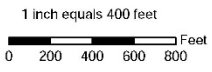
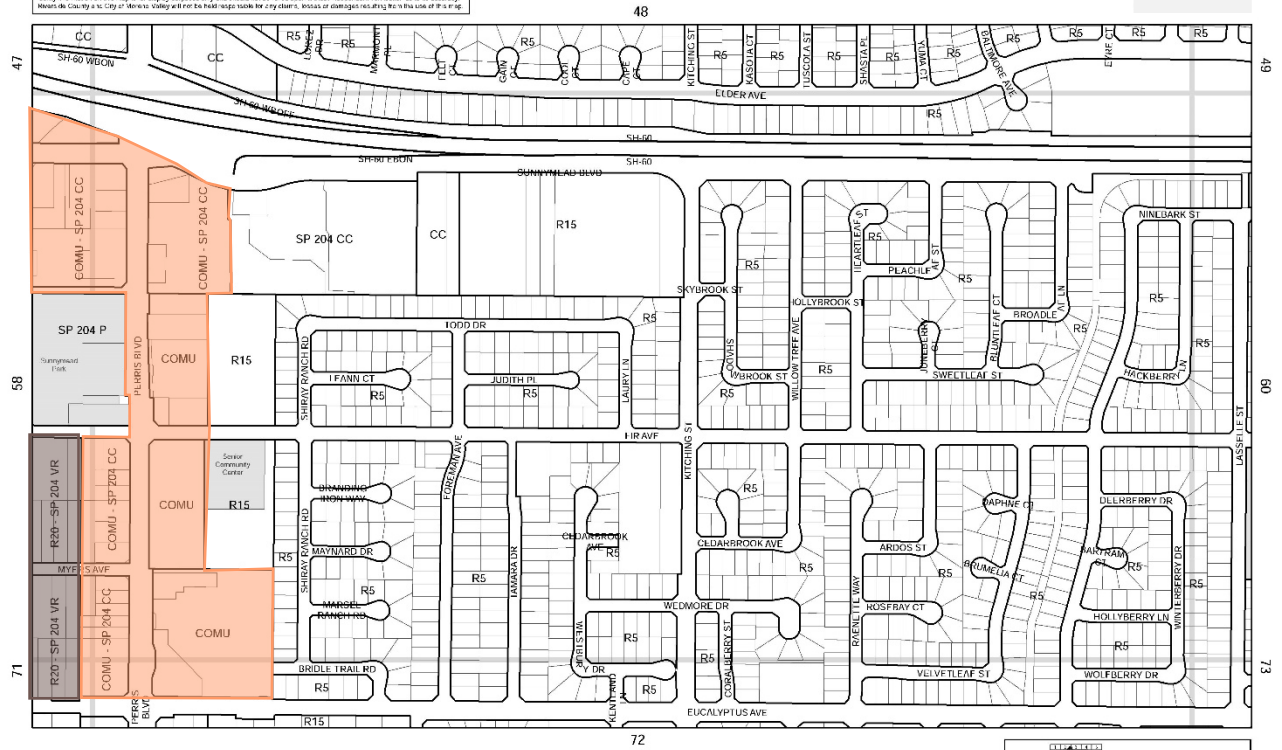

City of Moreno Valley Zoning Atlas

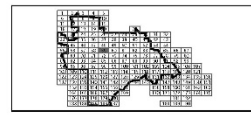

59

Current Zoning: SP 204 CC
Proposed Zoning: COMU- SP 204 CC

Current Zoning: SP 204 VR
Proposed Zoning: R20 - SP 204 VR

Current Zoning: NC, R10 & O
Proposed Zoning: COMU

The information shown on this map was compiled by the Riverside County GIS and the City of Moreno Valley GIS. The information is for informational purposes only and does not constitute a warranty. Neither Riverside County nor the City of Moreno Valley will be held responsible for any claims, losses or damages resulting from the use of this map.

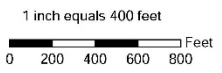
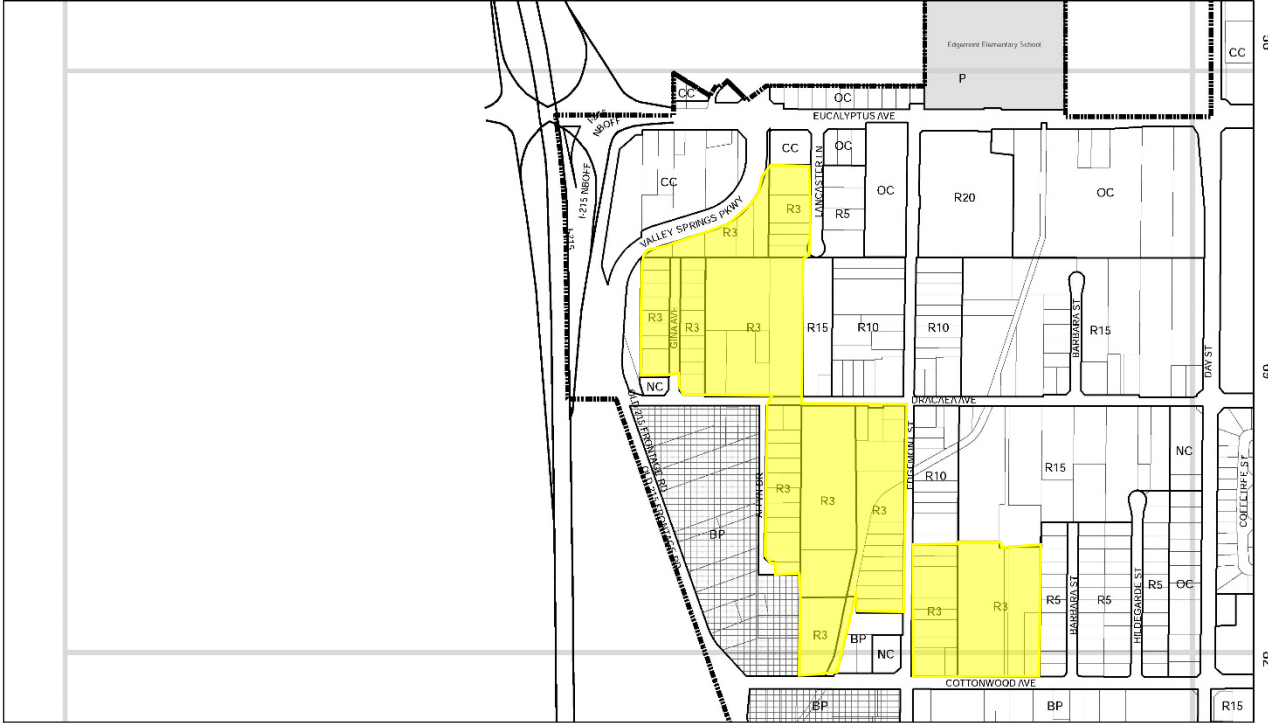

City of Moreno Valley Zoning Atlas

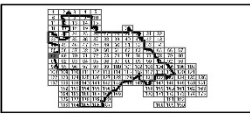

Current Zoning: OC, R5, R10 & R15
Proposed Zoning: R3

The information shown on this map was compiled by the Moreno Valley GIS Unit for the City of Moreno Valley, CA. The board has a right to be updated as the map is for planning purposes only and does not constitute an offer. The City of Moreno Valley, CA, its Board of Directors, City and County of Moreno Valley will not be held responsible for any claims, losses or damages resulting from the use of this map.

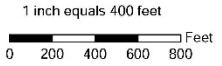
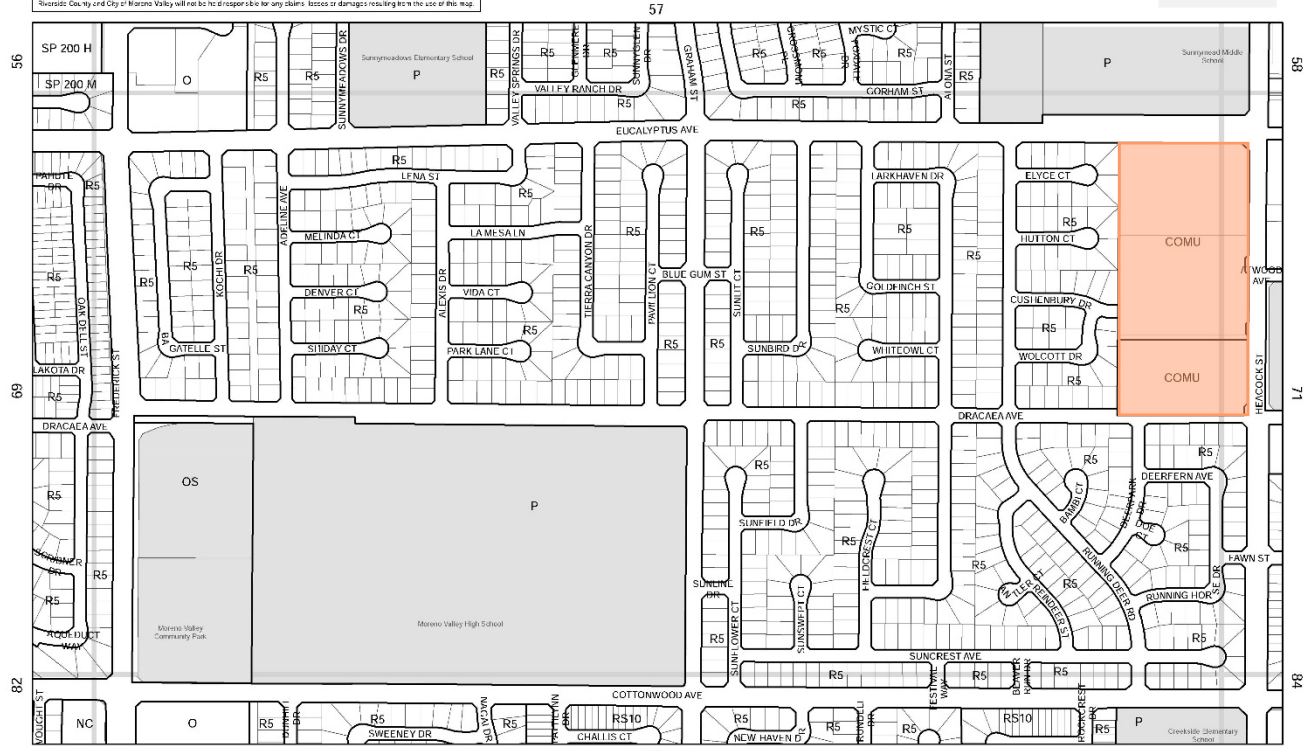

City of Moreno Valley Zoning Atlas



Current Zoning: R20
Proposed Zoning: COMU



The information shown on this map was compiled by the Riverside County GIS via the City of Moreno Valley GIS. The best source of the City information on this map is for display purposes only and should not be relied upon without independent verification as to its accuracy. Riverside County and City of Moreno Valley will not be responsible for any claims, losses or damages resulting from the use of this map.

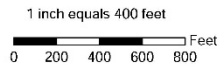

City of Moreno Valley Zoning Atlas



<p>Current Zoning: O, OC, R10 & CC Proposed Zoning: COMU</p>	
<p>Current Zoning: SP 204 CC Proposed Zoning: COMU – SP 204 CC</p>	

All information shown on this map was compiled from the Riverside County GIS data for the City of Moreno Valley (CM). This map does not constitute an official map of the City of Moreno Valley. The City of Moreno Valley is not responsible for any claims, losses or damages resulting from the use of this map.

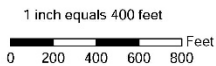
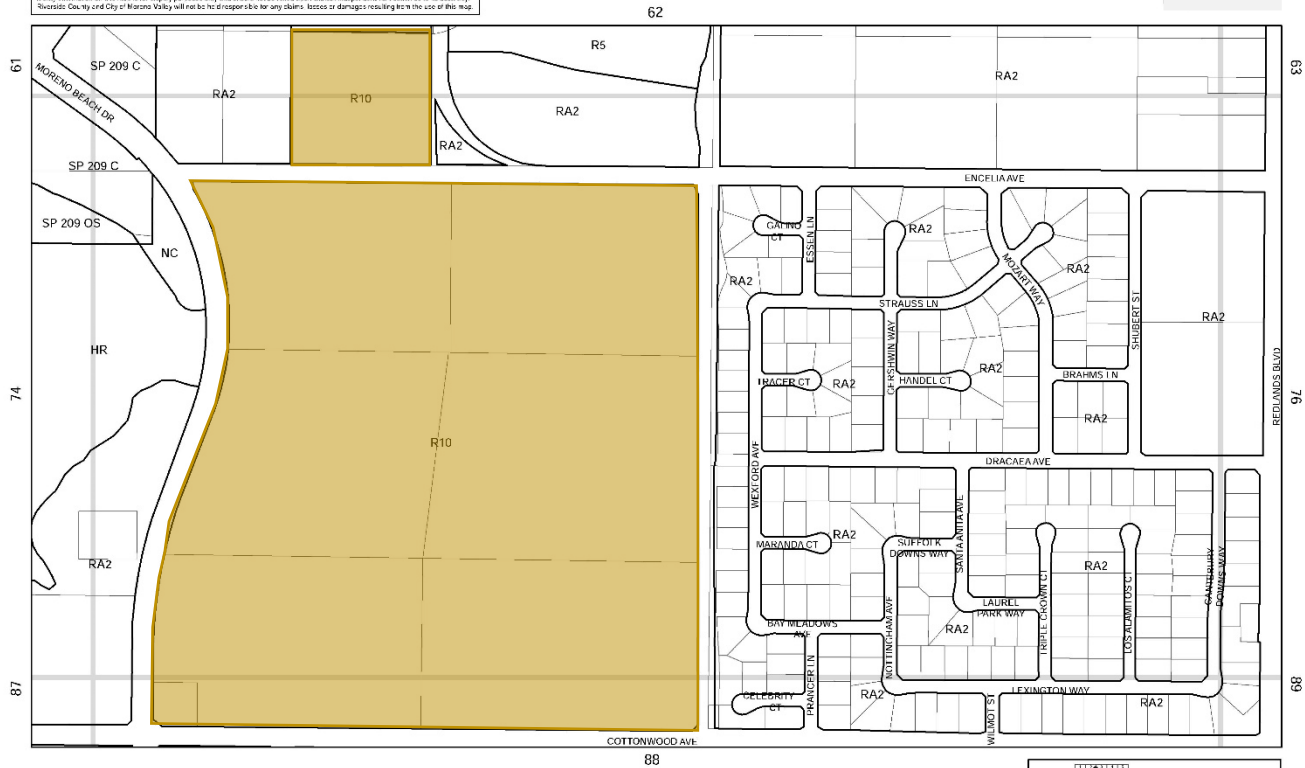

City of Moreno Valley Zoning Atlas



Current Zoning: HR & RA2
Proposed Zoning: R10

The information shown on this map was compiled from the Riverside County GIS and the City of Moreno Valley GIS. The user bears all liability for the use of this map for any purpose other than that for which it was prepared. The City of Moreno Valley and the City of Riverside Valley will not be held responsible for any claims, losses or damages resulting from the use of this map.

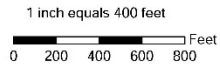

City of Moreno Valley Zoning Atlas



81

Current Zoning: CC
Proposed Zoning: BF



Current Zoning: R10
Proposed Zoning: R3

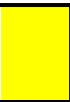

This information is provided for informational purposes only and does not constitute an offer of insurance. The City of Moreno Valley does not provide insurance. The City of Moreno Valley will not be held responsible for any claims, losses or damages resulting from the use of this map.

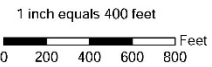
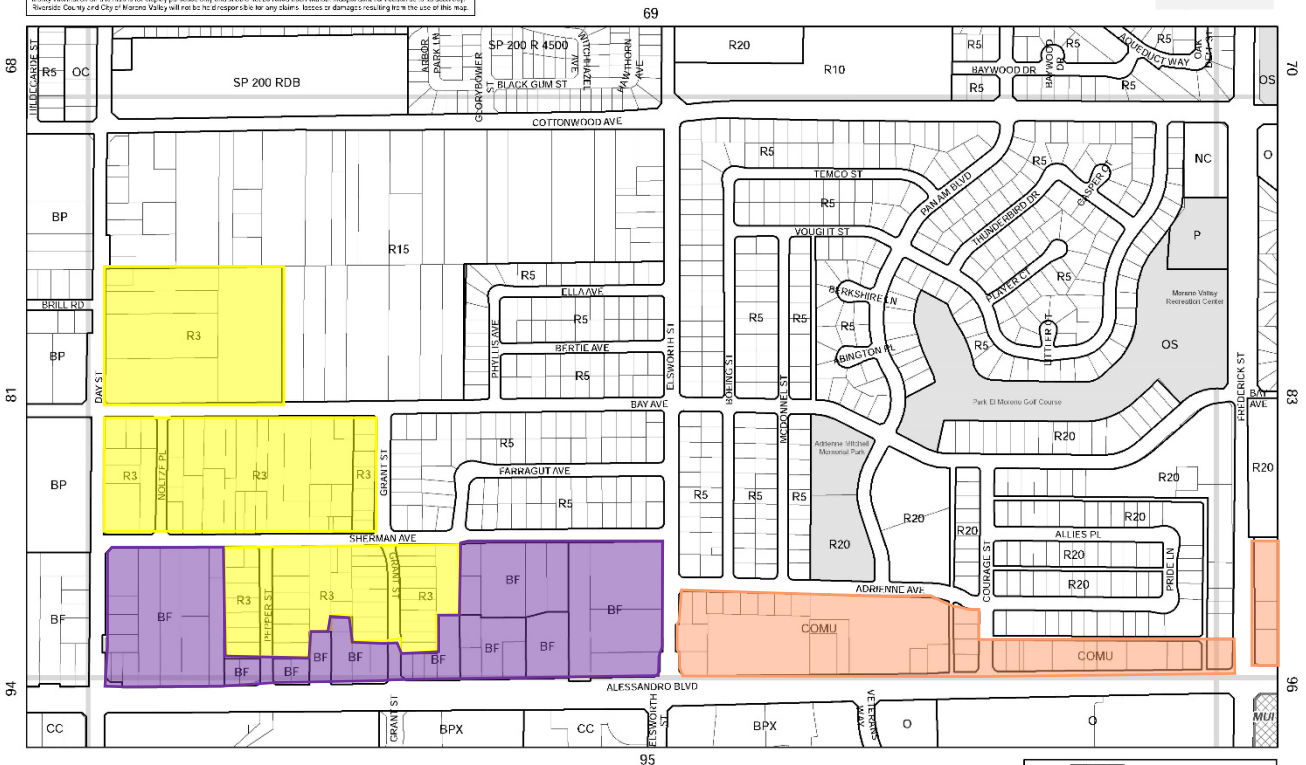

City of Moreno Valley Zoning Atlas



Current Zoning: CC, R30 & R10
Proposed Zoning: BF

Current Zoning: CC, R30 & NC
Proposed Zoning: COMU

Current Zoning: R10
Proposed Zoning: R3

The information shown on this map was compiled from the Alameda County GIS and the City of Moreno Valley GIS. The best known source of information on this map is for display purposes only and should not be relied upon without independent verification as to its accuracy. Riverside County and City of Moreno Valley will not be held responsible for any claims, losses or damages resulting from the use of this map.

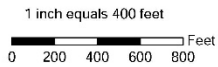
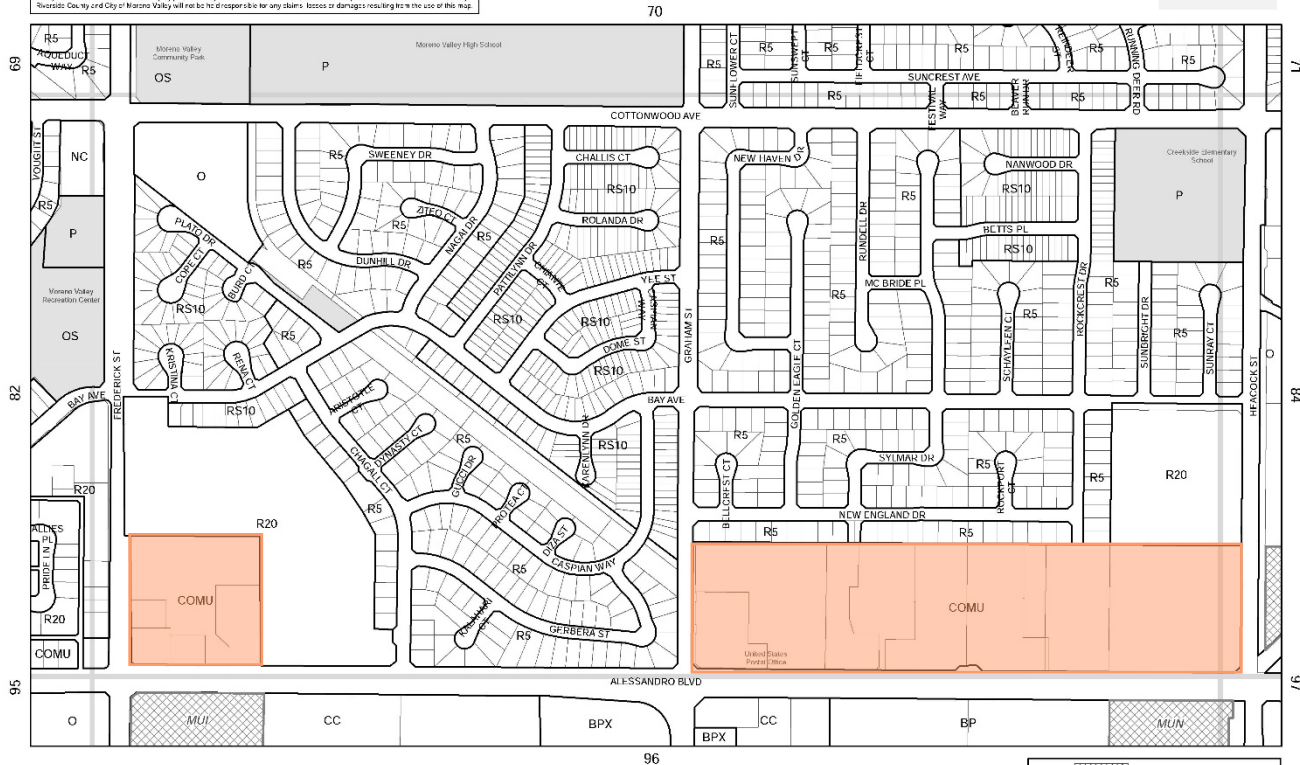

City of Moreno Valley Zoning Atlas



Current Zoning: NC
Proposed Zoning: COMU



All information shown on this map was compiled from the records of the City of Moreno Valley. The information is for informational purposes only and does not constitute an offer. Independent verification is recommended. The City of Moreno Valley and City of Moreno Valley will not be held responsible for any claims, losses or damages resulting from the use of this map.

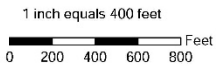
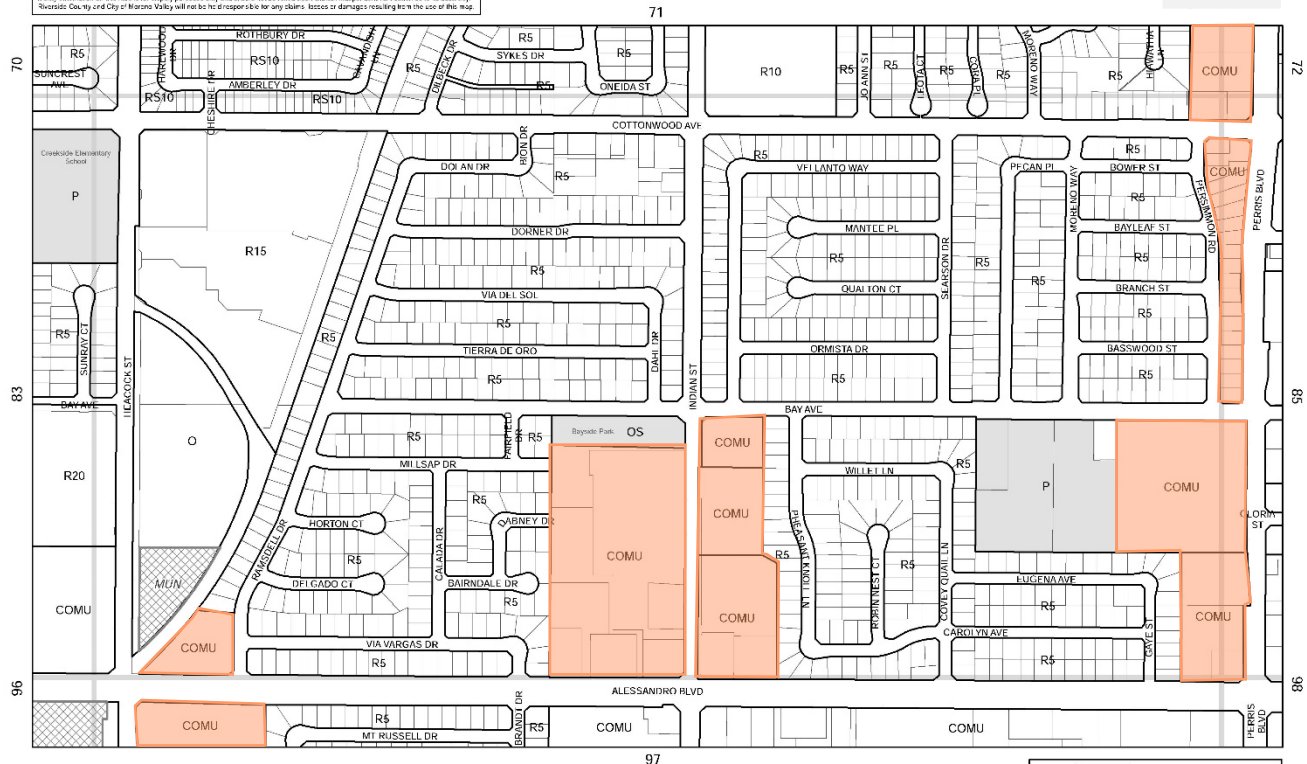

City of Moreno Valley Zoning Atlas

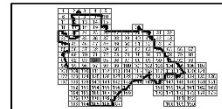

Current Zoning: NC, CC, R15 & R5
Proposed Zoning: COMU

The information shown on this map was compiled from the Riverside County GIS site, the City of Moreno Valley GIS. The intent here is to provide information on the map for design purposes only and does not constitute a contract. The City of Moreno Valley, Riverside County, and City of Moreno Valley will not be held responsible for any claims, losses or damages resulting from the use of this map.

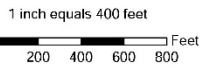
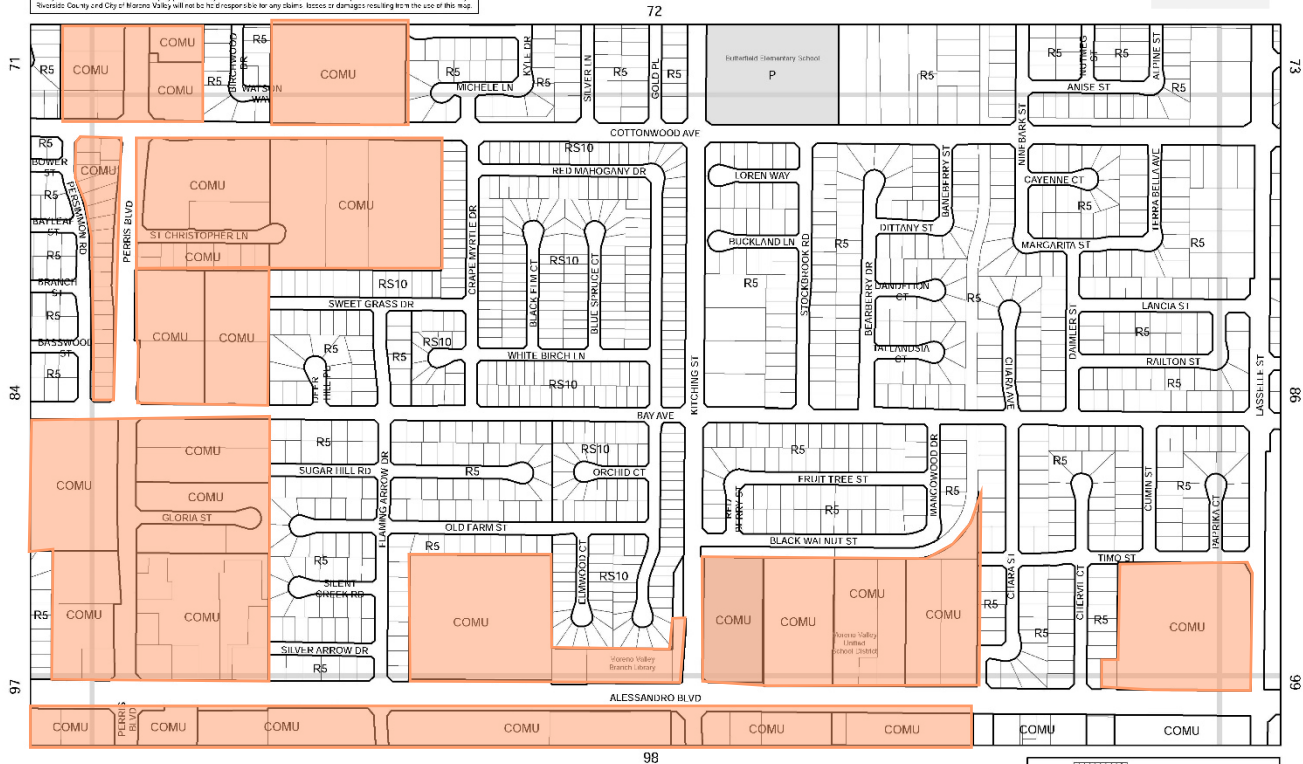

City of Moreno Valley Zoning Atlas



Current Zoning: R5, R10, R15, OC, O, CC & NC
Proposed Zoning: COMU

This information shown on this map was compiled by the Riverside County GIS and the City of Moreno Valley GIS. The information is for informational purposes only and does not constitute an offer of insurance. Riverside County and City of Moreno Valley will not be responsible for any claims, losses or damages resulting from the use of this map.

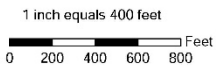

City of Moreno Valley Zoning Atlas



Current Zoning: NC
Proposed Zoning: COMU

Current Zoning: CC, OC, O, R30, R5 & P
Proposed Zoning: DC

The information shown on this map was compiled from the Riverside County GIS and the City of Moreno Valley GIS. The level of detail shown on this map is for informational purposes only and should not be relied upon for legal or financial decisions. The accuracy of Riverside County and City of Moreno Valley will not be responsible for any claims, losses or damages resulting from the use of this map.

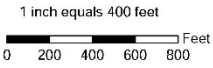

City of Moreno Valley Zoning Atlas

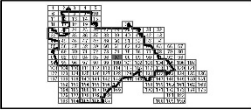

Current Zoning: CC, OC, O, R30, R5 & P
Proposed Zoning: DC

The information shown on this map was compiled from the Kern County GIS and the City of Moreno Valley GIS. The information is for informational purposes only and does not constitute an offer of independent financial or other services. Sources: City of Moreno Valley and Kern County. No liability will be accepted for any claims, losses or damages resulting from the use of this map.

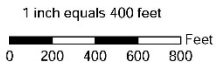
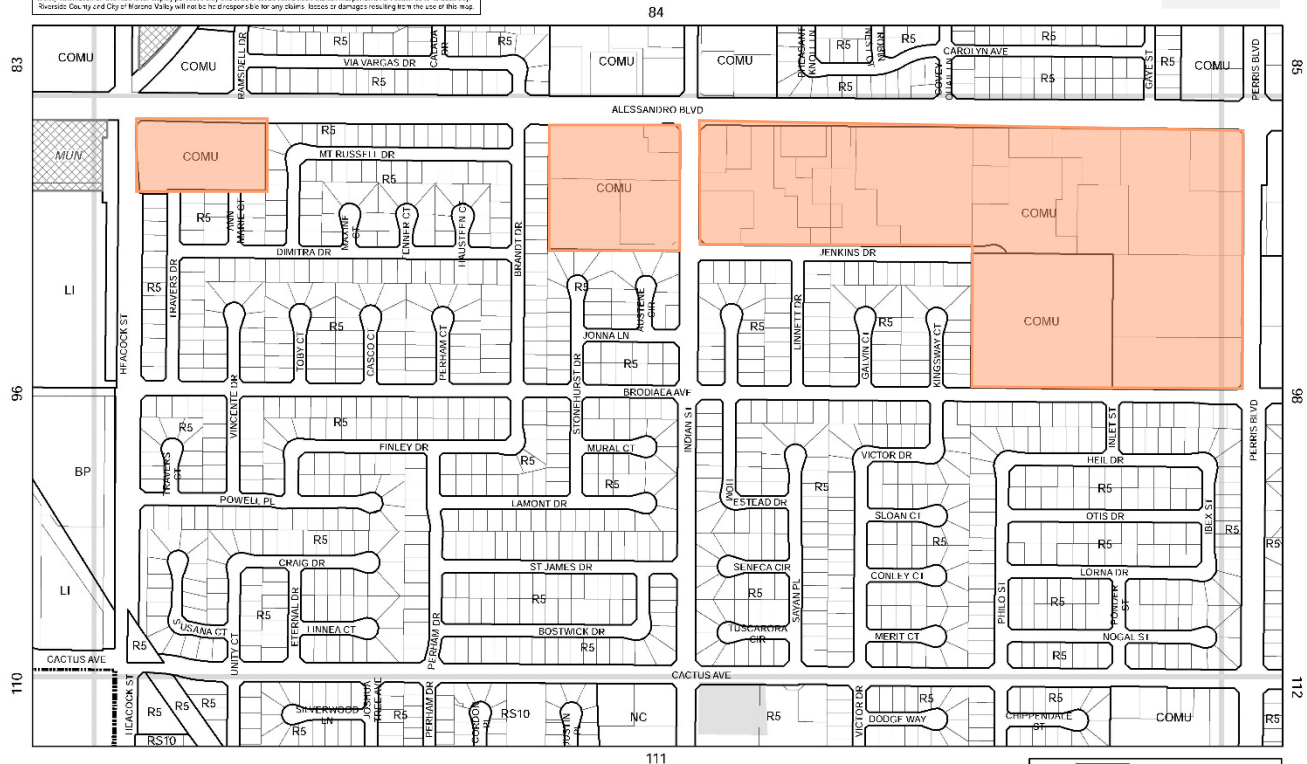

City of Moreno Valley Zoning Atlas

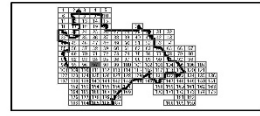

Current Zoning: NC, CC & R5
Proposed Zoning: COMU

The information shown on this map was compiled from the Riverside County GIS and the City of Moreno Valley GIS. The base and zoning information on this map is for display purposes only and should not be considered a final, no-warranty certificate as to its accuracy. Neither the City of Moreno Valley nor the staff responsible for this map, makes or warrants any liability for this use of this map.

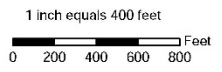
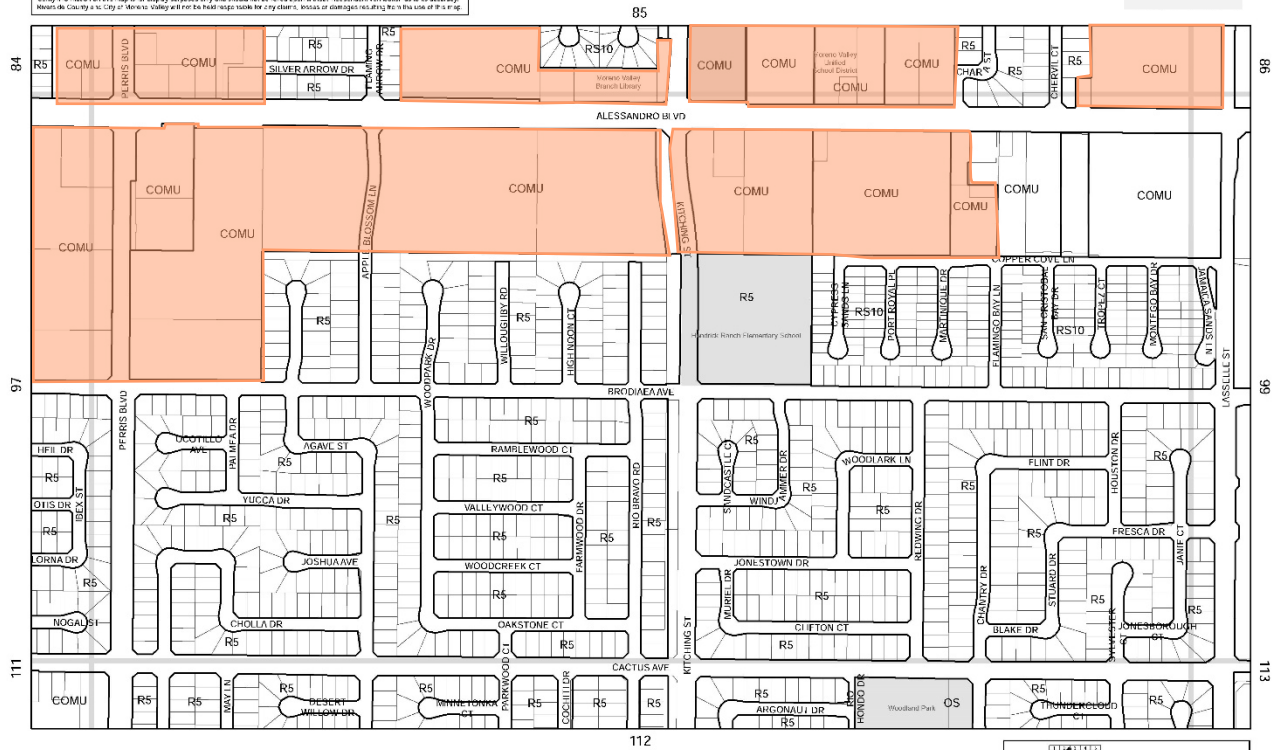

City of Moreno Valley Zoning Atlas

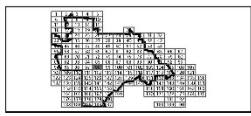

Current Zoning: NC, CC, OC, O, R10 & R15
Proposed Zoning: COMU

The information shown on this map was compiled from the Inland Empire Council of Governments (ICOG) and the City of Moreno Valley GIS. The best available data was used to create this map. The City of Moreno Valley is not responsible for any errors, omissions or damages resulting from the use of this map.

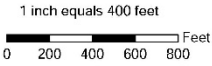
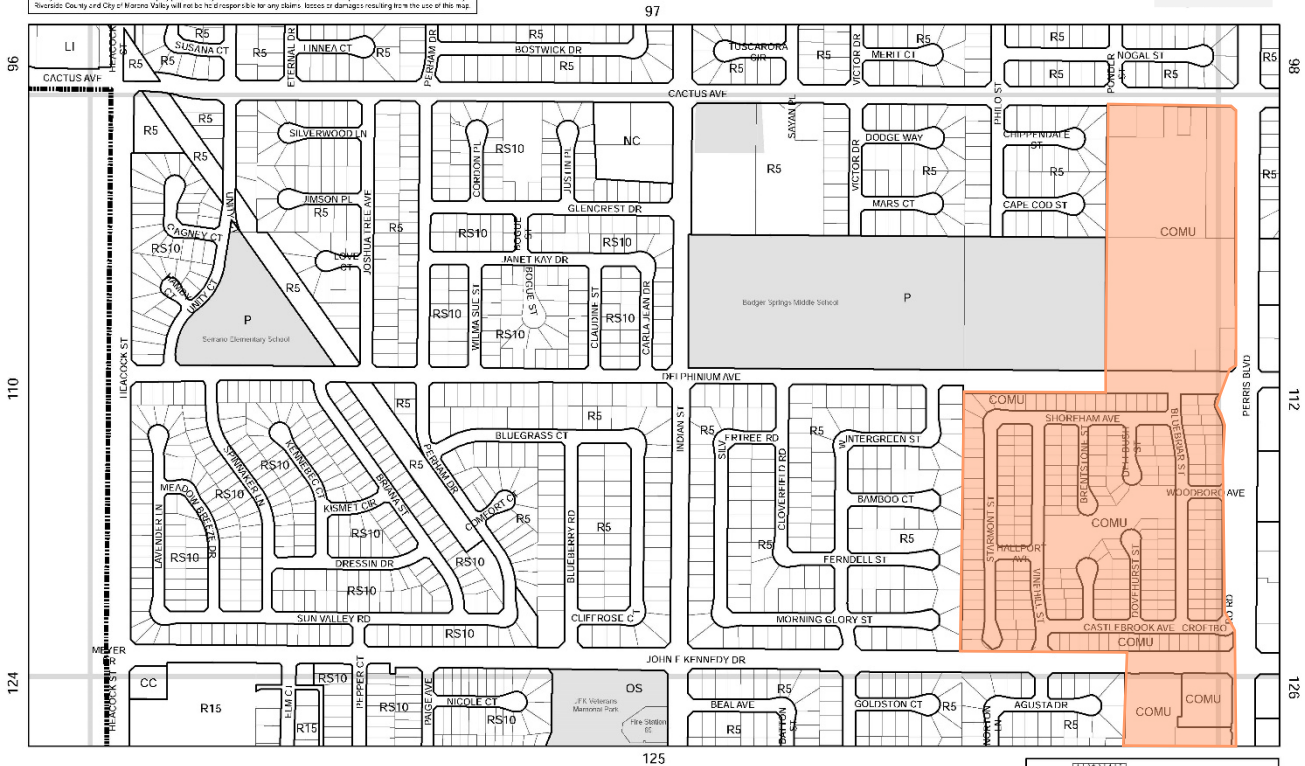

City of Moreno Valley Zoning Atlas



Current Zoning: NC, CC, R10 & RS10
Proposed Zoning: COMU

The information shown on this map was compiled from the Kern County GIS and the City of Moreno Valley GIS. The base data and liability information on this map is for city purposes only and should not be relied upon as being a total or complete representation of the information. Kern County is the City of Moreno Valley and not the Public Works Department. No warranty is made by the City of Moreno Valley for any damages resulting from the use of this map.

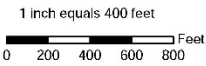
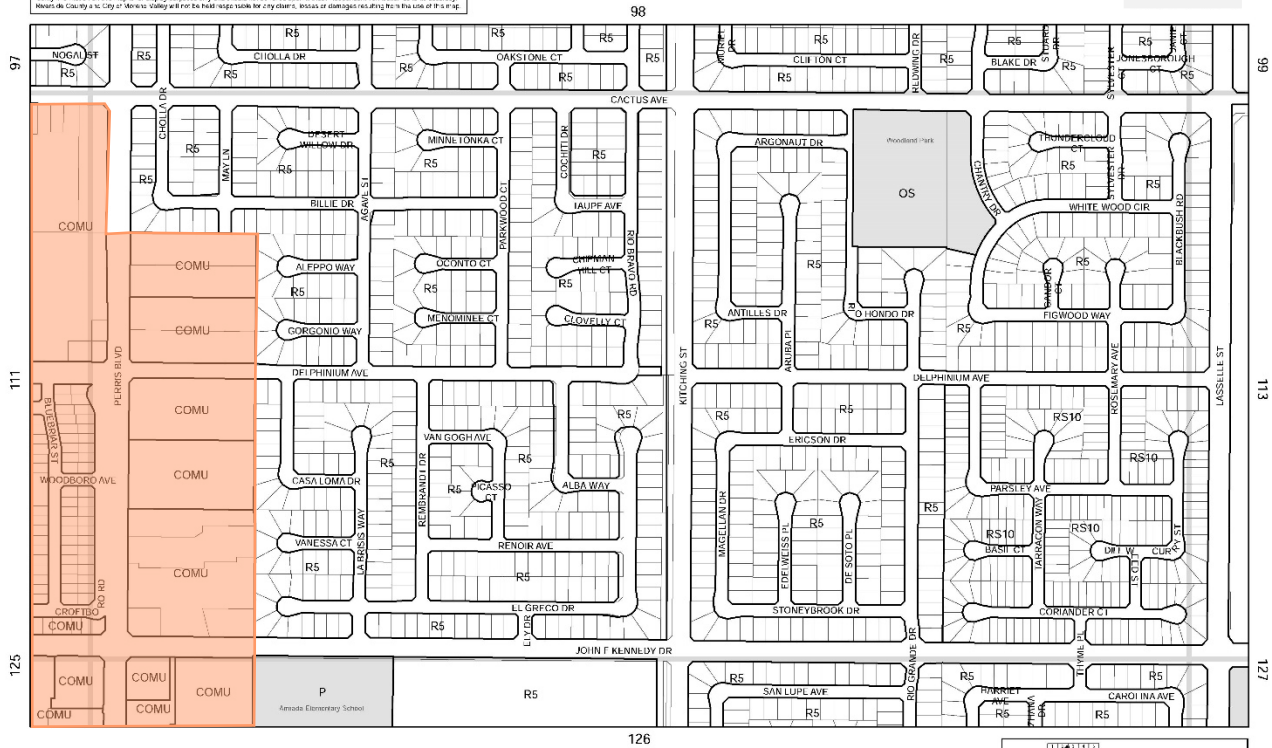

City of Moreno Valley Zoning Atlas

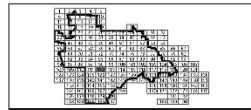

Current Zoning: NC, O, R20, R10 & RS10
Proposed Zoning: COMU

The information shown on this map was compiled from the Riverside County GIS and the City of Moreno Valley GIS. The data base and liability information on this map is the responsibility of the user and should not be used as a basis for any liability or damages resulting from the use of this map.



1 inch equals 400 feet
0 200 400 600 800 Feet

City of Moreno Valley Zoning Atlas

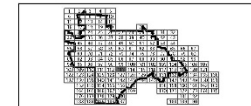

113

Current Zoning: CC
Proposed Zoning: DC

The information shown on this map was compiled from the Riverside County GIS data for the City of Moreno Valley. The City of Moreno Valley is not responsible for any errors or omissions. The City of Moreno Valley is not responsible for any claims, losses or damages resulting from the use of this map.

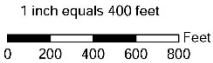
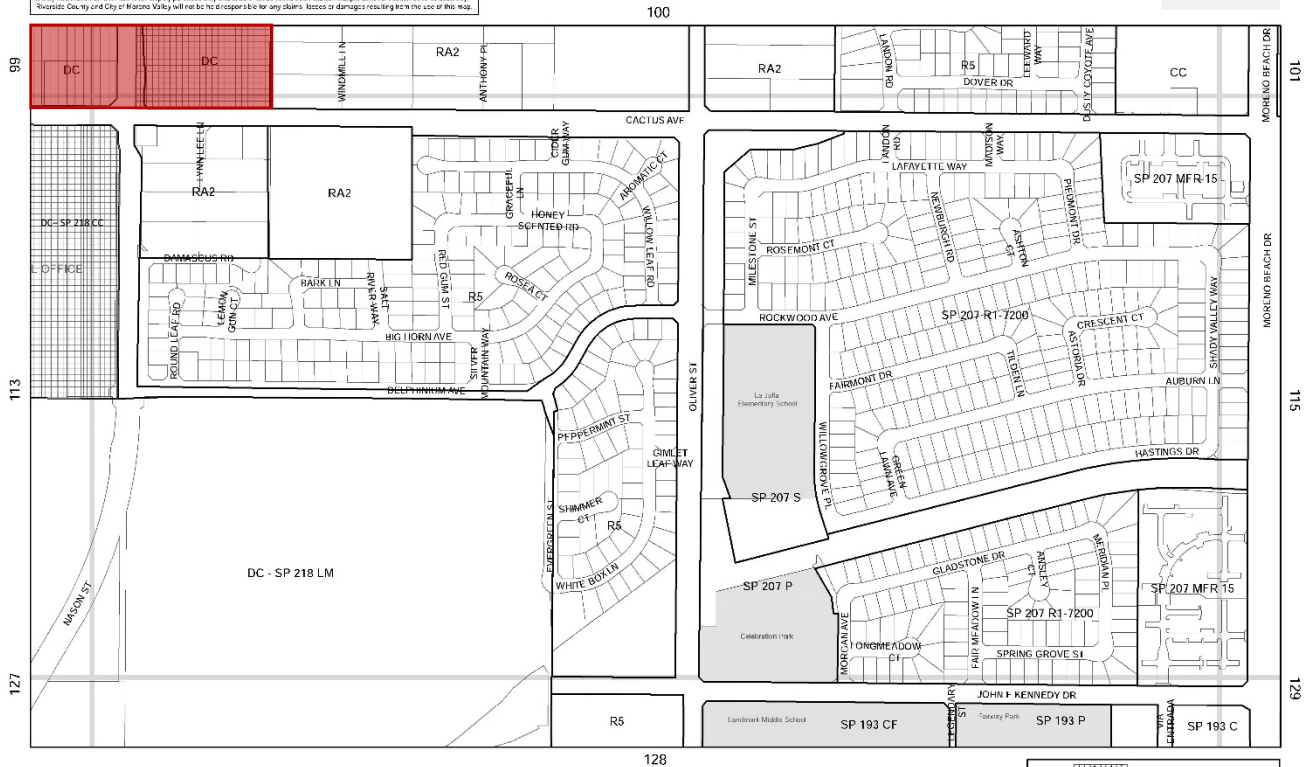

City of Moreno Valley Zoning Atlas

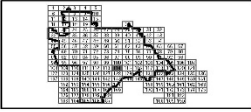

Current Zoning: CC & RA2
Proposed Zoning: DC

The information shown on this map was compiled by the Riverside County GIS and the City of Moreno Valley GIS. The board does not warrant the accuracy of the map for design purposes and shall not be held liable for any claims, losses or damages resulting from the use of this map.

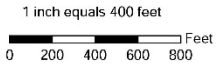
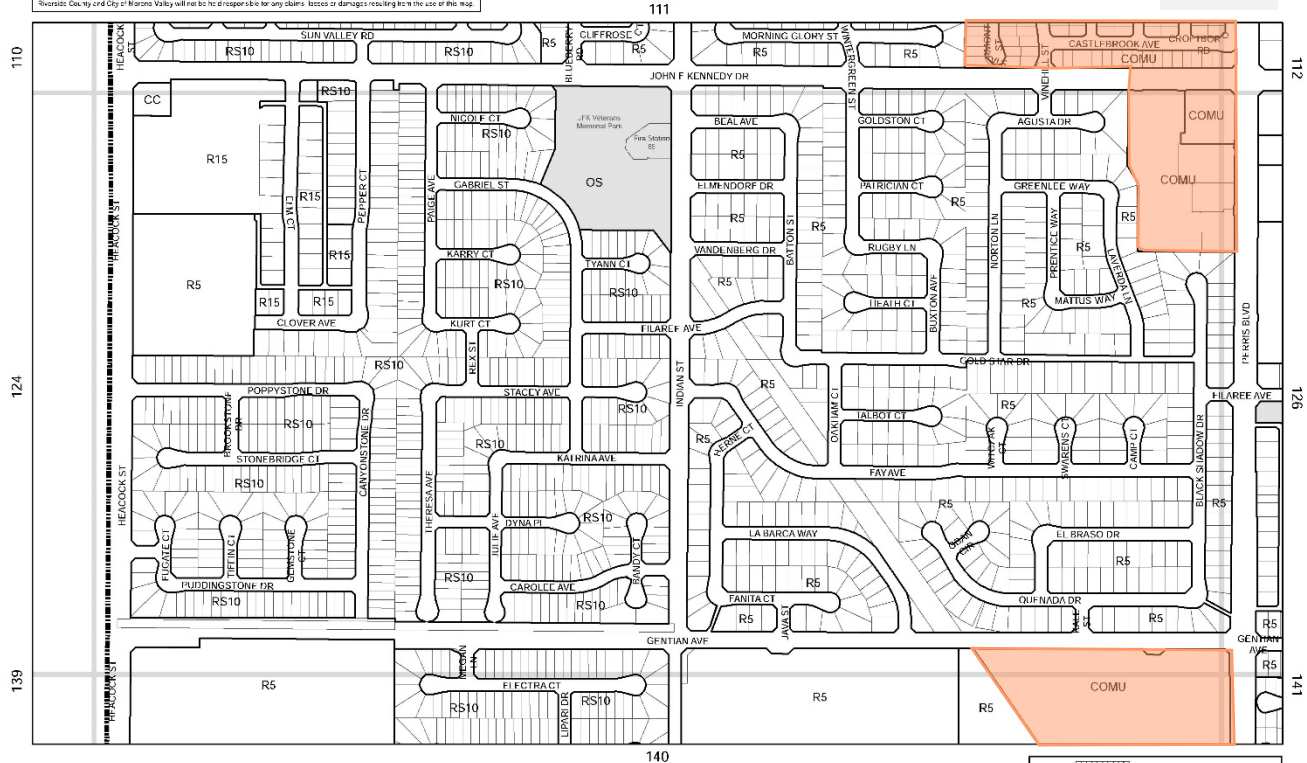

City of Moreno Valley Zoning Atlas

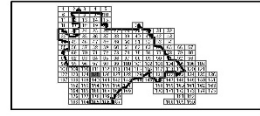

Current Zoning: NC, CC & RS10
Proposed Zoning: COMU

The information shown on this map was compiled from the Inland Empire County GIS and the City of Moreno Valley GIS. The boundaries of the City of Moreno Valley are shown in black. The information on this map is for informational purposes only and should not be relied upon for legal purposes. The City of Moreno Valley, Riverside County and City of Moreno Valley will not be responsible for any claims, losses or damages resulting from the use of this map.

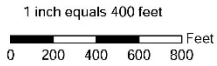
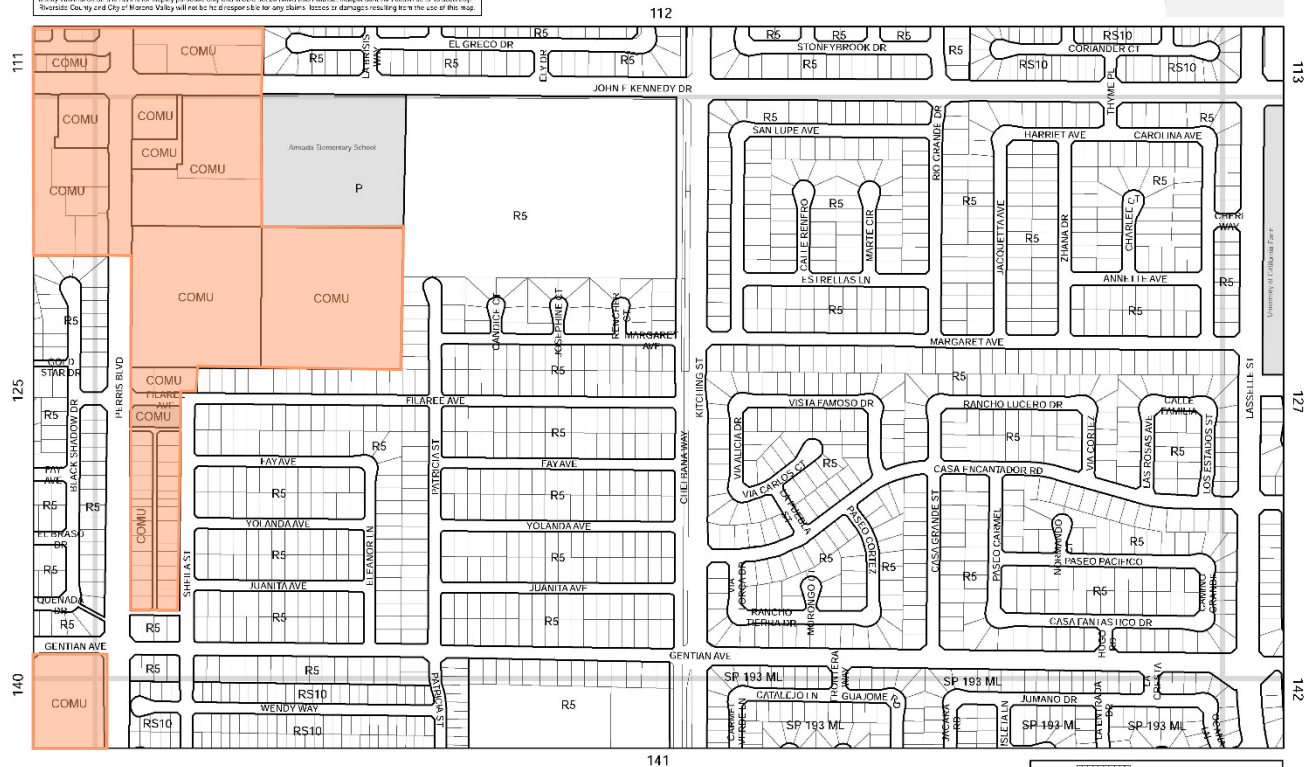

City of Moreno Valley Zoning Atlas



Current Zoning: NC, CC, R15 & R20
Proposed Zoning: COMU

The information shown on this map was compiled from the Riverside County GIS and the City of Moreno Valley GIS. The base and utility information on this map is for display purposes only and should not be used as a basis for boundary or coloration as to its accuracy. Riverside County and City of Moreno Valley will not be held liable for any errors, omissions or damages resulting from the use of this map.

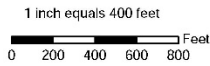
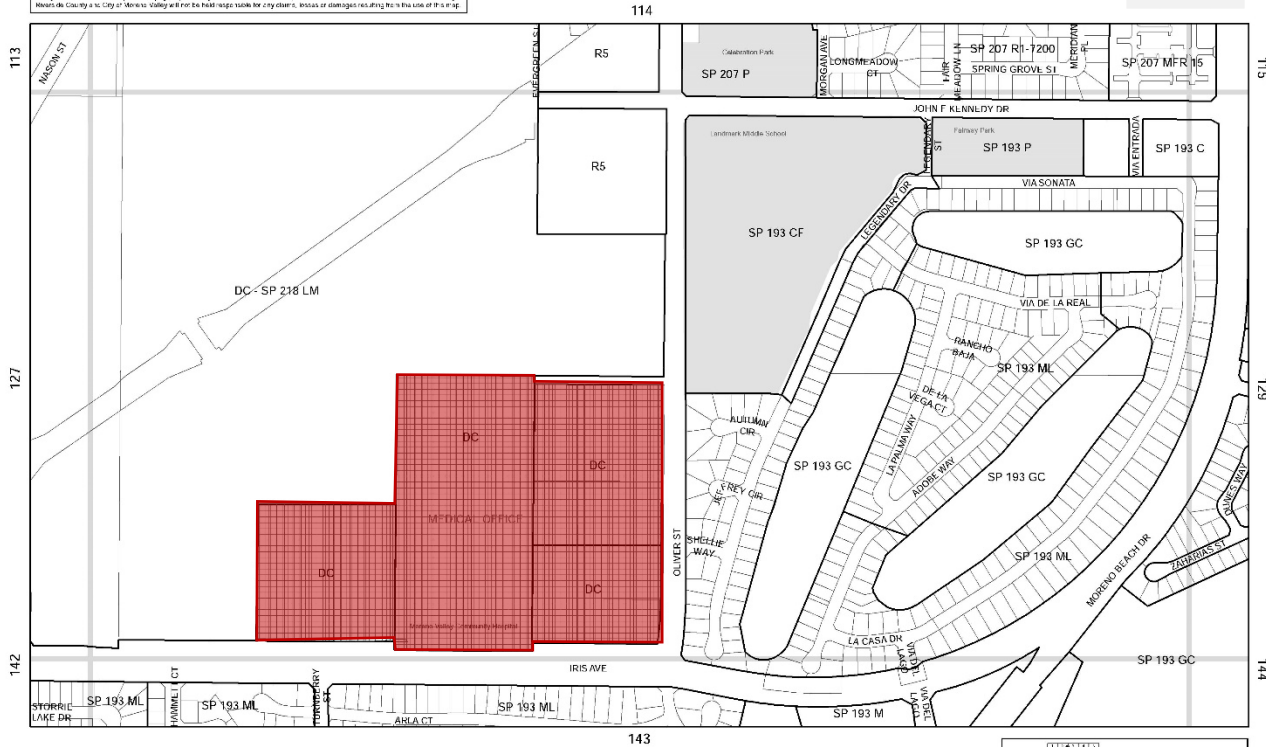

City of Moreno Valley Zoning Atlas

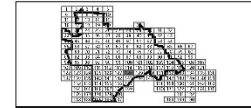

Current Zoning: CC, NC, OC & O
Proposed Zoning: DC

The information shown on this map was compiled by the Alameda County GIS and the City of Moreno Valley GIS. The information is for informational purposes only and should not be relied upon without independent verification. Riverside County and City of Moreno Valley will not be responsible for any claims, losses or damages resulting from the use of this map.

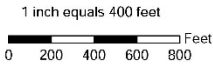
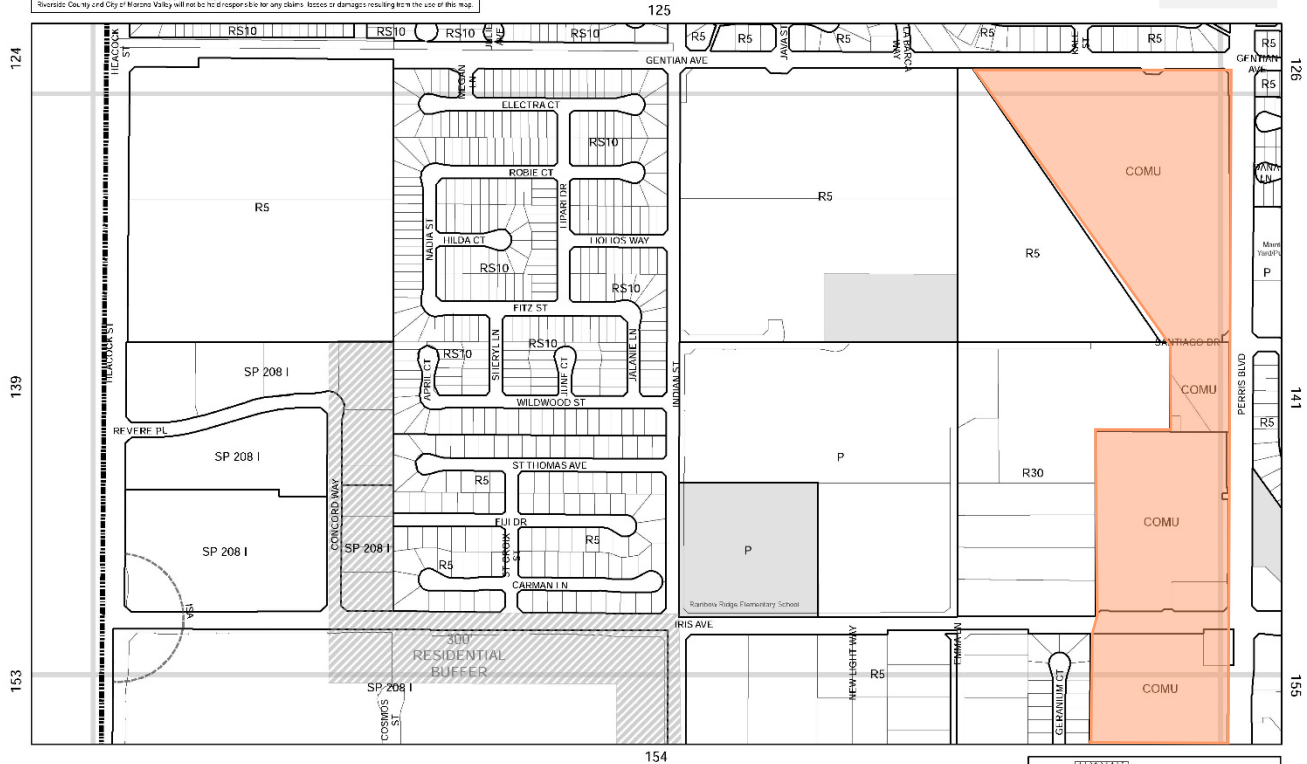

City of Moreno Valley Zoning Atlas

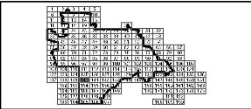

Current Zoning: NC & CC
Proposed Zoning: COMU

The information shown on this map was compiled from the Kern County GIS and the City of Moreno Valley GIS. The lot area and locality information on this map is for display purposes only and should not be used as a basis for any legal action. The borders of the color are for its accuracy. Kern County is the City of Moreno Valley and the Kern County GIS is the City of Moreno Valley. Areas of damage are along the boundary of the map.

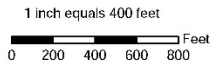

City of Moreno Valley Zoning Atlas

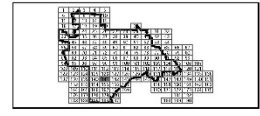

Current Zoning: NC & CC
Proposed Zoning: COMU

The information shown on this map was compiled from the Riverside County GIS and the City of Moreno Valley GIS. The line, area and color information on this map is for display purposes only and should not be used as a final record or indicator as to its accuracy. Moreno Valley and the City of Moreno Valley will not be held responsible for any errors, omissions or damages resulting from the use of this map.

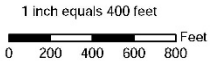

City of Moreno Valley Zoning Atlas

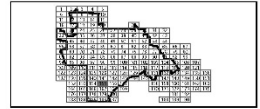

Current Zoning: NC & CC
Proposed Zoning: COMU

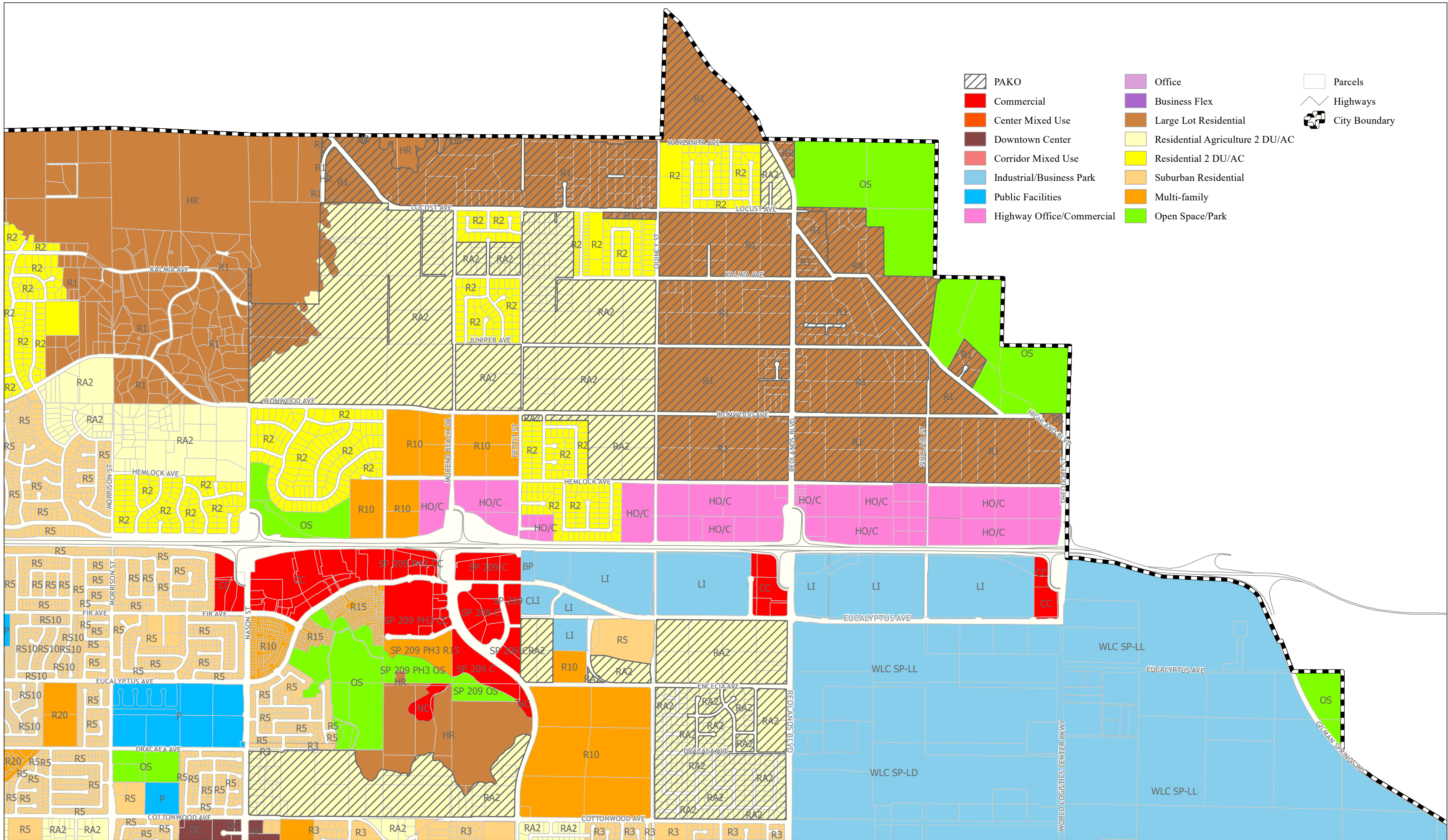

CITY OF MORENO VALLEY

PRIMARY ANIMAL KEEPING OVERLAY (PAKO)

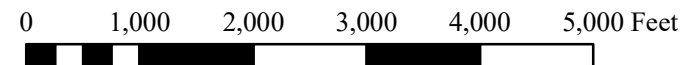

City of Moreno Valley Geographic Information in:
 State Plane NAD 83 California Zone 6 Feet
 Aerial Image Date: 2020
 G:\Divisions\Planning\2021\MXD\PakoSep2025.mxd
 September 15, 2025

The information shown on this map was compiled from the Riverside County GIS and the City of Moreno Valley GIS. The land base and facility information on this map is for display purposes only and should not be relied upon without independent verification as to its accuracy. Riverside County and City of Moreno Valley will not be held responsible for any claims, losses or damages resulting from the use of this map.



CITY OF MORENO VALLEY MIXED USE OVERLAY

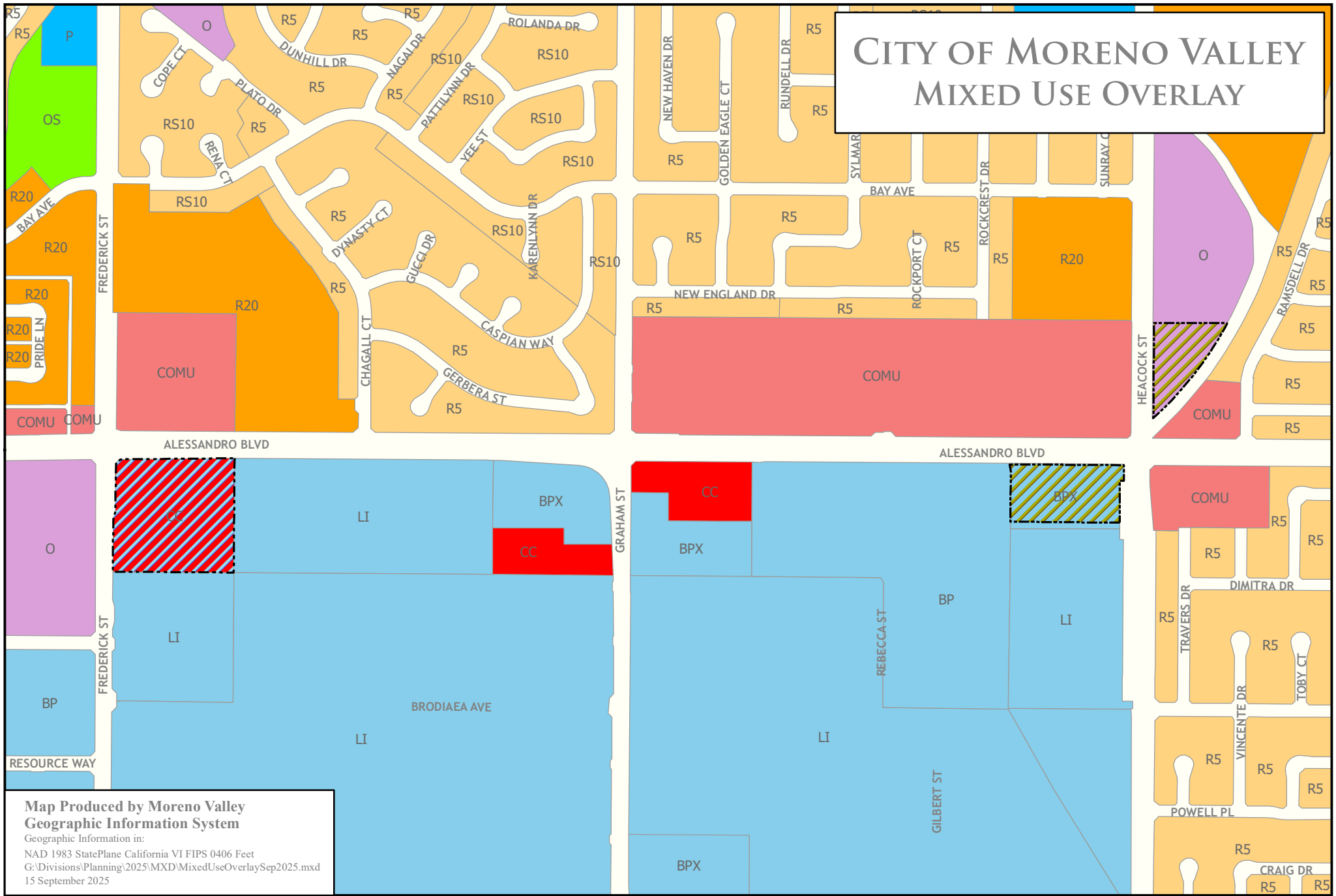

Map Produced by Moreno Valley Geographic Information System
 Geographic Information in:
 NAD 1983 StatePlane California VI FIPS 0406 Feet
 G:\Divisions\Planning\2025\MXD\MixedUseOverlaySep2025.mxd
 15 September 2025

The information shown on this map was compiled from the Riverside County GIS and the City of Moreno Valley GIS. The land base and facility information on this map is for display purposes only and should not be relied upon without independent verification as to its accuracy. Riverside County and City of Moreno Valley will not be held responsible for any claims, losses or damages resulting from the use of this map.

- | | | | | |
|------------------|--------------------------|---------------------------|---------------------------------|-----------------|
| MUI | Downtown Center | Highway Office/Commercial | Residential Agriculture 2 DU/AC | Open Space/Park |
| MUN | Corridor Mixed Use | Office | Residential 2 DU/AC | |
| Commercial | Industrial/Business Park | Business Flex | Suburban Residential | |
| Center Mixed Use | Public Facilities | Large Lot Residential | Multi-family | |