

RESOLUTION NO. 2026-____

A RESOLUTION OF THE CITY COUNCIL OF THE CITY OF MORENO VALLEY, CALIFORNIA, ORDERING THE ANNEXATION OF TERRITORY TO CITY OF MORENO VALLEY COMMUNITY FACILITIES DISTRICT NO. 2014-01 (MAINTENANCE SERVICES) AND APPROVING THE AMENDED MAP FOR SAID DISTRICT

WHEREAS, by its Resolution No. 2014-25, the City Council established the City of Moreno Valley Community Facilities District No. 2014-01 (Maintenance Services) (the “CFD”), a citywide district, pursuant to the Mello-Roos Community Facilities Act of 1982 (Government Code Section 53311 *et seq.*) (the “Act”); and

WHEREAS, by its Ordinance No. 874, the City Council authorized an annual special tax to be levied against all non-exempt parcels of real property within the CFD (the “Special Tax”) to fund street lighting services and landscape maintenance services; and

WHEREAS, by its Ordinance No. 980, the City Council authorized an annual special tax to be levied against all non-exempt parcels of real property within the CFD to fund Drainage and Street Maintenance Services; and

WHEREAS, in order to permit landowners to efficiently annex developing parcels to the CFD, the City Council, by its Ordinance No. 980 designated the entire territory of the City as a future annexation area for the CFD and approved the third amended and restated rate and method of apportionment for the Special Tax; and

WHEREAS, the landowner of the parcels listed on Exhibit A to this Resolution, which is attached hereto and incorporated herein by reference, has submitted to the City a petition requesting and approving annexation of the listed parcels (the “Annexation Parcels”) to the CFD; and

WHEREAS, the Annexation Parcels are comprised of the territory shown on the boundary map (the “Boundary Map”) “Amendment Nos. 94 and 95 to Boundaries of City of Moreno Valley Community Facilities District No. 2014-01 (Maintenance Services), City of Moreno Valley, County of Riverside, State of California” which is included as Exhibit B to this Resolution, and incorporated herein by this reference; and

WHEREAS, the City Council desires to annex the Annexation Parcels to the CFD.

NOW, THEREFORE, THE CITY COUNCIL OF THE CITY OF MORENO VALLEY, CALIFORNIA, DOES HEREBY RESOLVE AS FOLLOWS:

1. Recitals. The above recitals are all true and correct and are herein incorporated.
2. Annexation Approved. The Annexation Parcels are hereby added to and part of the CFD with full legal effect. The Annexation Parcels are subject to the Special Tax associated with the Tax Rate Areas indicated on Exhibit A to this Resolution.

3. Description of Services. The following is a general description of all services (the “Services”) provided in the CFD:

A. Landscape Maintenance Services: Maintaining, servicing, and operating landscape improvements and associated appurtenances located within the public right-of-way and within dedicated landscape easements for the CFD. These improvements may include but are not limited to parkways, medians, open space landscaping, fencing, monuments, ornamental lighting, drainage, turf, ground cover, shrubs, vines and trees, irrigation systems, and appurtenant facilities and structures. Fundable costs may include, but are not limited to: (i) contracting costs for landscape maintenance services, including litter removal, (ii) salaries and benefits of City staff, (iii) expenses related to equipment, apparatus, and supplies related to these services, (iv) City administrative and overhead costs associated with providing such services within the CFD, and (v) lifecycle costs associated with the repair and replacement of facilities.

B. Street Lighting Services: Maintaining, servicing, and operating street lights and appurtenant improvements. Fundable costs may include, but are not limited to: (i) contracting costs for street light maintenance, (ii) salaries and benefits of City staff, if the City directly provides street light maintenance services, (iii) utility expenses and the expense related to equipment, apparatus, and supplies related to these services and authorized by the Act, (iv) City administrative and overhead costs associated with providing such services for the CFD, and (v) lifecycle costs associated with the repair and replacement of facilities.

C. Drainage and Street Maintenance Services: Maintaining, servicing, and operating drainage improvements and maintaining streets. Drainage improvements include public improvements and appurtenance (and associated easements) that are designed or used to capture, retain, detain, remove, transport, or treat surface water and storm water runoff. Fundable costs may include, but are not limited to: (i) contracting costs for street and drainage maintenance services, including litter removal, (ii) salaries and benefits of City staff if the City directly provides these services, (iii) expenses related to equipment, apparatus, and supplies related to these services, (iv) City administrative and overhead costs associated with providing such services within the CFD, and (v) lifecycle costs associated with the repair and replacement of streets and drainage improvements.

The Annexation Parcels will only be provided with the services indicated on Exhibit A.

4. Amended Boundary Map. The Boundary Map attached hereto as Exhibit B is hereby approved. This map amends, and does not supersede, the existing maps of the CFD. The City Council directs that said map be filed with the Riverside County Recorder pursuant to Section 3113 of the Streets and Highways Code.

5. Notice of Special Tax Lien. The City Council directs that an amended notice of

special tax lien be recorded pursuant to Section 3117.5 of the Streets and Highways Code with respect to the Annexation Parcels associated with the Boundary Map.

6. This Resolution shall be effective immediately upon adoption.

7. The City Clerk shall certify to the adoption of this Resolution, and shall maintain on file as a public record this Resolution.

8. Severability. That the City Council declares that, should any provision, section, paragraph, sentence or word of this Resolution be rendered or declared invalid by any final court action in a court of competent jurisdiction or by reason of any preemptive legislation, the remaining provisions, sections, paragraphs, sentences or words of this Resolution as hereby adopted shall remain in full force and effect.

9. Repeal of Conflicting Provisions. That all the provisions heretofore adopted by the City Council that are in conflict with the provisions of this Resolution are hereby repealed.

APPROVED AND ADOPTED this 21st day of April 2026.

Mayor of the City of Moreno Valley

ATTEST:

City Clerk

APPROVED AS TO FORM:

City Attorney

RESOLUTION JURAT

STATE OF CALIFORNIA)
COUNTY OF RIVERSIDE) ss.
CITY OF MORENO VALLEY)

I, M. Patricia Rodriguez, City Clerk of the City of Moreno Valley, California, do hereby certify that Resolution No. 2026-___ was duly and regularly adopted by the City Council of the City of Moreno Valley at a regular meeting thereof held on the 21st day of April 2026 by the following vote:

AYES:

NOES:

ABSENT:

ABSTAIN:

(Council Members, Mayor Pro Tem and Mayor)

CITY CLERK

(SEAL)

EXHIBIT A

List of Annexation Parcel(s)			
Boundary Map Amendment No.	Assessor's Parcel Numbers	Services	Tax Rate Area & Maintenance Category
Amendment No. 94	487-260-002 487-280-003 487-280-004 487-280-005	Street Lighting	SL-01A
		Landscape Maintenance	TBD
		Street Maintenance and Drainage	SD-01
<p>Based on current development plans, it is anticipated that the Annexation Group will be in the Maintenance Category listed above; however all taxes will be calculated as set forth in the Rate and Method of Apportionment.</p> <p>The parcels associated with a given development constitute a separate Annexation Group for purpose of calculating the applicable Maintenance Category (where applicable) for each Tax Rate Area. The anticipated Maintenance Category (where applicable) is shown in parenthesis following the Tax Rate Area. All capitalized terms in this paragraph have the meanings set forth in the Rate and Method of Apportionment.</p>			

List of Annexation Parcel(s)			
Boundary Map Amendment No.	Assessor's Parcel Numbers	Services	Tax Rate Area & Maintenance Category
Amendment No. 95	256-200-002 256-200-003 256-200-004	Street Lighting	SL-02
<p>Based on current development plans, it is anticipated that the Annexation Group will be in the Maintenance Category listed above; however all taxes will be calculated as set forth in the Rate and Method of Apportionment.</p> <p>The parcels associated with a given development constitute a separate Annexation Group for purpose of calculating the applicable Maintenance Category (where applicable) for each Tax Rate Area. The anticipated Maintenance Category (where applicable) is shown in parenthesis following the Tax Rate Area. All capitalized terms in this paragraph have the meanings set forth in the Rate and Method of Apportionment.</p>			

EXHIBIT B

Boundary Map Amendment

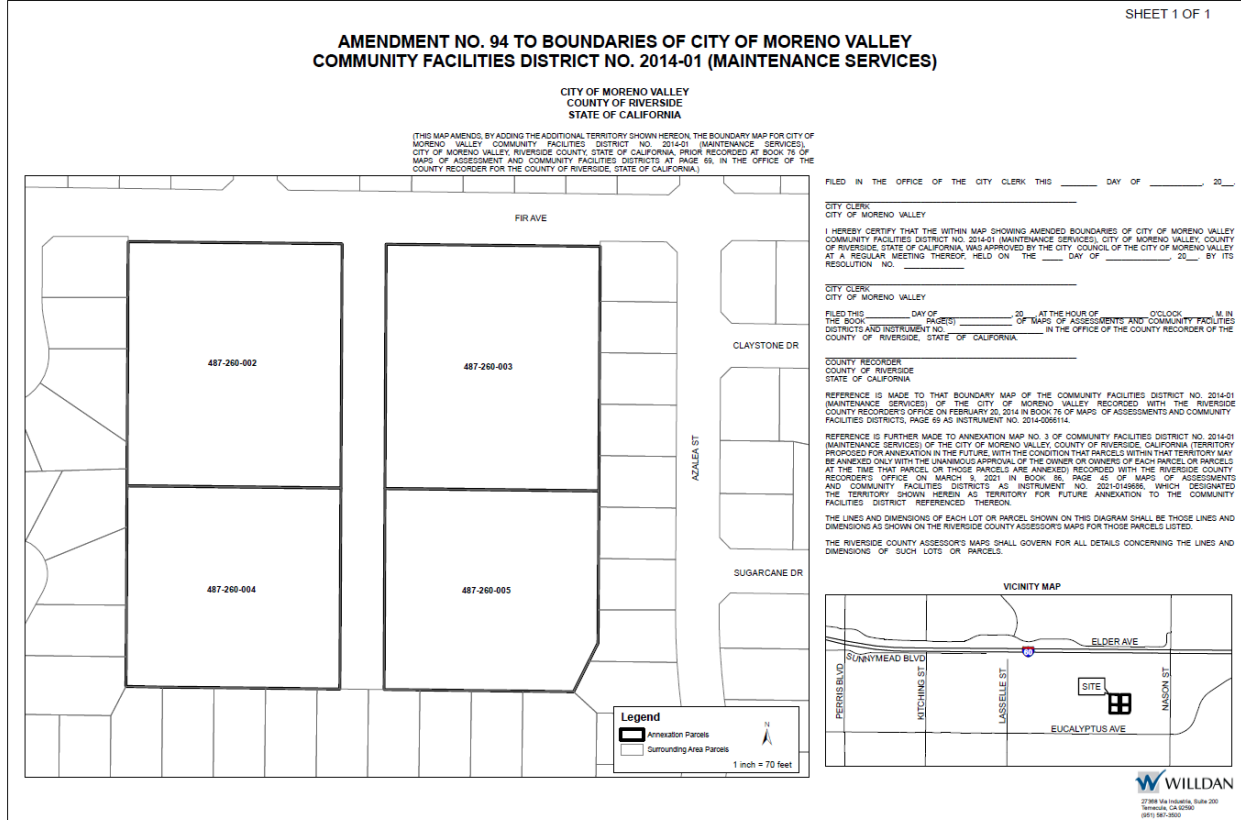

**AMENDMENT NO. 95 TO BOUNDARIES OF CITY OF MORENO VALLEY
COMMUNITY FACILITIES DISTRICT NO. 2014-01 (MAINTENANCE SERVICES)**

CITY OF MORENO VALLEY
COUNTY OF RIVERSIDE
STATE OF CALIFORNIA

(THIS MAP AMENDS, BY ADDING THE ADDITIONAL TERRITORY SHOWN HEREON, THE BOUNDARY MAP FOR CITY OF MORENO VALLEY COMMUNITY FACILITIES DISTRICT NO. 2014-01 (MAINTENANCE SERVICES), CITY OF MORENO VALLEY, RIVERSIDE COUNTY, STATE OF CALIFORNIA, PRIOR RECORDED AT BOOK 76 OF MAPS OF ASSESSMENT AND COMMUNITY FACILITIES DISTRICTS AT PAGE 69, IN THE OFFICE OF THE COUNTY RECORDER FOR THE COUNTY OF RIVERSIDE, STATE OF CALIFORNIA.)

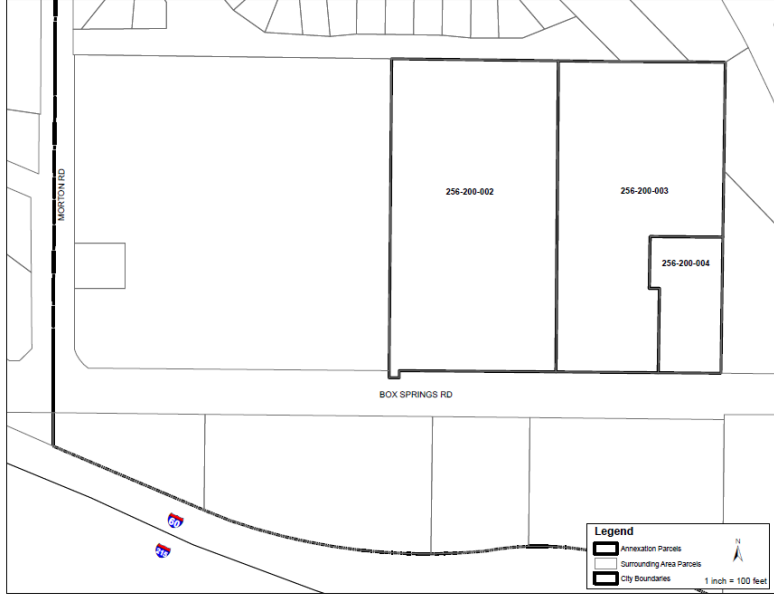

FILED IN THE OFFICE OF THE CITY CLERK THIS _____ DAY OF _____, 20__.

CITY CLERK
CITY OF MORENO VALLEY

I HEREBY CERTIFY THAT THE WITHIN MAP SHOWING AMENDED BOUNDARIES OF CITY OF MORENO VALLEY COMMUNITY FACILITIES DISTRICT NO. 2014-01 (MAINTENANCE SERVICES), CITY OF MORENO VALLEY, COUNTY OF RIVERSIDE, STATE OF CALIFORNIA, WAS APPROVED BY THE CITY COUNCIL OF THE CITY OF MORENO VALLEY AT A REGULAR MEETING THEREOF HELD ON THE _____ DAY OF _____, 20__ BY ITS RESOLUTION NO. _____.

CITY CLERK
CITY OF MORENO VALLEY

FILED THIS _____ DAY OF _____, 20__ AT THE HOUR OF _____ O'CLOCK _____ M IN THE BOOK _____ (PAGES) _____ OF MAPS OF ASSESSMENTS AND COMMUNITY FACILITIES DISTRICTS AND INSTRUMENT NO. _____ IN THE OFFICE OF THE COUNTY RECORDER OF THE COUNTY OF RIVERSIDE, STATE OF CALIFORNIA.

COUNTY RECORDER
COUNTY OF RIVERSIDE
STATE OF CALIFORNIA

REFERENCE IS MADE TO THAT BOUNDARY MAP OF THE COMMUNITY FACILITIES DISTRICT NO. 2014-01 (MAINTENANCE SERVICES) OF THE CITY OF MORENO VALLEY, COUNTY OF RIVERSIDE, CALIFORNIA (TERRITORY PROPOSED FOR ANNEXATION IN THE FUTURE WITH THE CONDITION THAT PARCELS WITHIN THAT TERRITORY MAY BE ANNEXED ONLY WITH THE UNANIMOUS APPROVAL OF THE OWNER OR OWNERS OF EACH PARCEL OR PARCELS AT THE TIME THAT PARCEL OR THOSE PARCELS ARE ANNEXED) RECORDED WITH THE RIVERSIDE COUNTY RECORDER'S OFFICE ON FEBRUARY 20, 2014 IN BOOK 76 OF MAPS OF ASSESSMENTS AND COMMUNITY FACILITIES DISTRICTS, PAGE 69 AND INSTRUMENT NO. 2014-056614.

REFERENCE IS FURTHER MADE TO ANNEXATION MAP NO. 3 OF COMMUNITY FACILITIES DISTRICT NO. 2014-01 (MAINTENANCE SERVICES) OF THE CITY OF MORENO VALLEY, COUNTY OF RIVERSIDE, CALIFORNIA (TERRITORY PROPOSED FOR ANNEXATION IN THE FUTURE WITH THE CONDITION THAT PARCELS WITHIN THAT TERRITORY MAY BE ANNEXED ONLY WITH THE UNANIMOUS APPROVAL OF THE OWNER OR OWNERS OF EACH PARCEL OR PARCELS AT THE TIME THAT PARCEL OR THOSE PARCELS ARE ANNEXED) RECORDED WITH THE RIVERSIDE COUNTY RECORDER'S OFFICE ON MARCH 9, 2021 IN BOOK 86, PAGE 45 OF MAPS OF ASSESSMENTS AND COMMUNITY FACILITIES DISTRICTS AS INSTRUMENT NO. 2021-018608, WHICH DESIGNATED THE TERRITORY SHOWN HEREON AS TERRITORY FOR FUTURE ANNEXATION TO THE COMMUNITY FACILITIES DISTRICT REFERENCED THEREON.

THE LINES AND DIMENSIONS OF EACH LOT OR PARCEL SHOWN ON THIS DIAGRAM SHALL BE THOSE LINES AND DIMENSIONS AS SHOWN ON THE RIVERSIDE COUNTY ASSESSOR'S MAPS FOR THOSE PARCELS LISTED.

THE RIVERSIDE COUNTY ASSESSOR'S MAPS SHALL GOVERN FOR ALL DETAILS CONCERNING THE LINES AND DIMENSIONS OF SUCH LOTS OR PARCELS.

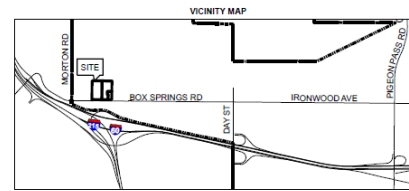

WILLDAN
2788 Via Industrial, Suite 200
Torrance, CA 90503
(310) 961-9900