

RESOLUTION NO. 2026-____

A RESOLUTION OF THE CITY COUNCIL OF THE CITY OF MORENO VALLEY, CALIFORNIA, ORDERING THE ANNEXATION OF TERRITORY TO CITY OF MORENO VALLEY COMMUNITY FACILITIES DISTRICT NO. 2023-01 (PUBLIC SAFETY SERVICES) AND APPROVING AMENDED MAPS FOR SAID DISTRICT

WHEREAS, by its Resolution No. 2023-82, the City Council established the City of Moreno Valley Community Facilities District No. 2023-01 (Public Safety Services) (the “CFD”), a citywide district, pursuant to the Mello-Roos Community Facilities Act of 1982 (Government Code Section 53311 *et seq.*) (the “Act”); and

WHEREAS, by its Ordinance No. 1004, the City Council authorized an annual special tax to be levied against all non-exempt parcels of real property within the CFD (the “Special Tax”) to fund public safety services; and

WHEREAS, in order to permit landowners to efficiently annex developing parcels to the CFD, the City Council, by its Ordinance No. 1007 designated the entire territory of the City as a future annexation area for the CFD and approved the rate and method of apportionment for the Special Tax; and

WHEREAS, the landowners of the parcels listed in Exhibit A to this Resolution, which is attached hereto and incorporated herein by reference, has submitted to the City a petition requesting and approving annexation to the CFD of said parcels; and

WHEREAS, territory proposed for annexation to the CFD Parcels are shown on the boundary maps titled “Amendment Nos. 124, 127, 128, and 133-140 to Boundaries of City of Moreno Valley Community Facilities District No. 2023-01 (Public Safety Services), City of Moreno Valley, County of Riverside, State of California” (the “Boundary Maps”), which are attached hereto as Exhibit B, and incorporated herein by this reference; and

WHEREAS, the City Council desires to annex the territory shown on the Boundary Maps (the Annexation Parcels) to the CFD.

NOW, THEREFORE, THE CITY COUNCIL OF THE CITY OF MORENO VALLEY, CALIFORNIA, DOES HEREBY RESOLVE AS FOLLOWS:

1. Recitals. The above recitals are all true and correct and are herein incorporated.
2. Annexations Approved. The Annexation Parcels are hereby added to and made part of the CFD with full legal effect. The Annexation Parcels are subject to the Special Tax as indicated on Exhibit A to this Resolution.
3. Description of Services. The following is a general description of all services (the “Services”) provided in the CFD:

Police protection services; fire protection and suppression services; and paramedic services, to the extent such services are in addition to services already provided at the time CFD No. 2023-01 is created and do not supplant existing services.

Fundable costs include, but are not limited to: (i) direct costs for such services, (ii) salaries and benefits of staff providing such services, (iii) expenses related to equipment, apparatus, and supplies related to these services, (iv) administrative and overhead costs, including staff time, associated with providing such services, and (v) lifecycle costs associated with the repair and replacement of facilities and improvements used to provide such services. Fundable costs also include the incidental expenses of the administration of CFD No. 2023-01.

4. Amended Boundary Maps. The Boundary Maps are hereby approved. These maps amend, and does not supersede, the existing maps of the CFD. The City Council directs that said maps be filed with the Riverside County Recorder pursuant to Section 3113 of the Streets and Highways Code.

5. Notices of Special Tax Lien. The City Council directs that amended notices of special tax lien be recorded pursuant to Section 3117.5 of the Streets and Highways Code with respect to the Annexation Parcels associated with the Boundary Maps.

6. This Resolution shall be effective immediately upon adoption.

7. The City Clerk shall certify the adoption of this Resolution and shall maintain on file as a public record this Resolution.

8. Severability. That the City Council declares that, should any provision, section, paragraph, sentence or word of this Resolution be rendered or declared invalid by any final court action in a court of competent jurisdiction or by reason of any preemptive legislation, the remaining provisions, sections, paragraphs, sentences or words of this Resolution as hereby adopted shall remain in full force and effect.

9. Repeal of Conflicting Provisions. That all the provisions heretofore adopted by the City Council that are in conflict with the provisions of this Resolution are hereby repealed.

APPROVED AND ADOPTED this 20th day of January 2026.

Mayor of the City of Moreno Valley

ATTEST:

City Clerk

APPROVED AS TO FORM:

City Attorney

RESOLUTION JURAT

STATE OF CALIFORNIA)

COUNTY OF RIVERSIDE) ss.

CITY OF MORENO VALLEY)

I, M. Patricia Rodriguez, City Clerk of the City of Moreno Valley, California, do hereby certify that Resolution No. 2026-____ was duly and regularly adopted by the City Council of the City of Moreno Valley at a regular meeting thereof held on the 20th day of January 2026 by the following vote:

AYES:

NOES:

ABSENT:

ABSTAIN:

(Council Members, Mayor Pro Tem and Mayor)

CITY CLERK

(SEAL)

EXHIBIT A

List of Annexation Parcels			
Boundary Map Amendment No.	Assessor's Parcel Numbers	FY 2025/26 Maximum Special Tax Rate ¹	
124	264-082-057	Accessory Dwelling Unit	\$216.30/Unit
127	481-222-006	Accessory Dwelling Unit	\$216.30/Unit
128	484-241-009	Accessory Dwelling Unit	\$216.30/Unit
133	481-062-004	Accessory Dwelling Unit	\$216.30/Unit
134	474-271-003	Accessory Dwelling Unit	\$216.30/Unit
135	484-171-019	Accessory Dwelling Unit	\$216.30/Unit
136	291-150-008	Accessory Dwelling Unit	\$216.30/Unit
137	304-450-027	Accessory Dwelling Unit	\$216.30/Unit
138	482-142-013	Accessory Dwelling Unit	\$216.30/Unit
139	479-220-017	Commercial	\$58.80/1,000 Feet of Building Square Footage
140	479-514-001	Accessory Dwelling Unit	\$216.30/Unit
¹ Based on current development plans, it is anticipated that the Annexation Group will be in the Land Use Category listed above; however, all taxes will be calculated as set forth in the Rate and Method of Apportionment.			

EXHIBIT B

Boundary Map Amendments

**AMENDMENT NO. 127 TO BOUNDARIES OF
COMMUNITY FACILITIES DISTRICT NO. 2023-01
(PUBLIC SAFETY SERVICES)**

SHEET 1 OF 1

CITY OF MORENO VALLEY
COUNTY OF RIVERSIDE
STATE OF CALIFORNIA

(THIS MAP AMENDS, BY ADDING THE ADDITIONAL TERRITORY SHOWN HEREON, THE BOUNDARY MAP FOR THE CITY OF MORENO VALLEY COMMUNITY FACILITIES DISTRICT NO. 2023-01 (PUBLIC SAFETY SERVICES), CITY OF MORENO VALLEY, RIVERSIDE COUNTY, STATE OF CALIFORNIA, PRIOR RECORDED AT BOOK 92 OF MAPS OF ASSESSMENT AND COMMUNITY FACILITIES DISTRICTS AT PAGE 18, IN THE OFFICE OF THE COUNTY RECORDER FOR THE COUNTY OF RIVERSIDE, STATE OF CALIFORNIA.)

FILED IN THE OFFICE OF THE CITY CLERK OF THE CITY OF MORENO VALLEY THIS _____ DAY OF _____, 202__.

CITY CLERK
CITY OF MORENO VALLEY
RIVERSIDE COUNTY, CALIFORNIA

I HEREBY CERTIFY THAT THE WITHIN MAP SHOWING THE PROPOSED BOUNDARIES OF COMMUNITY FACILITIES DISTRICT NO. 2023-01 (PUBLIC SAFETY SERVICES), CITY OF MORENO VALLEY, COUNTY OF RIVERSIDE, STATE OF CALIFORNIA, WAS APPROVED BY THE CITY COUNCIL OF THE CITY OF MORENO VALLEY, AT A REGULAR MEETING THEREOF, HELD ON THE _____ DAY OF _____, 202__, BY ITS RESOLUTION NO. _____.

CITY CLERK
CITY OF MORENO VALLEY
RIVERSIDE COUNTY, CALIFORNIA

FILED THIS _____ DAY OF _____, 202__ AT THE HOUR OF _____ O'CLOCK _____ M. IN BOOK _____ AT PAGE _____ OF MAPS OF ASSESSMENT AND COMMUNITY FACILITIES DISTRICTS AS INSTRUMENT NO. _____ IN THE OFFICE OF THE COUNTY RECORDER OF THE COUNTY OF RIVERSIDE, STATE OF CALIFORNIA.

ASSESSOR OR DESIGNEE
COUNTY CLERK AND RECORDER
COUNTY OF RIVERSIDE, CALIFORNIA

REFERENCE IS MADE TO THAT BOUNDARY MAP OF THE COMMUNITY FACILITIES DISTRICT NO. 2023-01 (PUBLIC SAFETY SERVICES) OF THE CITY OF MORENO VALLEY, RECORDED WITH THE RIVERSIDE COUNTY RECORDERS' OFFICE ON OCTOBER 25, 2023 IN BOOK 92 OF MAPS OF ASSESSMENT AND COMMUNITY FACILITIES DISTRICTS, PAGE 18 AS INSTRUMENT NO. 2023-0319881.

REFERENCE IS FURTHER MADE TO ANNEXATION MAP NO. 2 OF COMMUNITY FACILITIES DISTRICT NO. 2023-01 (PUBLIC SAFETY SERVICES), CITY OF MORENO VALLEY, COUNTY OF RIVERSIDE, STATE OF CALIFORNIA (TERRITORY PROPOSED FOR ANNEXATION IN THE FUTURE, WITH THE CONDITION THAT PARCELS WITHIN THE TERRITORY MAY BE ANNEXED ONLY WITH THE UNANIMOUS APPROVAL OF THE OWNER OR OWNERS OF EACH PARCEL OR PARCELS AT THE TIME THAT PARCEL OR THOSE PARCELS ARE ANNEXED) RECORDED WITH THE RIVERSIDE COUNTY RECORDERS' OFFICE ON JANUARY 19, 2024 IN BOOK 92, PAGE 55 OF MAPS OF ASSESSMENT AND COMMUNITY FACILITIES DISTRICTS AS INSTRUMENT NO. 2024-001758 WHICH DESIGNATED THE TERRITORY SHOWN HEREIN AS TERRITORY FOR FUTURE ANNEXATION TO THE COMMUNITY FACILITIES DISTRICT REFERENCED THEREON.

FOR PARTICULARS OF THE LINES AND DIMENSIONS OF ASSESSOR PARCELS, REFERENCE IS MADE TO THE MAPS OF THE ASSESSOR, COUNTY OF RIVERSIDE, STATE OF CALIFORNIA. THE RIVERSIDE COUNTY ASSESSOR'S MAPS SHALL GOVERN FOR ALL DETAILS CONCERNING THE LINES AND DIMENSIONS OF SUCH LOTS OR PARCELS.



Legend

- Annexation Parcels
- Surrounding Area Parcels

N
1 inch = 70 feet

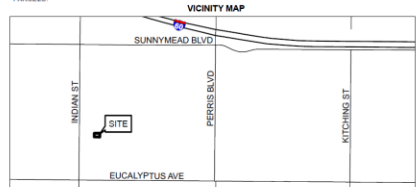

**AMENDMENT NO. 128 TO BOUNDARIES OF
COMMUNITY FACILITIES DISTRICT NO. 2023-01
(PUBLIC SAFETY SERVICES)**

CITY OF MORENO VALLEY
COUNTY OF RIVERSIDE
STATE OF CALIFORNIA

THIS MAP AMENDS, BY ADDING THE ADDITIONAL TERRITORY SHOWN HEREON, THE BOUNDARY MAP FOR THE CITY OF MORENO VALLEY COMMUNITY FACILITIES DISTRICT NO. 2023-01 (PUBLIC SAFETY SERVICES), CITY OF MORENO VALLEY, RIVERSIDE COUNTY, STATE OF CALIFORNIA, PRIOR RECORDED AT BOOK 92 OF MAPS OF ASSESSMENT AND COMMUNITY FACILITIES DISTRICTS AT PAGE 18, IN THE OFFICE OF THE COUNTY RECORDER FOR THE COUNTY OF RIVERSIDE, STATE OF CALIFORNIA.

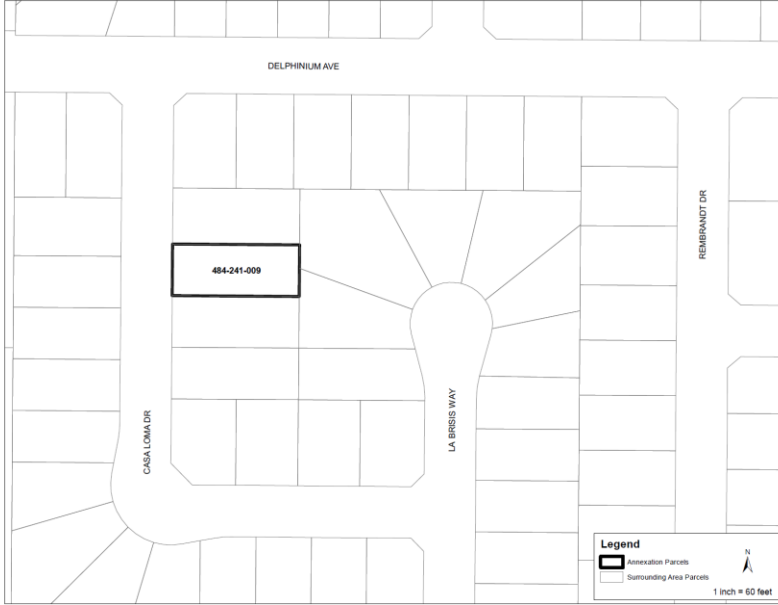

FILED IN THE OFFICE OF THE CITY CLERK OF THE CITY OF MORENO VALLEY THIS _____ DAY OF _____, 202__

CITY CLERK
CITY OF MORENO VALLEY
RIVERSIDE COUNTY, CALIFORNIA

I HEREBY CERTIFY THAT THE WITHIN MAP SHOWING THE PROPOSED BOUNDARIES OF COMMUNITY FACILITIES DISTRICT NO. 2023-01 (PUBLIC SAFETY SERVICES), CITY OF MORENO VALLEY, COUNTY OF RIVERSIDE, STATE OF CALIFORNIA, WAS APPROVED BY THE CITY COUNCIL OF THE CITY OF MORENO VALLEY, AT A REGULAR MEETING THEREOF, HELD ON THE _____ DAY OF _____, 202__, BY ITS RESOLUTION NO. _____

CITY CLERK
CITY OF MORENO VALLEY
RIVERSIDE COUNTY, CALIFORNIA

FILED THIS _____ DAY OF _____, 202__, AT THE HOUR OF _____ O'CLOCK _____ M, IN BOOK _____ AT PAGE _____ OF MAPS OF ASSESSMENT AND COMMUNITY FACILITIES DISTRICTS AS INSTRUMENT NO. _____ IN THE OFFICE OF THE COUNTY RECORDER OF THE COUNTY OF RIVERSIDE, STATE OF CALIFORNIA

ASSESSOR OR DESIGNEE
COUNTY CLERK AND RECORDER
COUNTY OF RIVERSIDE, CALIFORNIA

REFERENCE IS MADE TO THAT BOUNDARY MAP OF THE COMMUNITY FACILITIES DISTRICT NO. 2023-01 (PUBLIC SAFETY SERVICES) OF THE CITY OF MORENO VALLEY, RECORDED WITH THE RIVERSIDE COUNTY RECORDERS OFFICE ON OCTOBER 25, 2023 IN BOOK 92 OF MAPS OF ASSESSMENT AND COMMUNITY FACILITIES DISTRICTS, PAGE 18 AS INSTRUMENT NO. 2023-0315681.

REFERENCE IS FURTHER MADE TO ANNEXATION MAP NO. 2 OF COMMUNITY FACILITIES DISTRICT NO. 2023-01 (PUBLIC SAFETY SERVICES), CITY OF MORENO VALLEY, COUNTY OF RIVERSIDE, STATE OF CALIFORNIA (TERRITORY PROPOSED FOR ANNEXATION IN THE FUTURE, WITH THE CONDITION THAT PARCELS WITHIN THE TERRITORY MAY BE ANNEXED ONLY WITH THE UNANIMOUS APPROVAL OF THE OWNER OR OWNERS OF EACH PARCEL OR PARCELS AT THE TIME THAT PARCEL OR THOSE PARCELS ARE ANNEXED) RECORDED WITH THE RIVERSIDE COUNTY RECORDER'S OFFICE ON JANUARY 19, 2024 IN BOOK 92, PAGE 55 OF MAPS OF ASSESSMENT AND COMMUNITY FACILITIES DISTRICTS AS INSTRUMENT NO. 2024-001706 WHICH DESIGNATED THE TERRITORY SHOWN HEREIN AS TERRITORY FOR FUTURE ANNEXATION TO THE COMMUNITY FACILITIES DISTRICT REFERENCED THEREON.

FOR PARTICULARS OF THE LINES AND DIMENSIONS OF ASSESSOR PARCELS, REFERENCE IS MADE TO THE MAPS OF THE ASSESSOR, COUNTY OF RIVERSIDE, STATE OF CALIFORNIA. THE RIVERSIDE COUNTY ASSESSOR'S MAPS SHALL GOVERN FOR ALL DETAILS CONCERNING THE LINES AND DIMENSIONS OF SUCH LOTS OR PARCELS.

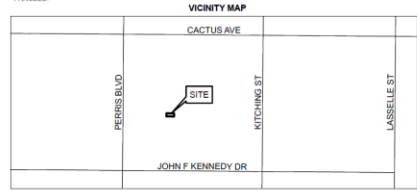

WILLDAN
27366 Via Inductra, Suite 200
Torrance, CA 90509
(811) 587-2600

**AMENDMENT NO. 133 TO BOUNDARIES OF
COMMUNITY FACILITIES DISTRICT NO. 2023-01
(PUBLIC SAFETY SERVICES)**

SHEET 1 OF 1

CITY OF MORENO VALLEY
COUNTY OF RIVERSIDE
STATE OF CALIFORNIA

(THIS MAP AMENDS, BY ADDING THE ADDITIONAL TERRITORY SHOWN HEREON, THE BOUNDARY MAP FOR THE CITY OF MORENO VALLEY COMMUNITY FACILITIES DISTRICT NO. 2023-01 (PUBLIC SAFETY SERVICES), CITY OF MORENO VALLEY, RIVERSIDE COUNTY, STATE OF CALIFORNIA, PRIOR RECORDED AT BOOK 92 OF MAPS OF ASSESSMENT AND COMMUNITY FACILITIES DISTRICTS AT PAGE 18, IN THE OFFICE OF THE COUNTY RECORDER FOR THE COUNTY OF RIVERSIDE, STATE OF CALIFORNIA.)



FILED IN THE OFFICE OF THE CITY CLERK OF THE CITY OF MORENO VALLEY THIS _____ DAY OF _____, 202__

CITY CLERK
CITY OF MORENO VALLEY
RIVERSIDE COUNTY, CALIFORNIA

I HEREBY CERTIFY THAT THE WITHIN MAP SHOWING THE PROPOSED BOUNDARIES OF COMMUNITY FACILITIES DISTRICT NO. 2023-01 (PUBLIC SAFETY SERVICES), CITY OF MORENO VALLEY, COUNTY OF RIVERSIDE, STATE OF CALIFORNIA, WAS APPROVED BY THE CITY COUNCIL OF THE CITY OF MORENO VALLEY AT A REGULAR MEETING THEREOF, HELD ON THE _____ DAY OF _____, 202__ BY ITS RESOLUTION NO. _____

CITY CLERK
CITY OF MORENO VALLEY
RIVERSIDE COUNTY, CALIFORNIA

FILED THIS _____ DAY OF _____, 202__, AT THE HOUR OF _____ O'CLOCK _____ M. IN BOOK _____ AT PAGE _____ OF MAPS OF ASSESSMENT AND COMMUNITY FACILITIES DISTRICTS AS INSTRUMENT NO. _____ IN THE OFFICE OF THE COUNTY RECORDER OF THE COUNTY OF RIVERSIDE, STATE OF CALIFORNIA.

ASSESSOR OR DESIGNEE
COUNTY CLERK AND RECORDER
COUNTY OF RIVERSIDE, CALIFORNIA

REFERENCE IS MADE TO THAT BOUNDARY MAP OF THE COMMUNITY FACILITIES DISTRICT NO. 2023-01 (PUBLIC SAFETY SERVICES) OF THE CITY OF MORENO VALLEY, COUNTY OF RIVERSIDE, STATE OF CALIFORNIA, RECORDED WITH THE RIVERSIDE COUNTY RECORDERS OFFICE ON OCTOBER 25, 2023 IN BOOK 92 OF MAPS OF ASSESSMENT AND COMMUNITY FACILITIES DISTRICTS, PAGE 18 AS INSTRUMENT NO. 2023-0315681.

REFERENCE IS FURTHER MADE TO ANNEXATION MAP NO. 2 OF COMMUNITY FACILITIES DISTRICT NO. 2023-01 (PUBLIC SAFETY SERVICES), CITY OF MORENO VALLEY, COUNTY OF RIVERSIDE, STATE OF CALIFORNIA (TERRITORY PROPOSED FOR ANNEXATION IN THE FUTURE, WITH THE CONDITION THAT PARCELS WITHIN THE TERRITORY MAY BE ANNEXED ONLY WITH THE UNANIMOUS APPROVAL OF THE OWNER OR OWNERS OF EACH PARCEL OR PARCELS AT THE TIME THAT PARCEL OR THOSE PARCELS ARE ANNEXED) RECORDED WITH THE RIVERSIDE COUNTY RECORDER'S OFFICE ON JANUARY 19, 2024 IN BOOK 92, PAGE 55 OF MAPS OF ASSESSMENT AND COMMUNITY FACILITIES DISTRICTS AS INSTRUMENT NO. 2024-01786 WHICH DESIGNATED THE TERRITORY SHOWN HEREIN AS TERRITORY FOR FUTURE ANNEXATION TO THE COMMUNITY FACILITIES DISTRICT REFERENCED THEREON.

FOR PARTICULARS OF THE LINES AND DIMENSIONS OF ASSESSOR PARCELS, REFERENCE IS MADE TO THE MAPS OF THE ASSESSOR, COUNTY OF RIVERSIDE, STATE OF CALIFORNIA. THE RIVERSIDE COUNTY ASSESSOR'S MAPS SHALL GOVERN FOR ALL DETAILS CONCERNING THE LINES AND DIMENSIONS OF SUCH LOTS OR PARCELS.

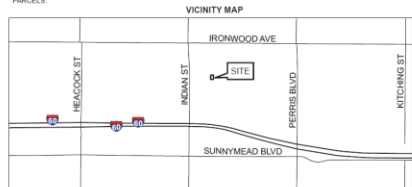

WILLDAN
27360 Via Deputata, Suite 200
Menlo Park, CA 94025
(919) 587-3000

**AMENDMENT NO. 134 TO BOUNDARIES OF
COMMUNITY FACILITIES DISTRICT NO. 2023-01
(PUBLIC SAFETY SERVICES)**

SHEET 1 OF 1

CITY OF MORENO VALLEY
COUNTY OF RIVERSIDE
STATE OF CALIFORNIA

(THIS MAP AMENDS, BY ADDING THE ADDITIONAL TERRITORY SHOWN HEREON, THE BOUNDARY MAP FOR THE CITY OF MORENO VALLEY COMMUNITY FACILITIES DISTRICT NO. 2023-01 (PUBLIC SAFETY SERVICES), CITY OF MORENO VALLEY, RIVERSIDE COUNTY, STATE OF CALIFORNIA, PRIOR RECORDED AT BOOK 92 OF MAPS OF ASSESSMENT AND COMMUNITY FACILITIES DISTRICTS AT PAGE 18, IN THE OFFICE OF THE COUNTY RECORDER FOR THE COUNTY OF RIVERSIDE, STATE OF CALIFORNIA.)



FILED IN THE OFFICE OF THE CITY CLERK OF THE CITY OF MORENO VALLEY THIS _____ DAY OF _____, 202__.

CITY CLERK
CITY OF MORENO VALLEY
RIVERSIDE COUNTY, CALIFORNIA

I HEREBY CERTIFY THAT THE WITHIN MAP SHOWING THE PROPOSED BOUNDARIES OF COMMUNITY FACILITIES DISTRICT NO. 2023-01 (PUBLIC SAFETY SERVICES), CITY OF MORENO VALLEY, COUNTY OF RIVERSIDE, STATE OF CALIFORNIA, WAS APPROVED BY THE CITY COUNCIL OF THE CITY OF MORENO VALLEY AT A REGULAR MEETING THEREOF, HELD ON THE _____ DAY OF _____, 202__, BY ITS RESOLUTION NO. _____.

CITY CLERK
CITY OF MORENO VALLEY
RIVERSIDE COUNTY, CALIFORNIA

FILED THIS _____ DAY OF _____, 202__, AT THE HOUR OF _____ O'CLOCK _____ M. IN BOOK _____ AT PAGE _____ OF MAPS OF ASSESSMENT AND COMMUNITY FACILITIES DISTRICTS AS INSTRUMENT NO. _____ IN THE OFFICE OF THE COUNTY RECORDER OF THE COUNTY OF RIVERSIDE, STATE OF CALIFORNIA.

ASSESSOR OR DESIGNEE
COUNTY CLERK AND RECORDER
COUNTY OF RIVERSIDE, CALIFORNIA

REFERENCE IS MADE TO THAT BOUNDARY MAP OF THE COMMUNITY FACILITIES DISTRICT NO. 2023-01 (PUBLIC SAFETY SERVICES) OF THE CITY OF MORENO VALLEY, RECORDED WITH THE RIVERSIDE COUNTY RECORDER'S OFFICE ON OCTOBER 25, 2023 IN BOOK 92 OF MAPS OF ASSESSMENT AND COMMUNITY FACILITIES DISTRICTS, PAGE 18 AS INSTRUMENT NO. 2023-0315681.

REFERENCE IS FURTHER MADE TO ANNEXATION MAP NO. 2 OF COMMUNITY FACILITIES DISTRICT NO. 2023-01 (PUBLIC SAFETY SERVICES), CITY OF MORENO VALLEY, COUNTY OF RIVERSIDE, STATE OF CALIFORNIA (TERRITORY PROPOSED FOR ANNEXATION IN THE FUTURE, WITH THE CONDITION THAT PARCELS WITHIN THE TERRITORY MAY BE ANNEXED ONLY WITH THE UNANIMOUS APPROVAL OF THE OWNER OR OWNERS OF EACH PARCEL OR PARCELS AT THE TIME THAT PARCEL OR THOSE PARCELS ARE ANNEXED) RECORDED WITH THE RIVERSIDE COUNTY RECORDER'S OFFICE ON JANUARY 19, 2024 IN BOOK 92, PAGE 55 OF MAPS OF ASSESSMENT AND COMMUNITY FACILITIES DISTRICTS AS INSTRUMENT NO. 2024-01794 WHICH DESIGNATED THE TERRITORY SHOWN HEREIN AS TERRITORY FOR FUTURE ANNEXATION TO THE COMMUNITY FACILITIES DISTRICT REFERENCED THEREON.

FOR PARTICULARS OF THE LINES AND DIMENSIONS OF ASSESSOR PARCELS, REFERENCE IS MADE TO THE MAPS OF THE ASSESSOR, COUNTY OF RIVERSIDE, STATE OF CALIFORNIA. THE RIVERSIDE COUNTY ASSESSOR'S MAPS SHALL GOVERN FOR ALL DETAILS CONCERNING THE LINES AND DIMENSIONS OF SUCH LOTS OR PARCELS.

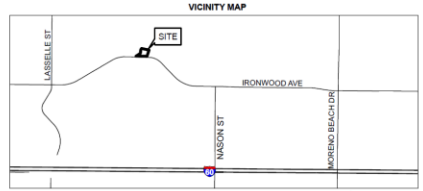

WILLDAN
27361 Via Industrial, Suite 200
Moreno Valley, CA 92550
(951) 987-9000

**AMENDMENT NO. 135 TO BOUNDARIES OF
COMMUNITY FACILITIES DISTRICT NO. 2023-01
(PUBLIC SAFETY SERVICES)**

SHEET 1 OF 1

CITY OF MORENO VALLEY
COUNTY OF RIVERSIDE
STATE OF CALIFORNIA

THIS MAP AMENDS, BY ADDING THE ADDITIONAL TERRITORY SHOWN HEREON, THE BOUNDARY MAP FOR THE CITY OF MORENO VALLEY COMMUNITY FACILITIES DISTRICT NO. 2023-01 (PUBLIC SAFETY SERVICES), CITY OF MORENO VALLEY, RIVERSIDE COUNTY, STATE OF CALIFORNIA, PRIOR RECORDED AT BOOK 92 OF MAPS OF ASSESSMENT AND COMMUNITY FACILITIES DISTRICTS AT PAGE 18, IN THE OFFICE OF THE COUNTY RECORDER FOR THE COUNTY OF RIVERSIDE, STATE OF CALIFORNIA.



FILED IN THE OFFICE OF THE CITY CLERK OF THE CITY OF MORENO VALLEY THIS _____ DAY OF _____, 202__.

CITY CLERK
CITY OF MORENO VALLEY
RIVERSIDE COUNTY, CALIFORNIA

I HEREBY CERTIFY THAT THE WITHIN MAP SHOWING THE PROPOSED BOUNDARIES OF COMMUNITY FACILITIES DISTRICT NO. 2023-01 (PUBLIC SAFETY SERVICES), CITY OF MORENO VALLEY, COUNTY OF RIVERSIDE, STATE OF CALIFORNIA, WAS APPROVED BY THE CITY COUNCIL OF THE CITY OF MORENO VALLEY AT A REGULAR MEETING THEREOF, HELD ON THE _____ DAY OF _____, 202__ BY ITS RESOLUTION NO. _____.

CITY CLERK
CITY OF MORENO VALLEY
RIVERSIDE COUNTY, CALIFORNIA

FILED THIS _____ DAY OF _____, 202__, AT THE HOUR OF _____ O'CLOCK _____ M. IN BOOK _____ AT PAGE _____ OF MAPS OF ASSESSMENT AND COMMUNITY FACILITIES DISTRICTS AS INSTRUMENT NO. _____ IN THE OFFICE OF THE COUNTY RECORDER OF THE COUNTY OF RIVERSIDE, STATE OF CALIFORNIA.

ASSESSOR OR DESIGNEE
COUNTY CLERK AND RECORDER
COUNTY OF RIVERSIDE, CALIFORNIA

REFERENCE IS MADE TO THAT BOUNDARY MAP OF THE COMMUNITY FACILITIES DISTRICT NO. 2023-01 (PUBLIC SAFETY SERVICES) OF THE CITY OF MORENO VALLEY, COUNTY OF RIVERSIDE, STATE OF CALIFORNIA, RECORDED WITH THE RIVERSIDE COUNTY RECORDERS OFFICE ON OCTOBER 23, 2023 IN BOOK 92 OF MAPS OF ASSESSMENT AND COMMUNITY FACILITIES DISTRICTS, PAGE 18 AS INSTRUMENT NO. 2023-0315681.

REFERENCE IS FURTHER MADE TO ANNEXATION MAP NO. 2 OF COMMUNITY FACILITIES DISTRICT NO. 2023-01 (PUBLIC SAFETY SERVICES), CITY OF MORENO VALLEY, COUNTY OF RIVERSIDE, STATE OF CALIFORNIA (TERRITORY PROPOSED FOR ANNEXATION IN THE FUTURE, WITH THE CONDITION THAT PARCELS WITHIN THE TERRITORY MAY BE ANNEXED ONLY WITH THE UNANIMOUS APPROVAL OF THE OWNERS OR OWNERS OF EACH PARCEL OR PARCELS AT THE TIME THAT PARCEL OR THOSE PARCELS ARE ANNEXED RECORDED WITH THE RIVERSIDE COUNTY RECORDER'S OFFICE ON JANUARY 19, 2024 IN BOOK 92, PAGE 55 OF MAPS OF ASSESSMENT AND COMMUNITY FACILITIES DISTRICTS AS INSTRUMENT NO. 2024-0017904 WHICH DESIGNATED THE TERRITORY SHOWN HEREIN AS TERRITORY FOR FUTURE ANNEXATION TO THE COMMUNITY FACILITIES DISTRICT REFERENCED THEREON.

FOR PARTICULARS OF THE LINES AND DIMENSIONS OF ASSESSOR PARCELS, REFERENCE IS MADE TO THE MAPS OF THE ASSESSOR, COUNTY OF RIVERSIDE, STATE OF CALIFORNIA. THE RIVERSIDE COUNTY ASSESSORS MAPS SHALL GOVERN FOR ALL DETAILS CONCERNING THE LINES AND DIMENSIONS OF SUCH LOTS OR PARCELS.

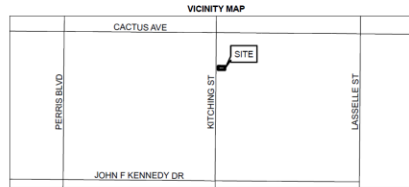

WILLDAN
27366 Via Escondido, Suite 200
Temecula, CA 92590
(951) 947-2000

**AMENDMENT NO. 136 TO BOUNDARIES OF
COMMUNITY FACILITIES DISTRICT NO. 2023-01
(PUBLIC SAFETY SERVICES)**

CITY OF MORENO VALLEY
COUNTY OF RIVERSIDE
STATE OF CALIFORNIA

(THIS MAP AMENDS, BY ADDING THE ADDITIONAL TERRITORY SHOWN HEREON, THE BOUNDARY MAP FOR THE CITY OF MORENO VALLEY COMMUNITY FACILITIES DISTRICT NO. 2023-01 (PUBLIC SAFETY SERVICES), CITY OF MORENO VALLEY, RIVERSIDE COUNTY, STATE OF CALIFORNIA, PRIOR RECORDED AT BOOK 92 OF MAPS OF ASSESSMENT AND COMMUNITY FACILITIES DISTRICTS AT PAGE 18, IN THE OFFICE OF THE COUNTY RECORDER FOR THE COUNTY OF RIVERSIDE, STATE OF CALIFORNIA.)



FILED IN THE OFFICE OF THE CITY CLERK OF THE CITY OF MORENO VALLEY THIS ____ DAY OF _____, 202__.

CITY CLERK
CITY OF MORENO VALLEY
RIVERSIDE COUNTY, CALIFORNIA

I HEREBY CERTIFY THAT THE WITHIN MAP SHOWING THE PROPOSED BOUNDARIES OF COMMUNITY FACILITIES DISTRICT NO. 2023-01 (PUBLIC SAFETY SERVICES), CITY OF MORENO VALLEY, COUNTY OF RIVERSIDE, STATE OF CALIFORNIA, WAS APPROVED BY THE CITY COUNCIL OF THE CITY OF MORENO VALLEY, AT A REGULAR MEETING THEREOF, HELD ON THE ____ DAY OF _____, 202__, BY ITS RESOLUTION NO. _____.

CITY CLERK
CITY OF MORENO VALLEY
RIVERSIDE COUNTY, CALIFORNIA

FILED THIS ____ DAY OF _____, 202__, AT THE HOUR OF ____ O'CLOCK ____ M. IN BOOK ____ AT PAGE ____ OF MAPS OF ASSESSMENT AND COMMUNITY FACILITIES DISTRICTS AS INSTRUMENT NO. _____ IN THE OFFICE OF THE COUNTY RECORDER OF THE COUNTY OF RIVERSIDE, STATE OF CALIFORNIA.

ASSESSOR OR DESIGNEE
COUNTY CLERK AND RECORDER
COUNTY OF RIVERSIDE, CALIFORNIA

REFERENCE IS MADE TO THAT BOUNDARY MAP OF THE COMMUNITY FACILITIES DISTRICT NO. 2023-01 (PUBLIC SAFETY SERVICES) OF THE CITY OF MORENO VALLEY, RECORDED WITH THE RIVERSIDE COUNTY RECORDERS OFFICE ON OCTOBER 25, 2023 IN BOOK 92 OF MAPS OF ASSESSMENT AND COMMUNITY FACILITIES DISTRICTS, PAGE 18 AS INSTRUMENT NO. 2023-0315681.

REFERENCE IS FURTHER MADE TO ANNEXATION MAP NO. 2 OF COMMUNITY FACILITIES DISTRICT NO. 2023-01 (PUBLIC SAFETY SERVICES), CITY OF MORENO VALLEY, COUNTY OF RIVERSIDE, STATE OF CALIFORNIA (TERRITORY PROPOSED FOR ANNEXATION IN THE FUTURE, WITH THE CONDITION THAT PARCELS WITHIN THE TERRITORY MAY BE ANNEXED ONLY WITH THE UNANIMOUS APPROVAL OF THE OWNER OR OWNERS OF EACH PARCEL OR PARCELS AT THE TIME THAT PARCEL OR THOSE PARCELS ARE ANNEXED) RECORDED WITH THE RIVERSIDE COUNTY RECORDER'S OFFICE ON JANUARY 19, 2024 IN BOOK 92, PAGE 55 OF MAPS OF ASSESSMENT AND COMMUNITY FACILITIES DISTRICTS AS INSTRUMENT NO. 2024-017068 WHICH DESIGNATED THE TERRITORY SHOWN HEREIN AS TERRITORY FOR FUTURE ANNEXATION TO THE COMMUNITY FACILITIES DISTRICT REFERENCED THEREON.

FOR PARTICULARS OF THE LINES AND DIMENSIONS OF ASSESSOR PARCELS, REFERENCE IS MADE TO THE MAPS OF THE ASSESSOR, COUNTY OF RIVERSIDE, STATE OF CALIFORNIA. THE RIVERSIDE COUNTY ASSESSORS MAPS SHALL GOVERN FOR ALL DETAILS CONCERNING THE LINES AND DIMENSIONS OF SUCH LOTS OR PARCELS.

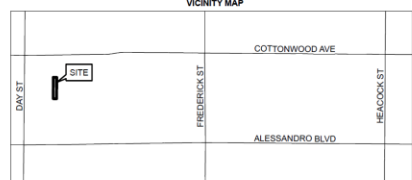

**AMENDMENT NO. 137 TO BOUNDARIES OF
COMMUNITY FACILITIES DISTRICT NO. 2023-01
(PUBLIC SAFETY SERVICES)**

SHEET 1 OF 1

CITY OF MORENO VALLEY
COUNTY OF RIVERSIDE
STATE OF CALIFORNIA

(THIS MAP AMENDS, BY ADDING THE ADDITIONAL TERRITORY SHOWN HEREON, THE BOUNDARY MAP FOR THE CITY OF MORENO VALLEY COMMUNITY FACILITIES DISTRICT NO. 2023-01 (PUBLIC SAFETY SERVICES), CITY OF MORENO VALLEY, RIVERSIDE COUNTY, STATE OF CALIFORNIA. PRIOR RECORDED AT BOOK 92 OF MAPS OF ASSESSMENT AND COMMUNITY FACILITIES DISTRICTS AT PAGE 18, IN THE OFFICE OF THE COUNTY RECORDER FOR THE COUNTY OF RIVERSIDE, STATE OF CALIFORNIA.)

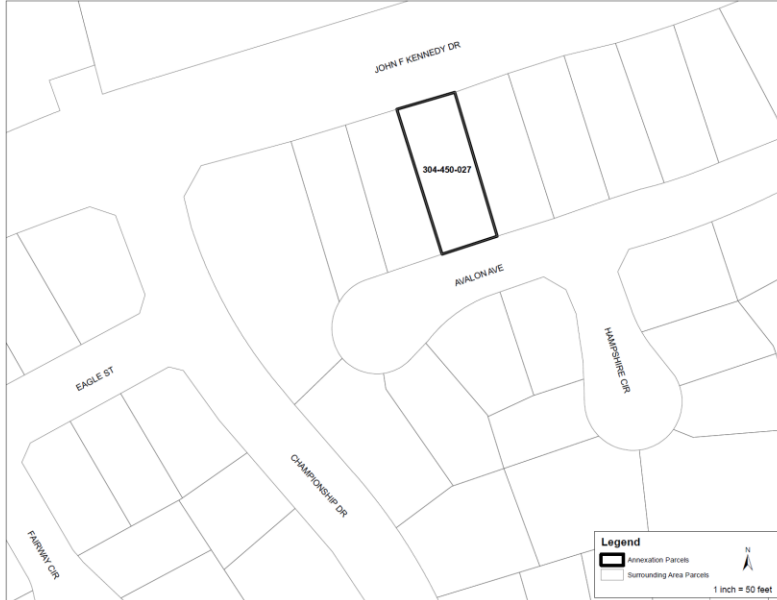

FILED IN THE OFFICE OF THE CITY CLERK OF THE CITY OF MORENO VALLEY THIS _____ DAY OF _____, 202__.

CITY CLERK
CITY OF MORENO VALLEY
RIVERSIDE COUNTY, CALIFORNIA

I HEREBY CERTIFY THAT THE WITHIN MAP SHOWING THE PROPOSED BOUNDARIES OF COMMUNITY FACILITIES DISTRICT NO. 2023-01 (PUBLIC SAFETY SERVICES), CITY OF MORENO VALLEY, COUNTY OF RIVERSIDE, STATE OF CALIFORNIA, WAS APPROVED BY THE CITY COUNCIL OF THE CITY OF MORENO VALLEY AT A REGULAR MEETING THEREOF, HELD ON THE _____ DAY OF _____, 202__ BY ITS RESOLUTION NO. _____.

CITY CLERK
CITY OF MORENO VALLEY
RIVERSIDE COUNTY, CALIFORNIA

FILED THIS _____ DAY OF _____, 202__, AT THE HOUR OF _____ O'CLOCK _____ M. IN BOOK _____ AT PAGE _____ OF MAPS OF ASSESSMENT AND COMMUNITY FACILITIES DISTRICTS AS INSTRUMENT NO. _____ IN THE OFFICE OF THE COUNTY RECORDER OF THE COUNTY OF RIVERSIDE, STATE OF CALIFORNIA.

ASSESSOR OR DESIGNEE
COUNTY CLERK AND RECORDER
COUNTY OF RIVERSIDE, CALIFORNIA

REFERENCE IS MADE TO THAT BOUNDARY MAP OF THE COMMUNITY FACILITIES DISTRICT NO. 2023-01 (PUBLIC SAFETY SERVICES) OF THE CITY OF MORENO VALLEY, RECORDED WITH THE RIVERSIDE COUNTY RECORDERS OFFICE ON OCTOBER 25, 2023 IN BOOK 92 OF MAPS OF ASSESSMENT AND COMMUNITY FACILITIES DISTRICTS, PAGE 18 AS INSTRUMENT NO. 2023-0315681.

REFERENCE IS FURTHER MADE TO ANNEXATION MAP NO. 2 OF COMMUNITY FACILITIES DISTRICT NO. 2023-01 (PUBLIC SAFETY SERVICES), CITY OF MORENO VALLEY, COUNTY OF RIVERSIDE, STATE OF CALIFORNIA (TERRITORY PROPOSED FOR ANNEXATION IN THE FUTURE, WITH THE CONDITION THAT PARCELS WITHIN THE TERRITORY MAY BE ANNEXED ONLY WITH THE UNANIMOUS APPROVAL OF THE OWNER OR OWNERS OF EACH PARCEL OR PARCELS AT THE TIME THAT PARCEL OR THOSE PARCELS ARE ANNEXED) RECORDED WITH THE RIVERSIDE COUNTY RECORDERS OFFICE ON JANUARY 19, 2024 IN BOOK 92, PAGE 50 OF MAPS OF ASSESSMENT AND COMMUNITY FACILITIES DISTRICTS AS INSTRUMENT NO. 2024-0017054 WHICH DESIGNATED THE TERRITORY SHOWN HEREIN AS TERRITORY FOR FUTURE ANNEXATION TO THE COMMUNITY FACILITIES DISTRICT REFERENCED THEREON.

FOR PARTICULARS OF THE LINES AND DIMENSIONS OF ASSESSOR PARCELS, REFERENCE IS MADE TO THE MAPS OF THE ASSESSOR, COUNTY OF RIVERSIDE, STATE OF CALIFORNIA. THE RIVERSIDE COUNTY ASSESSORS MAPS SHALL GOVERN FOR ALL DETAILS CONCERNING THE LINES AND DIMENSIONS OF SUCH LOTS OR PARCELS.

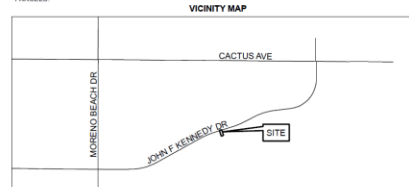

WILLDAN
27500 Via Valeritas, Suite 200
Irvine, CA 92618
(949) 587-3000

**AMENDMENT NO. 138 TO BOUNDARIES OF
COMMUNITY FACILITIES DISTRICT NO. 2023-01
(PUBLIC SAFETY SERVICES)**

SHEET 1 OF 1

CITY OF MORENO VALLEY
COUNTY OF RIVERSIDE
STATE OF CALIFORNIA

(THIS MAP AMENDS, BY ADDING THE ADDITIONAL TERRITORY SHOWN HEREON, THE BOUNDARY MAP FOR THE CITY OF MORENO VALLEY COMMUNITY FACILITIES DISTRICT NO. 2023-01 (PUBLIC SAFETY SERVICES), CITY OF MORENO VALLEY, RIVERSIDE COUNTY, STATE OF CALIFORNIA, PRIOR RECORDED AT BOOK 92 OF MAPS OF ASSESSMENT AND COMMUNITY FACILITIES DISTRICTS AT PAGE 18, IN THE OFFICE OF THE COUNTY RECORDER FOR THE COUNTY OF RIVERSIDE, STATE OF CALIFORNIA.)

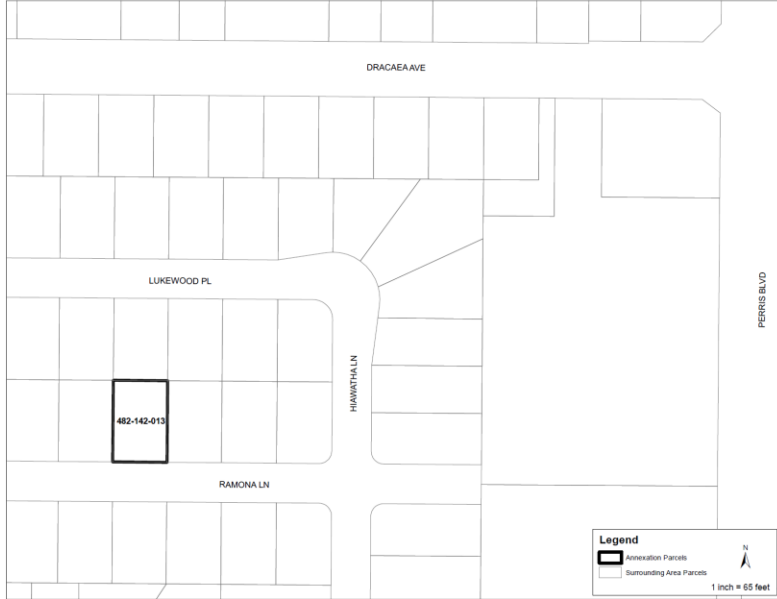

FILED IN THE OFFICE OF THE CITY CLERK OF THE CITY OF MORENO VALLEY THIS _____ DAY OF _____, 202__.

CITY CLERK
CITY OF MORENO VALLEY
RIVERSIDE COUNTY, CALIFORNIA

I HEREBY CERTIFY THAT THE WITHIN MAP SHOWING THE PROPOSED BOUNDARIES OF COMMUNITY FACILITIES DISTRICT NO. 2023-01 (PUBLIC SAFETY SERVICES), CITY OF MORENO VALLEY, COUNTY OF RIVERSIDE, STATE OF CALIFORNIA, WAS APPROVED BY THE CITY COUNCIL OF THE CITY OF MORENO VALLEY, AT A REGULAR MEETING THEREOF, HELD ON THE _____ DAY OF _____, 202__ BY ITS RESOLUTION NO. _____.

CITY CLERK
CITY OF MORENO VALLEY
RIVERSIDE COUNTY, CALIFORNIA

FILED THIS _____ DAY OF _____, 202__, AT THE HOUR OF _____ O'CLOCK _____ M. IN BOOK _____ AT PAGE _____ OF MAPS OF ASSESSMENT AND COMMUNITY FACILITIES DISTRICTS AS INSTRUMENT NO. _____ IN THE OFFICE OF THE COUNTY RECORDER OF THE COUNTY OF RIVERSIDE, STATE OF CALIFORNIA.

ASSESSOR OR DESIGNEE
COUNTY CLERK AND RECORDER
COUNTY OF RIVERSIDE, CALIFORNIA

REFERENCE IS MADE TO THAT BOUNDARY MAP OF THE COMMUNITY FACILITIES DISTRICT NO. 2023-01 (PUBLIC SAFETY SERVICES) OF THE CITY OF MORENO VALLEY, RECORDED WITH THE RIVERSIDE COUNTY RECORDERS OFFICE, ON OCTOBER 25, 2023 IN BOOK 92 OF MAPS OF ASSESSMENT AND COMMUNITY FACILITIES DISTRICTS, PAGE 18 AS INSTRUMENT NO. 2023-0315681.

REFERENCE IS FURTHER MADE TO ANNEXATION MAP NO. 2 OF COMMUNITY FACILITIES DISTRICT NO. 2023-01 (PUBLIC SAFETY SERVICES), CITY OF MORENO VALLEY, COUNTY OF RIVERSIDE, STATE OF CALIFORNIA (TERRITORY PROPOSED FOR ANNEXATION IN THE FUTURE, WITH THE CONDITION THAT PARCELS WITHIN THE TERRITORY MAY BE ANNEXED ONLY WITH THE UNANIMOUS APPROVAL OF THE OWNER OR OWNERS OF EACH PARCEL OR PARCELS AT THE TIME THAT PARCEL OR THOSE PARCELS ARE ANNEXED) RECORDED WITH THE RIVERSIDE COUNTY RECORDER'S OFFICE ON JANUARY 19, 2024 IN BOOK 92, PAGE 55 OF MAPS OF ASSESSMENT AND COMMUNITY FACILITIES DISTRICTS AS INSTRUMENT NO. 2024-01706 WHICH DESIGNATED THE TERRITORY SHOWN HEREIN AS TERRITORY FOR FUTURE ANNEXATION TO THE COMMUNITY FACILITIES DISTRICT REFERENCED THEREON.

FOR PARTICULARS OF THE LINES AND DIMENSIONS OF ASSESSOR PARCELS, REFERENCE IS MADE TO THE MAPS OF THE ASSESSOR, COUNTY OF RIVERSIDE, STATE OF CALIFORNIA. THE RIVERSIDE COUNTY ASSESSOR'S MAPS SHALL GOVERN FOR ALL DETAILS CONCERNING THE LINES AND DIMENSIONS OF SUCH LOTS OR PARCELS.

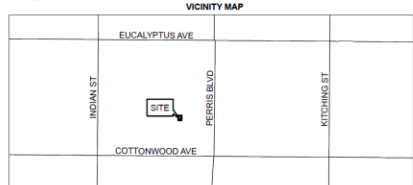

WILLDAN
27360 Via Induarte, Suite 200
Temecula, CA 92590
(951) 967-2600

**AMENDMENT NO. 139 TO BOUNDARIES OF
COMMUNITY FACILITIES DISTRICT NO. 2023-01
(PUBLIC SAFETY SERVICES)**

CITY OF MORENO VALLEY
COUNTY OF RIVERSIDE
STATE OF CALIFORNIA

(THIS MAP AMENDS BY ADDING THE ADDITIONAL TERRITORY SHOWN HEREON, THE BOUNDARY MAP FOR THE CITY OF MORENO VALLEY COMMUNITY FACILITIES DISTRICT NO. 2023-01 (PUBLIC SAFETY SERVICES), CITY OF MORENO VALLEY, RIVERSIDE COUNTY, STATE OF CALIFORNIA, PRIOR RECORDED AT BOOK 92 OF MAPS OF ASSESSMENT AND COMMUNITY FACILITIES DISTRICTS AT PAGE 10, IN THE OFFICE OF THE COUNTY RECORDER FOR THE COUNTY OF RIVERSIDE, STATE OF CALIFORNIA.)

FILED IN THE OFFICE OF THE CITY CLERK OF THE CITY OF MORENO VALLEY THIS _____ DAY OF _____, 202__

CITY CLERK
CITY OF MORENO VALLEY
RIVERSIDE COUNTY, CALIFORNIA

I HEREBY CERTIFY THAT THE WITHIN MAP SHOWING THE PROPOSED BOUNDARIES OF COMMUNITY FACILITIES DISTRICT NO. 2023-01 (PUBLIC SAFETY SERVICES), CITY OF MORENO VALLEY, COUNTY OF RIVERSIDE, STATE OF CALIFORNIA, WAS APPROVED BY THE CITY COUNCIL OF THE CITY OF MORENO VALLEY, AT A REGULAR MEETING THEREOF, HELD ON THE _____ DAY OF _____, 202__, BY ITS RESOLUTION NO. _____

CITY CLERK
CITY OF MORENO VALLEY
RIVERSIDE COUNTY, CALIFORNIA

FILED THIS _____ DAY OF _____, 202__, AT THE HOUR OF _____ O'CLOCK _____ M. IN BOOK _____ AT PAGE _____ OF MAPS OF ASSESSMENT AND COMMUNITY FACILITIES DISTRICTS AS INSTRUMENT NO. _____ IN THE OFFICE OF THE COUNTY RECORDER OF THE COUNTY OF RIVERSIDE, STATE OF CALIFORNIA.

ASSESSOR OR DESIGNEE
COUNTY CLERK AND RECORDER
COUNTY OF RIVERSIDE, CALIFORNIA

REFERENCE IS MADE TO THAT BOUNDARY MAP OF THE COMMUNITY FACILITIES DISTRICT NO. 2023-01 (PUBLIC SAFETY SERVICES) OF THE CITY OF MORENO VALLEY, COUNTY OF RIVERSIDE, STATE OF CALIFORNIA, RECORDED WITH THE RIVERSIDE COUNTY RECORDER'S OFFICE ON OCTOBER 25, 2023 IN BOOK 92 OF MAPS OF ASSESSMENT AND COMMUNITY FACILITIES DISTRICTS, PAGE 10 AS INSTRUMENT NO. 2023-0315681.

REFERENCE IS FURTHER MADE TO ANNEXATION MAP NO. 2 OF COMMUNITY FACILITIES DISTRICT NO. 2023-01 (PUBLIC SAFETY SERVICES), CITY OF MORENO VALLEY, COUNTY OF RIVERSIDE, STATE OF CALIFORNIA (TERRITORY PROPOSED FOR ANNEXATION IN THE FUTURE, WITH THE CONDITION THAT PARCELS WITHIN THE TERRITORY MAY BE ANNEXED ONLY WITH THE UNANIMOUS APPROVAL OF THE OWNER OR OWNERS OF EACH PARCEL OR PARCELS AT THE TIME THAT PARCEL OR THOSE PARCELS ARE ANNEXED) RECORDED WITH THE RIVERSIDE COUNTY RECORDER'S OFFICE ON JANUARY 13, 2024 IN BOOK 33, PAGE 33 OF MAPS OF ASSESSMENT AND COMMUNITY FACILITIES DISTRICTS AS INSTRUMENT NO. 2024-0017964 WHICH DESIGNATED THE TERRITORY SHOWN HEREIN AS TERRITORY FOR FUTURE ANNEXATION TO THE COMMUNITY FACILITIES DISTRICT REFERENCED THEREON.

FOR PARTICULARS OF THE LINES AND DIMENSIONS OF ASSESSOR PARCELS, REFERENCE IS MADE TO THE MAPS OF THE ASSESSOR, COUNTY OF RIVERSIDE, STATE OF CALIFORNIA. THE RIVERSIDE COUNTY ASSESSOR'S MAPS SHALL GOVERN FOR ALL DETAILS CONCERNING THE LINES AND DIMENSIONS OF SUCH LOTS OR PARCELS.

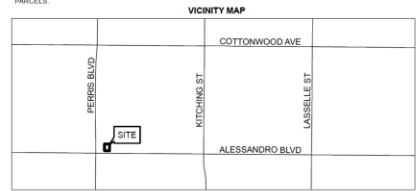
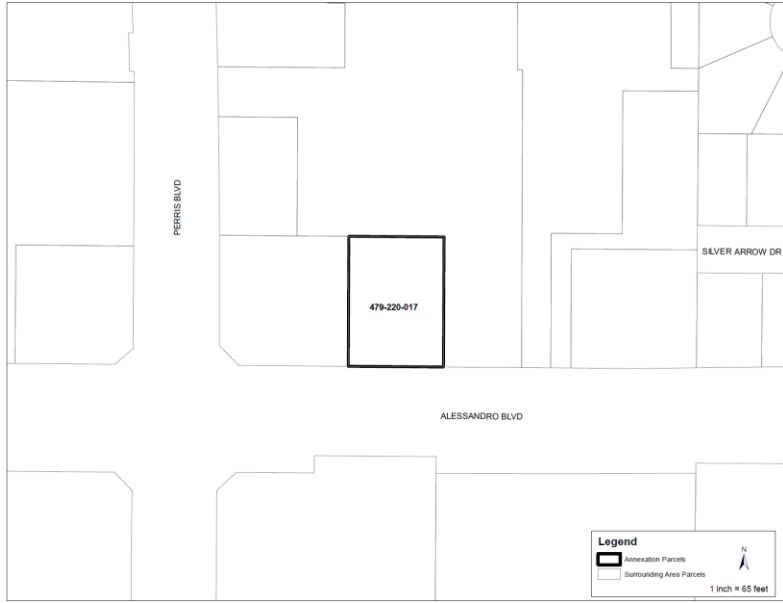

**AMENDMENT NO. 140 TO BOUNDARIES OF
COMMUNITY FACILITIES DISTRICT NO. 2023-01
(PUBLIC SAFETY SERVICES)**

SHEET 1 OF 1

CITY OF MORENO VALLEY
COUNTY OF RIVERSIDE
STATE OF CALIFORNIA

(THIS MAP AMENDS, BY ADDING THE ADDITIONAL TERRITORY SHOWN HEREON, THE BOUNDARY MAP FOR THE CITY OF MORENO VALLEY COMMUNITY FACILITIES DISTRICT NO. 2023-01 (PUBLIC SAFETY SERVICES), CITY OF MORENO VALLEY, RIVERSIDE COUNTY, STATE OF CALIFORNIA, PRIOR RECORDED AT BOOK 92 OF MAPS OF ASSESSMENT AND COMMUNITY FACILITIES DISTRICTS AT PAGE 18, IN THE OFFICE OF THE COUNTY RECORDER FOR THE COUNTY OF RIVERSIDE, STATE OF CALIFORNIA.)

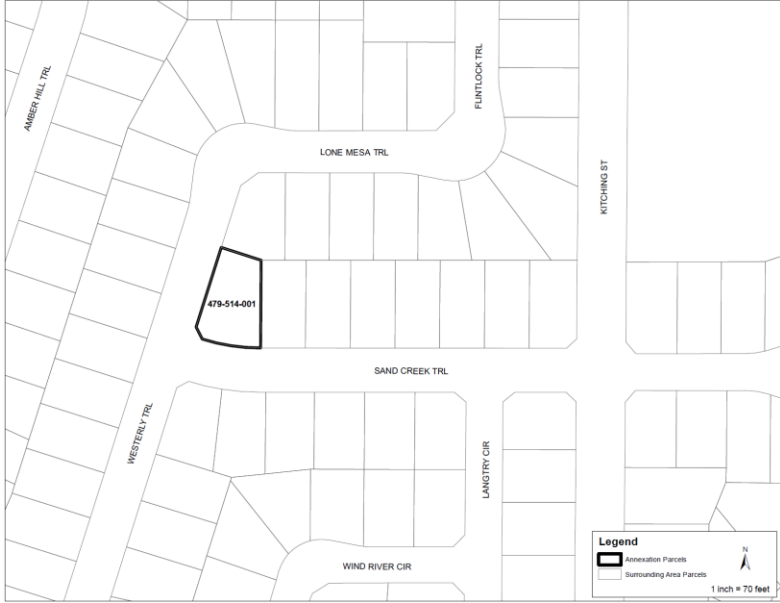

FILED IN THE OFFICE OF THE CITY CLERK OF THE CITY OF MORENO VALLEY THIS ____ DAY OF _____, 202__.

CITY CLERK
CITY OF MORENO VALLEY
RIVERSIDE COUNTY, CALIFORNIA

I HEREBY CERTIFY THAT THE WITHIN MAP SHOWING THE PROPOSED BOUNDARIES OF COMMUNITY FACILITIES DISTRICT NO. 2023-01 (PUBLIC SAFETY SERVICES), CITY OF MORENO VALLEY, COUNTY OF RIVERSIDE, STATE OF CALIFORNIA, WAS APPROVED BY THE CITY COUNCIL OF THE CITY OF MORENO VALLEY AT A REGULAR MEETING THEREOF, HELD ON THE ____ DAY OF _____, 202__, BY ITS RESOLUTION NO. _____.

CITY CLERK
CITY OF MORENO VALLEY
RIVERSIDE COUNTY, CALIFORNIA

FILED THIS ____ DAY OF _____, 202__ AT THE HOUR OF ____ O'CLOCK ____ M. IN BOOK ____ AT PAGE ____ OF MAPS OF ASSESSMENT AND COMMUNITY FACILITIES DISTRICTS AS INSTRUMENT NO. _____ IN THE OFFICE OF THE COUNTY RECORDER OF THE COUNTY OF RIVERSIDE, STATE OF CALIFORNIA.

ASSESSOR OR DESIGNEE
COUNTY CLERK AND RECORDER
COUNTY OF RIVERSIDE, CALIFORNIA

REFERENCE IS MADE TO THAT BOUNDARY MAP OF THE COMMUNITY FACILITIES DISTRICT NO. 2023-01 (PUBLIC SAFETY SERVICES) OF THE CITY OF MORENO VALLEY RECORDED WITH THE RIVERSIDE COUNTY RECORDER'S OFFICE ON OCTOBER 25, 2023 IN BOOK 92 OF MAPS OF ASSESSMENT AND COMMUNITY FACILITIES DISTRICTS, PAGE 18 AS INSTRUMENT NO. 2023-0115681.

REFERENCE IS FURTHER MADE TO ANNEXATION MAP NO. 2 OF COMMUNITY FACILITIES DISTRICT NO. 2023-01 (PUBLIC SAFETY SERVICES), CITY OF MORENO VALLEY, COUNTY OF RIVERSIDE, STATE OF CALIFORNIA (TERRITORY PROPOSED FOR ANNEXATION IN THE FUTURE, WITH THE CONDITION THAT PARCELS WITHIN THE TERRITORY MAY BE ANNEXED ONLY WITH THE UNANIMOUS APPROVAL OF THE OWNER OR OWNERS OF EACH PARCEL OR PARCELS AT THE TIME THAT PARCEL OR THOSE PARCELS ARE ANNEXED RECORDED WITH THE RIVERSIDE COUNTY RECORDER'S OFFICE ON JANUARY 19, 2024 IN BOOK 92, PAGE 55 OF MAPS OF ASSESSMENT AND COMMUNITY FACILITIES DISTRICTS AS INSTRUMENT NO. 2024-001794 WHICH DESIGNATED THE TERRITORY SHOWN HEREIN AS TERRITORY FOR FUTURE ANNEXATION TO THE COMMUNITY FACILITIES DISTRICT REFERENCED THEREON.

FOR PARTICULARS OF THE LINES AND DIMENSIONS OF ASSESSOR PARCELS, REFERENCE IS MADE TO THE MAPS OF THE ASSESSOR, COUNTY OF RIVERSIDE, STATE OF CALIFORNIA. THE RIVERSIDE COUNTY ASSESSOR'S MAPS SHALL GOVERN FOR ALL DETAILS CONCERNING THE LINES AND DIMENSIONS OF SUCH LOTS OR PARCELS.

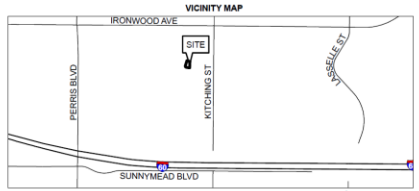

WILLDAN
27368 Via Industrial, Suite 200
Temecula, CA 92590
(951) 987-2500