

RESOLUTION NO. 2025-____

A RESOLUTION OF THE CITY COUNCIL OF THE CITY OF MORENO VALLEY, CALIFORNIA, ORDERING THE ANNEXATION OF TERRITORY TO CITY OF MORENO VALLEY COMMUNITY FACILITIES DISTRICT NO. 2023-01 (PUBLIC SAFETY SERVICES) AND APPROVING AMENDED MAPS FOR SAID DISTRICT

WHEREAS, by its Resolution No. 2023-82, the City Council established the City of Moreno Valley Community Facilities District No. 2023-01 (Public Safety Services) (the “CFD”), a citywide district, pursuant to the Mello-Roos Community Facilities Act of 1982 (Government Code Section 53311 *et seq.*) (the “Act”); and

WHEREAS, by its Ordinance No. 1004, the City Council authorized an annual special tax to be levied against all non-exempt parcels of real property within the CFD (the “Special Tax”) to fund public safety services; and

WHEREAS, in order to permit landowners to efficiently annex developing parcels to the CFD, the City Council, by its Ordinance No. 1007 designated the entire territory of the City as a future annexation area for the CFD and approved the rate and method of apportionment for the Special Tax; and

WHEREAS, the landowner of the parcels listed in Exhibit A to this Resolution, which is attached hereto and incorporated herein by reference, has submitted to the City a petition requesting and approving annexation to the CFD of said parcels; and

WHEREAS, territory proposed for annexation to the CFD Parcels are shown on the boundary maps titled “Amendment Nos. 97, 99, 100, 102-104, 107-109, and 112 to Boundaries of City of Moreno Valley Community Facilities District No. 2023-01 (Public Safety Services), City of Moreno Valley, County of Riverside, State of California” (the “Boundary Maps”), which are attached hereto as Exhibit B, and incorporated herein by this reference; and

WHEREAS, the City Council desires to annex the territory shown on the Boundary Maps (the Annexation Parcels) to the CFD.

NOW, THEREFORE, THE CITY COUNCIL OF THE CITY OF MORENO VALLEY, CALIFORNIA, DOES HEREBY RESOLVE AS FOLLOWS:

1. Recitals. The above recitals are all true and correct and are herein incorporated.
2. Annexations Approved. The Annexation Parcels are hereby added to and made part of the CFD with full legal effect. The Annexation Parcels are subject to the Special Tax as indicated on Exhibit A to this Resolution.
3. Description of Services. The following is a general description of all services (the “Services”) provided in the CFD:

Police protection services; fire protection and suppression services; and paramedic services, to the extent such services are in addition to services already provided at the time CFD No. 2023-01 is created and do not supplant existing services.

Fundable costs include, but are not limited to: (i) direct costs for such services, (ii) salaries and benefits of staff providing such services, (iii) expenses related to equipment, apparatus, and supplies related to these services, (iv) administrative and overhead costs, including staff time, associated with providing such services, and (v) lifecycle costs associated with the repair and replacement of facilities and improvements used to provide such services. Fundable costs also include the incidental expenses of the administration of CFD No. 2023-01.

4. Amended Boundary Maps. The Boundary Maps are hereby approved. These maps amend, and does not supersede, the existing maps of the CFD. The City Council directs that said maps be filed with the Riverside County Recorder pursuant to Section 3113 of the Streets and Highways Code.

5. Notices of Special Tax Lien. The City Council directs that amended notices of special tax lien be recorded pursuant to Section 3117.5 of the Streets and Highways Code with respect to the Annexation Parcels associated with the Boundary Maps.

6. This Resolution shall be effective immediately upon adoption.

7. The City Clerk shall certify the adoption of this Resolution and shall maintain on file as a public record this Resolution.

8. Severability. That the City Council declares that, should any provision, section, paragraph, sentence or word of this Resolution be rendered or declared invalid by any final court action in a court of competent jurisdiction or by reason of any preemptive legislation, the remaining provisions, sections, paragraphs, sentences or words of this Resolution as hereby adopted shall remain in full force and effect.

9. Repeal of Conflicting Provisions. That all the provisions heretofore adopted by the City Council that are in conflict with the provisions of this Resolution are hereby repealed.

APPROVED AND ADOPTED this 16th day of September 2025.

Mayor of the City of Moreno Valley

ATTEST:

City Clerk

APPROVED AS TO FORM:

City Attorney

RESOLUTION JURAT

STATE OF CALIFORNIA)

COUNTY OF RIVERSIDE) ss.

CITY OF MORENO VALLEY)

I, M. Patricia Rodriguez, City Clerk of the City of Moreno Valley, California, do hereby certify that Resolution No. 2025-____ was duly and regularly adopted by the City Council of the City of Moreno Valley at a regular meeting thereof held on the 16th day of September 2025 by the following vote:

AYES:

NOES:

ABSENT:

ABSTAIN:

(Council Members, Mayor Pro Tem and Mayor)

CITY CLERK

(SEAL)

EXHIBIT A

List of Annexation Parcel(s)			
Boundary Map Amendment No.	Assessor's Parcel Number(s)	FY 2025/26 Maximum Special Tax Rate	
97	474-064-008	Accessory Dwelling Unit	\$216.30/Unit
99	256-320-022	Accessory Dwelling Unit	\$216.30/Unit
100	484-103-007	Accessory Dwelling Unit	\$216.30/Unit
102	259-490-001	Accessory Dwelling Unit	\$216.30/Unit
103	479-302-010	Accessory Dwelling Unit	\$216.30/Unit
104	291-531-010	Accessory Dwelling Unit	\$216.30/Unit
107	484-271-007	Accessory Dwelling Unit	\$216.30/Unit
108	256-291-009	Accessory Dwelling Unit	\$216.30/Unit
109	475-141-040	Accessory Dwelling Unit	\$216.30/Unit
112	475-141-039	Accessory Dwelling Unit	\$216.30/Unit
<p>Based on current development plans, it is anticipated that the Annexation Group will be in the Land Use Category listed above; however, all taxes will be calculated as set forth in the Rate and Method of Apportionment.</p>			

EXHIBIT B

Boundary Map Amendments

**AMENDMENT NO. 97 TO BOUNDARIES OF
COMMUNITY FACILITIES DISTRICT NO. 2023-01
(PUBLIC SAFETY SERVICES)**

SHEET 1 OF 1

**CITY OF MORENO VALLEY
COUNTY OF RIVERSIDE
STATE OF CALIFORNIA**

(THIS MAP AMENDS, BY ADDING THE ADDITIONAL TERRITORY SHOWN HEREON, THE BOUNDARY MAP FOR THE CITY OF MORENO VALLEY COMMUNITY FACILITIES DISTRICT NO. 2023-01 (PUBLIC SAFETY SERVICES), CITY OF MORENO VALLEY, RIVERSIDE COUNTY, STATE OF CALIFORNIA, PRIOR RECORDED AT BOOK 92 OF MAPS OF ASSESSMENT AND COMMUNITY FACILITIES DISTRICTS AT PAGE 18, IN THE OFFICE OF THE COUNTY RECORDER FOR THE COUNTY OF RIVERSIDE, STATE OF CALIFORNIA.)



FILED IN THE OFFICE OF THE CITY CLERK OF THE CITY OF MORENO VALLEY THIS ____ DAY OF ____ 20__

CITY CLERK
CITY OF MORENO VALLEY
RIVERSIDE COUNTY, CALIFORNIA

I HEREBY CERTIFY THAT THE WITHIN MAP SHOWING THE PROPOSED BOUNDARIES OF COMMUNITY FACILITIES DISTRICT NO. 2023-01 (PUBLIC SAFETY SERVICES), CITY OF MORENO VALLEY, COUNTY OF RIVERSIDE, STATE OF CALIFORNIA, WAS APPROVED BY THE CITY COUNCIL OF THE CITY OF MORENO VALLEY, AT A REGULAR MEETING THEREOF, HELD ON THE ____ DAY OF ____ 20__ BY ITS RESOLUTION NO. ____

CITY CLERK
CITY OF MORENO VALLEY
RIVERSIDE COUNTY, CALIFORNIA

FILED THIS ____ DAY OF ____ 20__ AT THE HOUR OF ____ O'CLOCK ____ M. IN BOOK ____ AT PAGE ____ OF MAPS OF ASSESSMENT AND COMMUNITY FACILITIES DISTRICTS AS INSTRUMENT NO. ____ IN THE OFFICE OF THE COUNTY RECORDER OF THE COUNTY OF RIVERSIDE, STATE OF CALIFORNIA.

ASSESSOR OR DESIGNEE
COUNTY CLERK AND RECORDER
COUNTY OF RIVERSIDE, CALIFORNIA

REFERENCE IS MADE TO THAT BOUNDARY MAP OF THE COMMUNITY FACILITIES DISTRICT NO. 2023-01 (PUBLIC SAFETY SERVICES) OF THE CITY OF MORENO VALLEY, RECORDED WITH THE RIVERSIDE COUNTY RECORDERS OFFICE ON OCTOBER 25, 2023 IN BOOK 92 OF MAPS OF ASSESSMENT AND COMMUNITY FACILITIES DISTRICTS, PAGE 18 AS INSTRUMENT NO. 2023-0116561

REFERENCE IS FURTHER MADE TO ANNEXATION MAP NO. 2 OF COMMUNITY FACILITIES DISTRICT NO. 2023-01 (PUBLIC SAFETY SERVICES), CITY OF MORENO VALLEY, COUNTY OF RIVERSIDE, STATE OF CALIFORNIA (TERRITORY PROPOSED FOR ANNEXATION IN THE FUTURE, WITH THE CONDITION THAT PARCELS WITHIN THE TERRITORY MAY BE ANNEXED ONLY WITH THE UNANIMOUS APPROVAL OF THE OWNER OR OWNERS OF EACH PARCEL, OR PARCELS AT THE TIME THAT PARCEL OR THOSE PARCELS ARE ANNEXED) RECORDED WITH THE RIVERSIDE COUNTY RECORDERS OFFICE ON JANUARY 19, 2024 IN BOOK 92, PAGE 25 OF MAPS OF ASSESSMENT AND COMMUNITY FACILITIES DISTRICTS AS INSTRUMENT NO. 2024-001794 WHICH DESIGNATED THE TERRITORY SHOWN HEREON AS TERRITORY FOR FUTURE ANNEXATION TO THE COMMUNITY FACILITIES DISTRICT REFERENCED THEREON.

FOR PARTICULARS OF THE LINES AND DIMENSIONS OF ASSESSOR PARCELS, REFERENCE IS MADE TO THE MAPS OF THE ASSESSOR, COUNTY OF RIVERSIDE, STATE OF CALIFORNIA. THE RIVERSIDE COUNTY ASSESSORS MAPS SHALL GOVERN FOR ALL DETAILS CONCERNING THE LINES AND DIMENSIONS OF SUCH LOTS OR PARCELS.

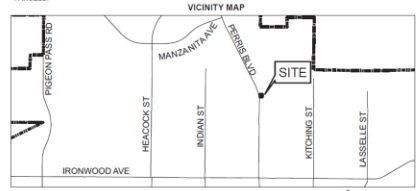

**AMENDMENT NO. 99 TO BOUNDARIES OF
COMMUNITY FACILITIES DISTRICT NO. 2023-01
(PUBLIC SAFETY SERVICES)**

CITY OF MORENO VALLEY
COUNTY OF RIVERSIDE
STATE OF CALIFORNIA

(THIS MAP AMENDS, BY ADDING THE ADDITIONAL TERRITORY SHOWN HEREON, THE BOUNDARY MAP FOR THE CITY OF MORENO VALLEY COMMUNITY FACILITIES DISTRICT NO. 2023-01 (PUBLIC SAFETY SERVICES), CITY OF MORENO VALLEY, RIVERSIDE COUNTY, STATE OF CALIFORNIA, PRIOR RECORDED AT BOOK 52 OF MAPS OF ASSESSMENT AND COMMUNITY FACILITIES DISTRICTS AT PAGE 18, IN THE OFFICE OF THE COUNTY RECORDER FOR THE COUNTY OF RIVERSIDE, STATE OF CALIFORNIA.)

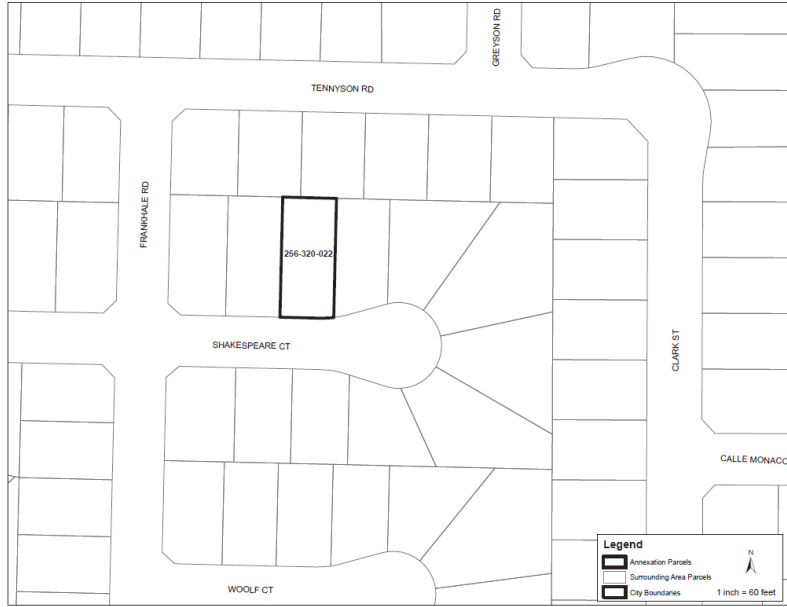

FILED IN THE OFFICE OF THE CITY CLERK OF THE CITY OF MORENO VALLEY THIS ____ DAY OF _____, 202__.

CITY CLERK
CITY OF MORENO VALLEY
RIVERSIDE COUNTY, CALIFORNIA

I HEREBY CERTIFY THAT THE WITHIN MAP SHOWING THE PROPOSED BOUNDARIES OF COMMUNITY FACILITIES DISTRICT NO. 2023-01 (PUBLIC SAFETY SERVICES), CITY OF MORENO VALLEY, COUNTY OF RIVERSIDE, STATE OF CALIFORNIA, WAS APPROVED BY THE CITY COUNCIL OF THE CITY OF MORENO VALLEY, AT A REGULAR MEETING THEREOF, HELD ON THE ____ DAY OF _____, 202__ BY ITS RESOLUTION NO. _____.

CITY CLERK
CITY OF MORENO VALLEY
RIVERSIDE COUNTY, CALIFORNIA

FILED THIS ____ DAY OF _____, 202__ AT THE HOUR OF ____ O'CLOCK ____ M. IN BOOK ____ AT PAGE ____ OF MAPS OF ASSESSMENT AND COMMUNITY FACILITIES DISTRICTS AS INSTRUMENT NO. _____ IN THE OFFICE OF THE COUNTY RECORDER OF THE COUNTY OF RIVERSIDE, STATE OF CALIFORNIA.

ASSESSOR OR DESIGNEE
COUNTY CLERK AND RECORDER
COUNTY OF RIVERSIDE, CALIFORNIA

REFERENCE IS MADE TO THAT BOUNDARY MAP OF THE COMMUNITY FACILITIES DISTRICT NO. 2023-01 (PUBLIC SAFETY SERVICES) OF THE CITY OF MORENO VALLEY, RECORDED WITH THE RIVERSIDE COUNTY RECORDERS OFFICE ON OCTOBER 25, 2023, IN BOOK 52 OF MAPS OF ASSESSMENT AND COMMUNITY FACILITIES DISTRICTS, PAGE 18 AS INSTRUMENT NO. 2023-0315581.

REFERENCE IS FURTHER MADE TO ANNEXATION MAP NO. 2 OF COMMUNITY FACILITIES DISTRICT NO. 2023-01 (PUBLIC SAFETY SERVICES), CITY OF MORENO VALLEY, COUNTY OF RIVERSIDE, STATE OF CALIFORNIA (TERRITORY PROPOSED FOR ANNEXATION IN THE FUTURE, WITH THE CONDITION THAT PARCELS WITHIN THE TERRITORY MAY BE ANNEXED ONLY WITH THE UNANIMOUS APPROVAL OF THE OWNER OR OWNERS OF EACH PARCEL OR PARCELS AT THE TIME THAT PARCEL OR THOSE PARCELS ARE ANNEXED RECORDED WITH THE RIVERSIDE COUNTY RECORDER'S OFFICE ON JANUARY 19, 2024 IN BOOK 52, PAGE 18 OF MAPS OF ASSESSMENT AND COMMUNITY FACILITIES DISTRICTS AS INSTRUMENT NO. 2024-001700 WHICH DESIGNATED THE TERRITORY SHOWN HEREIN AS TERRITORY FOR FUTURE ANNEXATION TO THE COMMUNITY FACILITIES DISTRICT REFERENCED THEREON.

FOR PARTICULARS OF THE LINES AND DIMENSIONS OF ASSESSOR PARCELS, REFERENCE IS MADE TO THE MAPS OF THE ASSESSOR, COUNTY OF RIVERSIDE, STATE OF CALIFORNIA, THE RIVERSIDE COUNTY ASSESSOR'S MAPS SHALL GOVERN FOR ALL DETAILS CONCERNING THE LINES AND DIMENSIONS OF SUCH LOTS OR PARCELS.

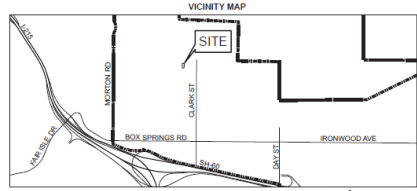

WILLDAN
27368 Via Industria, Suite 200
Menifee, CA 92586
(951) 947-2000

**AMENDMENT NO. 100 TO BOUNDARIES OF
COMMUNITY FACILITIES DISTRICT NO. 2023-01
(PUBLIC SAFETY SERVICES)**

CITY OF MORENO VALLEY
COUNTY OF RIVERSIDE
STATE OF CALIFORNIA

(THIS MAP AMENDS, BY ADDING THE ADDITIONAL TERRITORY SHOWN HEREON, THE BOUNDARY MAP FOR THE CITY OF MORENO VALLEY COMMUNITY FACILITIES DISTRICT NO. 2023-01 (PUBLIC SAFETY SERVICES), CITY OF MORENO VALLEY, RIVERSIDE COUNTY, STATE OF CALIFORNIA, PRIOR RECORDED AT BOOK 92 OF MAPS OF ASSESSMENT AND COMMUNITY FACILITIES DISTRICTS AT PAGE 19, IN THE OFFICE OF THE COUNTY RECORDER FOR THE COUNTY OF RIVERSIDE, STATE OF CALIFORNIA.)

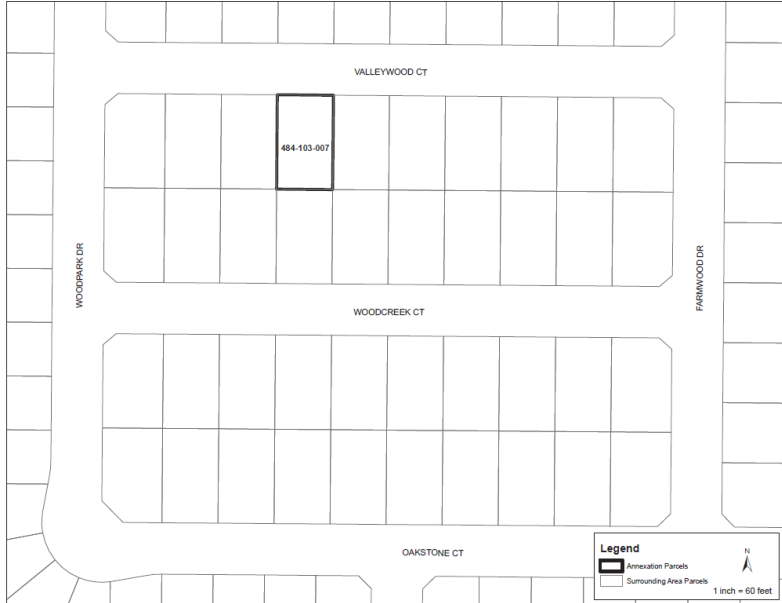

FILED IN THE OFFICE OF THE CITY CLERK OF THE CITY OF MORENO VALLEY THIS _____ DAY OF _____, 202__.

CITY CLERK
CITY OF MORENO VALLEY
RIVERSIDE COUNTY, CALIFORNIA

I HEREBY CERTIFY THAT THE WITHIN MAP SHOWING THE PROPOSED BOUNDARIES OF COMMUNITY FACILITIES DISTRICT NO. 2023-01 (PUBLIC SAFETY SERVICES), CITY OF MORENO VALLEY, COUNTY OF RIVERSIDE, STATE OF CALIFORNIA, WAS APPROVED BY THE CITY COUNCIL OF THE CITY OF MORENO VALLEY, AT A REGULAR MEETING THEREOF, HELD ON THE _____ DAY OF _____, 202__ BY ITS RESOLUTION NO. _____.

CITY CLERK
CITY OF MORENO VALLEY
RIVERSIDE COUNTY, CALIFORNIA

FILED THIS _____ DAY OF _____, 202__ AT THE HOUR OF _____ O'CLOCK _____ M. IN BOOK _____ AT PAGE _____ OF MAPS OF ASSESSMENT AND COMMUNITY FACILITIES DISTRICTS AS INSTRUMENT NO. _____ IN THE OFFICE OF THE COUNTY RECORDER OF THE COUNTY OF RIVERSIDE, STATE OF CALIFORNIA.

ASSESSOR OR DESIGNEE
COUNTY CLERK AND RECORDER
COUNTY OF RIVERSIDE, CALIFORNIA

REFERENCE IS MADE TO THAT BOUNDARY MAP OF THE COMMUNITY FACILITIES DISTRICT NO. 2023-01 (PUBLIC SAFETY SERVICES) OF THE CITY OF MORENO VALLEY, RECORDED WITH THE RIVERSIDE COUNTY RECORDERS OFFICE ON OCTOBER 23, 2023 IN BOOK 92 OF MAPS OF ASSESSMENT AND COMMUNITY FACILITIES DISTRICTS, PAGE 18 AS INSTRUMENT NO. 2023-0315981.

REFERENCE IS FURTHER MADE TO ANNEXATION MAP NO. 2 OF COMMUNITY FACILITIES DISTRICT NO. 2023-01 (PUBLIC SAFETY SERVICES), CITY OF MORENO VALLEY, COUNTY OF RIVERSIDE, STATE OF CALIFORNIA (TERRITORY PROPOSED FOR ANNEXATION IN THE FUTURE, WITH THE CONDITION THAT PARCELS WITHIN THE TERRITORY MAY BE ANNEXED ONLY WITH THE UNANIMOUS APPROVAL OF THE OWNER OR OWNERS OF EACH PARCEL OR PARCELS AT THE TIME THAT PARCEL OR THOSE PARCELS ARE ANNEXED) RECORDED WITH THE RIVERSIDE COUNTY RECORDER'S OFFICE ON JANUARY 19, 2024 IN BOOK 92, PAGE 56 OF MAPS OF ASSESSMENT AND COMMUNITY FACILITIES DISTRICTS AS INSTRUMENT NO. 2024-001709 WHICH DESIGNATED THE TERRITORY SHOWN HEREIN AS TERRITORY FOR FUTURE ANNEXATION TO THE COMMUNITY FACILITIES DISTRICT REFERENCED THEREON.

FOR PARTICULARS OF THE LINES AND DIMENSIONS OF ASSESSOR PARCELS, REFERENCE IS MADE TO THE MAPS OF THE ASSESSOR, COUNTY OF RIVERSIDE, STATE OF CALIFORNIA. THE RIVERSIDE COUNTY ASSESSORS MAPS SHALL GOVERN FOR ALL DETAILS CONCERNING THE LINES AND DIMENSIONS OF SUCH LOTS OR PARCELS.

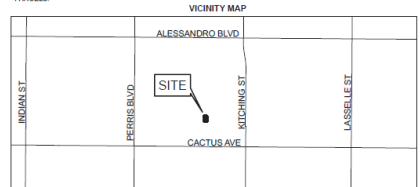

**AMENDMENT NO. 102 TO BOUNDARIES OF
COMMUNITY FACILITIES DISTRICT NO. 2023-01
(PUBLIC SAFETY SERVICES)**

CITY OF MORENO VALLEY
COUNTY OF RIVERSIDE
STATE OF CALIFORNIA

(THIS MAP AMENDS, BY ADDING THE ADDITIONAL TERRITORY SHOWN HEREON, THE BOUNDARY MAP FOR THE CITY OF MORENO VALLEY COMMUNITY FACILITIES DISTRICT NO. 2023-01 (PUBLIC SAFETY SERVICES), CITY OF MORENO VALLEY, RIVERSIDE COUNTY, STATE OF CALIFORNIA, PRIOR RECORDED AT BOOK 52 OF MAPS OF ASSESSMENT AND COMMUNITY FACILITIES DISTRICTS AT PAGE 18, IN THE OFFICE OF THE COUNTY RECORDER FOR THE COUNTY OF RIVERSIDE, STATE OF CALIFORNIA.)



FILED IN THE OFFICE OF THE CITY CLERK OF THE CITY OF MORENO VALLEY THIS _____ DAY OF _____, 202__.

CITY CLERK
CITY OF MORENO VALLEY
RIVERSIDE COUNTY, CALIFORNIA

I HEREBY CERTIFY THAT THE WITHIN MAP SHOWING THE PROPOSED BOUNDARIES OF COMMUNITY FACILITIES DISTRICT NO. 2023-01 (PUBLIC SAFETY SERVICES), CITY OF MORENO VALLEY, COUNTY OF RIVERSIDE, STATE OF CALIFORNIA, WAS APPROVED BY THE CITY COUNCIL OF THE CITY OF MORENO VALLEY, AT A REGULAR MEETING THEREOF, HELD ON THE _____ DAY OF _____, 202__ BY ITS RESOLUTION NO. _____.

CITY CLERK
CITY OF MORENO VALLEY
RIVERSIDE COUNTY, CALIFORNIA

FILED THIS _____ DAY OF _____, 202__, AT THE HOUR OF _____ O'CLOCK _____ M. IN BOOK _____ AT PAGE _____ OF MAPS OF ASSESSMENT AND COMMUNITY FACILITIES DISTRICTS AS INSTRUMENT NO. _____ IN THE OFFICE OF THE COUNTY RECORDER OF THE COUNTY OF RIVERSIDE, STATE OF CALIFORNIA.

ASSESSOR OR DESIGNEE
COUNTY CLERK AND RECORDER
COUNTY OF RIVERSIDE, CALIFORNIA

REFERENCE IS MADE TO THAT BOUNDARY MAP OF THE COMMUNITY FACILITIES DISTRICT NO. 2023-01 (PUBLIC SAFETY SERVICES) OF THE CITY OF MORENO VALLEY, COUNTY OF RIVERSIDE, STATE OF CALIFORNIA (TERRITORY PROPOSED FOR ANNEXATION IN THE FUTURE, WITH THE CONDITION THAT PARCELS WITHIN THE TERRITORY MAY BE ANNEXED ONLY WITH THE UNANIMOUS APPROVAL OF THE OWNER OR OWNERS OF EACH PARCEL OR PARCELS AT THE TIME THAT PARCELS OR THOSE PARCELS ARE ANNEXED) RECORDED WITH THE RIVERSIDE COUNTY RECORDER'S OFFICE ON JANUARY 19, 2024 IN BOOK 62, PAGE 56 OF MAPS OF ASSESSMENT AND COMMUNITY FACILITIES DISTRICTS AS INSTRUMENT NO. 2024-01704 WHICH DESIGNATED THE TERRITORY SHOWN HEREIN AS TERRITORY FOR FUTURE ANNEXATION TO THE COMMUNITY FACILITIES DISTRICT REFERENCED THEREON.

REFERENCE IS FURTHER MADE TO ANNEXATION MAP NO. 2 OF COMMUNITY FACILITIES DISTRICT NO. 2023-01 (PUBLIC SAFETY SERVICES), CITY OF MORENO VALLEY, COUNTY OF RIVERSIDE, STATE OF CALIFORNIA (TERRITORY PROPOSED FOR ANNEXATION IN THE FUTURE, WITH THE CONDITION THAT PARCELS WITHIN THE TERRITORY MAY BE ANNEXED ONLY WITH THE UNANIMOUS APPROVAL OF THE OWNER OR OWNERS OF EACH PARCEL OR PARCELS AT THE TIME THAT PARCELS OR THOSE PARCELS ARE ANNEXED) RECORDED WITH THE RIVERSIDE COUNTY RECORDER'S OFFICE ON JANUARY 19, 2024 IN BOOK 62, PAGE 56 OF MAPS OF ASSESSMENT AND COMMUNITY FACILITIES DISTRICTS AS INSTRUMENT NO. 2024-01704 WHICH DESIGNATED THE TERRITORY SHOWN HEREIN AS TERRITORY FOR FUTURE ANNEXATION TO THE COMMUNITY FACILITIES DISTRICT REFERENCED THEREON.

FOR PARTICULARS OF THE LINES AND DIMENSIONS OF ASSESSOR PARCELS, REFERENCE IS MADE TO THE MAPS OF THE ASSESSOR, COUNTY OF RIVERSIDE, STATE OF CALIFORNIA. THE RIVERSIDE COUNTY ASSESSOR'S MAPS SHALL GOVERN FOR ALL DETAILS CONCERNING THE LINES AND DIMENSIONS OF SUCH LOTS OR PARCELS.

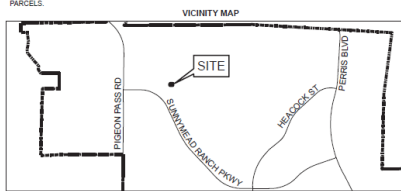

**AMENDMENT NO. 103 TO BOUNDARIES OF
COMMUNITY FACILITIES DISTRICT NO. 2023-01
(PUBLIC SAFETY SERVICES)**

SHEET 1 OF 1

CITY OF MORENO VALLEY
COUNTY OF RIVERSIDE
STATE OF CALIFORNIA

(THIS MAP AMENDS, BY ADDING THE ADDITIONAL TERRITORY SHOWN HEREON, THE BOUNDARY MAP FOR THE CITY OF MORENO VALLEY COMMUNITY FACILITIES DISTRICT NO. 2023-01 (PUBLIC SAFETY SERVICES), CITY OF MORENO VALLEY, RIVERSIDE COUNTY, STATE OF CALIFORNIA, PRIOR RECORDED AT BOOK 93 OF MAPS OF ASSESSMENT AND COMMUNITY FACILITIES DISTRICTS AT PAGE 18, IN THE OFFICE OF THE COUNTY RECORDER FOR THE COUNTY OF RIVERSIDE, STATE OF CALIFORNIA.)

FILED IN THE OFFICE OF THE CITY CLERK OF THE CITY OF MORENO VALLEY THIS _____ DAY OF _____, 202__.

CITY CLERK:
CITY OF MORENO VALLEY
RIVERSIDE COUNTY, CALIFORNIA

I HEREBY CERTIFY THAT THE WITHIN MAP SHOWING THE PROPOSED BOUNDARIES OF COMMUNITY FACILITIES DISTRICT NO. 2023-01 (PUBLIC SAFETY SERVICES), CITY OF MORENO VALLEY, COUNTY OF RIVERSIDE, STATE OF CALIFORNIA, WAS APPROVED BY THE CITY COUNCIL OF THE CITY OF MORENO VALLEY AT A REGULAR MEETING THEREOF, HELD ON THE _____ DAY OF _____, 202__ BY ITS RESOLUTION NO. _____.

CITY CLERK:
CITY OF MORENO VALLEY
RIVERSIDE COUNTY, CALIFORNIA

FILED THIS _____ DAY OF _____, 202__, AT THE HOUR OF _____ O'CLOCK _____ M. IN BOOK _____ AT PAGE _____ OF MAPS OF ASSESSMENT AND COMMUNITY FACILITIES DISTRICTS AS INSTRUMENT NO. _____ IN THE OFFICE OF THE COUNTY RECORDER OF THE COUNTY OF RIVERSIDE, STATE OF CALIFORNIA.

ASSESSOR OR DESIGNEE:
COUNTY CLERK AND RECORDER
COUNTY OF RIVERSIDE, CALIFORNIA

REFERENCE IS MADE TO THAT BOUNDARY MAP OF THE COMMUNITY FACILITIES DISTRICT NO. 2023-01 (PUBLIC SAFETY SERVICES) OF THE CITY OF MORENO VALLEY, RECORDED WITH THE RIVERSIDE COUNTY RECORDERS OFFICE ON OCTOBER 25, 2023 IN BOOK 92 OF MAPS OF ASSESSMENT AND COMMUNITY FACILITIES DISTRICTS, PAGE 18 AS INSTRUMENT NO. 2023-0315681.

REFERENCE IS FURTHER MADE TO ANNEXATION MAP NO. 2 OF COMMUNITY FACILITIES DISTRICT NO. 2023-01 (PUBLIC SAFETY SERVICES), CITY OF MORENO VALLEY, COUNTY OF RIVERSIDE, STATE OF CALIFORNIA (TERRITORY PROPOSED FOR ANNEXATION IN THE FUTURE, WITH THE CONDITION THAT PARCELS WITHIN THE TERRITORY MAY BE ANNEXED ONLY WITH THE UNANIMOUS APPROVAL OF THE OWNER OR OWNERS OF EACH PARCEL OR PARCELS AT THE TIME THAT PARCEL OR THOSE PARCELS ARE ANNEXED) RECORDED WITH THE RIVERSIDE COUNTY RECORDER'S OFFICE ON JANUARY 10, 2024 IN BOOK 92, PAGE 25 OF MAPS OF ASSESSMENT AND COMMUNITY FACILITIES DISTRICTS AS INSTRUMENT NO. 2024-0017004 WHICH DESIGNATED THE TERRITORY SHOWN HEREIN AS TERRITORY FOR FUTURE ANNEXATION TO THE COMMUNITY FACILITIES DISTRICT REFERENCED THEREON.

FOR PARTICULARS OF THE LINES AND DIMENSIONS OF ASSESSOR PARCELS, REFERENCE IS MADE TO THE MAPS OF THE ASSESSOR, COUNTY OF RIVERSIDE, STATE OF CALIFORNIA. THE RIVERSIDE COUNTY ASSESSORS MAPS SHALL GOVERN FOR ALL DETAILS CONCERNING THE LINES AND DIMENSIONS OF SUCH LOTS OR PARCELS.

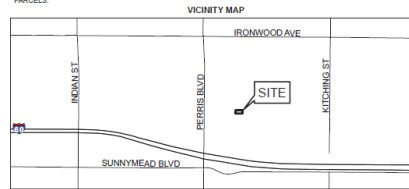

WILLDAN
27368 Via Industria, Suite 200
Brea, CA 92620
(951) 867-3020

**AMENDMENT NO. 104 TO BOUNDARIES OF
COMMUNITY FACILITIES DISTRICT NO. 2023-01
(PUBLIC SAFETY SERVICES)**

SHEET 1 OF 1

CITY OF MORENO VALLEY
COUNTY OF RIVERSIDE
STATE OF CALIFORNIA

(THIS MAP AMENDS, BY ADDING THE ADDITIONAL TERRITORY SHOWN HEREON, THE BOUNDARY MAP FOR THE CITY OF MORENO VALLEY COMMUNITY FACILITIES DISTRICT NO. 2023-01 (PUBLIC SAFETY SERVICES), CITY OF MORENO VALLEY, RIVERSIDE COUNTY, STATE OF CALIFORNIA, PRIOR RECORDED AT BOOK 32 OF MAPS OF ASSESSMENT AND COMMUNITY FACILITIES DISTRICTS AT PAGE 18, IN THE OFFICE OF THE COUNTY RECORDER FOR THE COUNTY OF RIVERSIDE, STATE OF CALIFORNIA.)

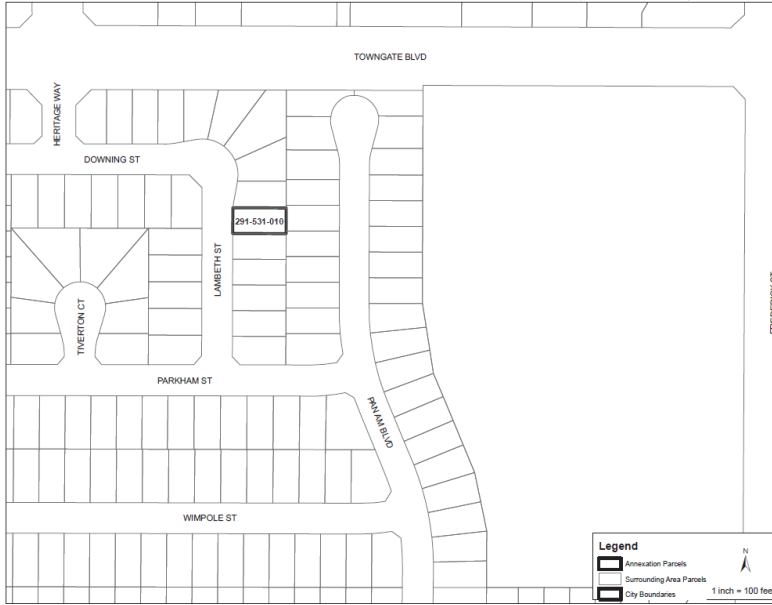

FILED IN THE OFFICE OF THE CITY CLERK OF THE CITY OF MORENO VALLEY THIS _____ DAY OF _____, 202__.

CITY CLERK
CITY OF MORENO VALLEY
RIVERSIDE COUNTY, CALIFORNIA

I HEREBY CERTIFY THAT THE WITHIN MAP SHOWING THE PROPOSED BOUNDARIES OF COMMUNITY FACILITIES DISTRICT NO. 2023-01 (PUBLIC SAFETY SERVICES), CITY OF MORENO VALLEY, COUNTY OF RIVERSIDE, STATE OF CALIFORNIA, WAS APPROVED BY THE CITY COUNCIL OF THE CITY OF MORENO VALLEY, AT A REGULAR MEETING THEREOF, HELD ON THE _____ DAY OF _____, 202__ BY ITS RESOLUTION NO. _____.

CITY CLERK
CITY OF MORENO VALLEY
RIVERSIDE COUNTY, CALIFORNIA

FILED THIS _____ DAY OF _____, 202__, AT THE HOUR OF _____ O'CLOCK _____ M. IN BOOK _____ AT PAGE _____ OF MAPS OF ASSESSMENT AND COMMUNITY FACILITIES DISTRICTS AS INSTRUMENT NO. _____ IN THE OFFICE OF THE COUNTY RECORDER OF THE COUNTY OF RIVERSIDE, STATE OF CALIFORNIA.

ASSESSOR OR DESIGNEE
COUNTY CLERK AND RECORDER
COUNTY OF RIVERSIDE, CALIFORNIA

REFERENCE IS MADE TO THAT BOUNDARY MAP OF THE COMMUNITY FACILITIES DISTRICT NO. 2023-01 (PUBLIC SAFETY SERVICES) OF THE CITY OF MORENO VALLEY, COUNTY OF RIVERSIDE, STATE OF CALIFORNIA OFFICE ON OCTOBER 25, 2023 IN BOOK 82 OF MAPS OF ASSESSMENT AND COMMUNITY FACILITIES DISTRICTS, PAGE 18 AS INSTRUMENT NO. 2023-0315851.

REFERENCE IS FURTHER MADE TO ANNEXATION MAP NO. 2 OF COMMUNITY FACILITIES DISTRICT NO. 2023-01 (PUBLIC SAFETY SERVICES), CITY OF MORENO VALLEY, COUNTY OF RIVERSIDE, STATE OF CALIFORNIA (TERRITORY PROPOSED FOR ANNEXATION IN THE FUTURE, WITH THE CONDITION THAT PARCELS WITHIN THE TERRITORY MAY BE ANNEXED ONLY WITH THE UNANIMOUS APPROVAL OF THE OWNER OR OWNERS OF EACH PARCEL OR PARCELS AT THE TIME THAT PARCEL OR THOSE PARCELS ARE ANNEXED) RECORDED WITH THE RIVERSIDE COUNTY RECORDER'S OFFICE ON JANUARY 19, 2024 IN BOOK 102 AS ONE OF MAPS OF ASSESSMENT AND COMMUNITY FACILITIES DISTRICTS AS INSTRUMENT NO. 2024-001794 WHICH DESIGNATED THE TERRITORY SHOWN HEREON AS TERRITORY FOR FUTURE ANNEXATION TO THE COMMUNITY FACILITIES DISTRICT REFERENCED THEREON.

FOR PARTICULARS OF THE LINES AND DIMENSIONS OF ASSESSOR PARCELS, REFERENCE IS MADE TO THE MAPS OF THE ASSESSOR, COUNTY OF RIVERSIDE, STATE OF CALIFORNIA. THE RIVERSIDE COUNTY ASSESSOR'S MAPS SHALL GOVERN FOR ALL DETAILS CONCERNING THE LINES AND DIMENSIONS OF SUCH LOTS OR PARCELS.

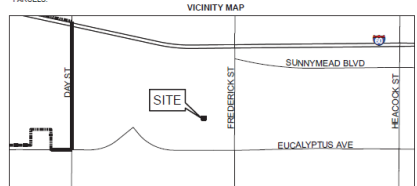

WILLDAN
27383 Via Industrial, Suite 200
Menlo Park, CA 94029
(651) 667-2020

**AMENDMENT NO. 107 TO BOUNDARIES OF
COMMUNITY FACILITIES DISTRICT NO. 2023-01
(PUBLIC SAFETY SERVICES)**

CITY OF MORENO VALLEY
COUNTY OF RIVERSIDE
STATE OF CALIFORNIA

(THIS MAP AMENDS, BY ADDING THE ADDITIONAL TERRITORY SHOWN HEREON, THE BOUNDARY MAP FOR THE CITY OF MORENO VALLEY COMMUNITY FACILITIES DISTRICT NO. 2023-01 (PUBLIC SAFETY SERVICES), CITY OF MORENO VALLEY, RIVERSIDE COUNTY, STATE OF CALIFORNIA, PRIOR RECORDED AT BOOK 50 OF MAPS OF ASSESSMENT AND COMMUNITY FACILITIES DISTRICTS AT PAGE 18, IN THE OFFICE OF THE COUNTY RECORDER FOR THE COUNTY OF RIVERSIDE, STATE OF CALIFORNIA.)

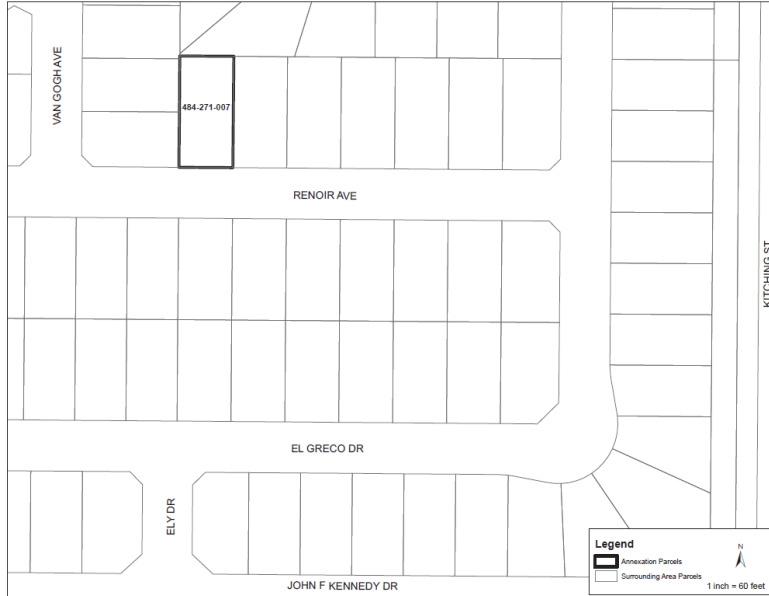

FILED IN THE OFFICE OF THE CITY CLERK OF THE CITY OF MORENO VALLEY THIS _____ DAY OF _____, 202__.

CITY CLERK
CITY OF MORENO VALLEY
RIVERSIDE COUNTY, CALIFORNIA

I HEREBY CERTIFY THAT THE WITHIN MAP SHOWING THE PROPOSED BOUNDARIES OF COMMUNITY FACILITIES DISTRICT NO. 2023-01 (PUBLIC SAFETY SERVICES), CITY OF MORENO VALLEY, COUNTY OF RIVERSIDE, STATE OF CALIFORNIA, WAS APPROVED BY THE CITY COUNCIL OF THE CITY OF MORENO VALLEY, AT A REGULAR MEETING THEREOF, HELD ON THE _____ DAY OF _____, 202__, BY ITS RESOLUTION NO. _____.

CITY CLERK
CITY OF MORENO VALLEY
RIVERSIDE COUNTY, CALIFORNIA

FILED THIS _____ DAY OF _____, 202__, AT THE HOUR OF _____ O'CLOCK _____ M. IN BOOK _____ AT PAGE _____ OF MAPS OF ASSESSMENT AND COMMUNITY FACILITIES DISTRICTS AS INSTRUMENT NO. _____ IN THE OFFICE OF THE COUNTY RECORDER OF THE COUNTY OF RIVERSIDE, STATE OF CALIFORNIA.

ASSESSOR OR DESIGNEE
COUNTY CLERK AND RECORDER
COUNTY OF RIVERSIDE, CALIFORNIA

REFERENCE IS MADE TO THAT BOUNDARY MAP OF THE COMMUNITY FACILITIES DISTRICT NO. 2023-01 (PUBLIC SAFETY SERVICES) OF THE CITY OF MORENO VALLEY, RECORDED WITH THE RIVERSIDE COUNTY RECORDERS OFFICE ON OCTOBER 25, 2023 IN BOOK 62 OF MAPS OF ASSESSMENT AND COMMUNITY FACILITIES DISTRICTS, PAGE 18 AS INSTRUMENT NO. 2023-015681.

REFERENCE IS FURTHER MADE TO ANNEXATION MAP NO. 2 OF COMMUNITY FACILITIES DISTRICT NO. 2023-01 (PUBLIC SAFETY SERVICES), CITY OF MORENO VALLEY, COUNTY OF RIVERSIDE, STATE OF CALIFORNIA (TERRITORY PROPOSED FOR ANNEXATION IN THE FUTURE WITH THE CONDITION THAT PARCELS WITHIN THE TERRITORY MAY BE ANNEXED ONLY WITH THE UNANIMOUS APPROVAL OF THE OWNER OR OWNERS OF EACH PARCEL OR PARCELS AT THE TIME THAT PARCEL OR THOSE PARCELS ARE ANNEXED) RECORDED WITH THE RIVERSIDE COUNTY RECORDER'S OFFICE ON JANUARY 19, 2024 IN BOOK 62, PAGE 55 OF MAPS OF ASSESSMENT AND COMMUNITY FACILITIES DISTRICTS AS INSTRUMENT NO. 2024-01704 WHICH DESIGNATED THE TERRITORY SHOWN HEREIN AS TERRITORY FOR FUTURE ANNEXATION TO THE COMMUNITY FACILITIES DISTRICT REFERENCED THEREON.

FOR PARTICULARS OF THE LINES AND DIMENSIONS OF ASSESSOR PARCELS, REFERENCE IS MADE TO THE MAPS OF THE ASSESSOR, COUNTY OF RIVERSIDE, STATE OF CALIFORNIA. THE RIVERSIDE COUNTY ASSESSOR'S MAPS SHALL GOVERN FOR ALL DETAILS CONCERNING THE LINES AND DIMENSIONS OF SUCH LOTS OR PARCELS.

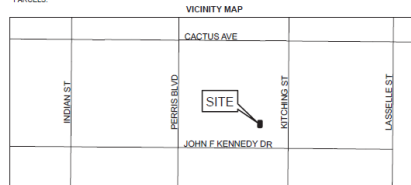

**AMENDMENT NO. 108 TO BOUNDARIES OF
COMMUNITY FACILITIES DISTRICT NO. 2023-01
(PUBLIC SAFETY SERVICES)**

CITY OF MORENO VALLEY
COUNTY OF RIVERSIDE
STATE OF CALIFORNIA

(THIS MAP AMENDS, BY ADDING THE ADDITIONAL TERRITORY SHOWN HEREON, THE BOUNDARY MAP FOR THE CITY OF MORENO VALLEY COMMUNITY FACILITIES DISTRICT NO. 2023-01 (PUBLIC SAFETY SERVICES), CITY OF MORENO VALLEY, RIVERSIDE COUNTY, STATE OF CALIFORNIA, PRIOR RECORDED AT BOOK 52 OF MAPS OF ASSESSMENT AND COMMUNITY FACILITIES DISTRICTS AT PAGE 18, IN THE OFFICE OF THE COUNTY RECORDER FOR THE COUNTY OF RIVERSIDE, STATE OF CALIFORNIA.)



Legend

- Annexation Parcels
- Surrounding Area Parcels
- City Boundaries

N
1 inch = 150 feet

FILED IN THE OFFICE OF THE CITY CLERK OF THE CITY OF MORENO VALLEY THIS ____ DAY OF _____, 202__.

CITY CLERK
CITY OF MORENO VALLEY
RIVERSIDE COUNTY, CALIFORNIA

I HEREBY CERTIFY THAT THE WITHIN MAP SHOWING THE PROPOSED BOUNDARIES OF COMMUNITY FACILITIES DISTRICT NO. 2023-01 (PUBLIC SAFETY SERVICES), CITY OF MORENO VALLEY, COUNTY OF RIVERSIDE, STATE OF CALIFORNIA, WAS APPROVED BY THE CITY COUNCIL OF THE CITY OF MORENO VALLEY, AT A REGULAR MEETING THEREOF, HELD ON THE ____ DAY OF _____, 202__ BY ITS RESOLUTION NO. _____.

CITY CLERK
CITY OF MORENO VALLEY
RIVERSIDE COUNTY, CALIFORNIA

FILED THIS ____ DAY OF _____, 202__, AT THE HOUR OF ____ O'CLOCK ____ M. IN BOOK ____ AT PAGE ____ OF MAPS OF ASSESSMENT AND COMMUNITY FACILITIES DISTRICTS AS INSTRUMENT NO. _____ IN THE OFFICE OF THE COUNTY RECORDER OF THE COUNTY OF RIVERSIDE, STATE OF CALIFORNIA.

ASSESSOR OR DESIGNEE
COUNTY CLERK AND RECORDER
COUNTY OF RIVERSIDE, CALIFORNIA

REFERENCE IS MADE TO THAT BOUNDARY MAP OF THE COMMUNITY FACILITIES DISTRICT NO. 2023-01 (PUBLIC SAFETY SERVICES) OF THE CITY OF MORENO VALLEY, RECORDED WITH THE RIVERSIDE COUNTY RECORDERS OFFICE ON OCTOBER 25, 2023 IN BOOK 52 OF MAPS OF ASSESSMENT AND COMMUNITY FACILITIES DISTRICTS, PAGE 18 AS INSTRUMENT NO. 2023-0110681.

REFERENCE IS FURTHER MADE TO ANNEXATION MAP NO. 2 OF COMMUNITY FACILITIES DISTRICT NO. 2023-01 (PUBLIC SAFETY SERVICES), CITY OF MORENO VALLEY, COUNTY OF RIVERSIDE, STATE OF CALIFORNIA (TERRITORY PROPOSED FOR ANNEXATION IN THE FUTURE, WITH THE CONDITION THAT PARCELS WITHIN THE TERRITORY MAY BE ANNEXED ONLY WITH THE UNANIMOUS APPROVAL OF THE OWNER OR OWNERS OF EACH PARCEL OR PARCELS AT THE TIME THAT PARCEL OR THOSE PARCELS ARE ANNEXED) RECORDED WITH THE RIVERSIDE COUNTY RECORDER'S OFFICE ON JANUARY 19, 2024 IN BOOK 92, PAGE 56 OF MAPS OF ASSESSMENT AND COMMUNITY FACILITIES DISTRICTS AS INSTRUMENT NO. 2024-01704 WHICH DESIGNATED THE TERRITORY SHOWN HEREIN AS TERRITORY FOR FUTURE ANNEXATION TO THE COMMUNITY FACILITIES DISTRICT REFERENCED THEREON.

FOR PARTICULARS OF THE LINES AND DIMENSIONS OF ASSESSOR PARCELS, REFERENCE IS MADE TO THE MAPS OF THE ASSESSOR, COUNTY OF RIVERSIDE, STATE OF CALIFORNIA. THE RIVERSIDE COUNTY ASSESSOR'S MAPS SHALL GOVERN FOR ALL DETAILS CONCERNING THE LINES AND DIMENSIONS OF SUCH LOTS OR PARCELS.

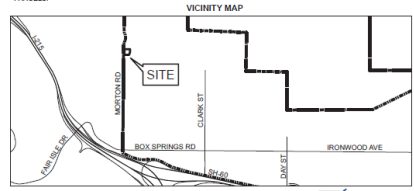

**AMENDMENT NO. 109 TO BOUNDARIES OF
COMMUNITY FACILITIES DISTRICT NO. 2023-01
(PUBLIC SAFETY SERVICES)**

CITY OF MORENO VALLEY
COUNTY OF RIVERSIDE
STATE OF CALIFORNIA

(THIS MAP AMENDS, BY ADDING THE ADDITIONAL TERRITORY SHOWN HEREON, THE BOUNDARY MAP FOR THE CITY OF MORENO VALLEY COMMUNITY FACILITIES DISTRICT NO. 2023-01 (PUBLIC SAFETY SERVICES), CITY OF MORENO VALLEY, RIVERSIDE COUNTY, STATE OF CALIFORNIA, PRIOR RECORDED AT BOOK 92 OF MAPS OF ASSESSMENT AND COMMUNITY FACILITIES DISTRICTS AT PAGE 18, IN THE OFFICE OF THE COUNTY RECORDER FOR THE COUNTY OF RIVERSIDE, STATE OF CALIFORNIA.)

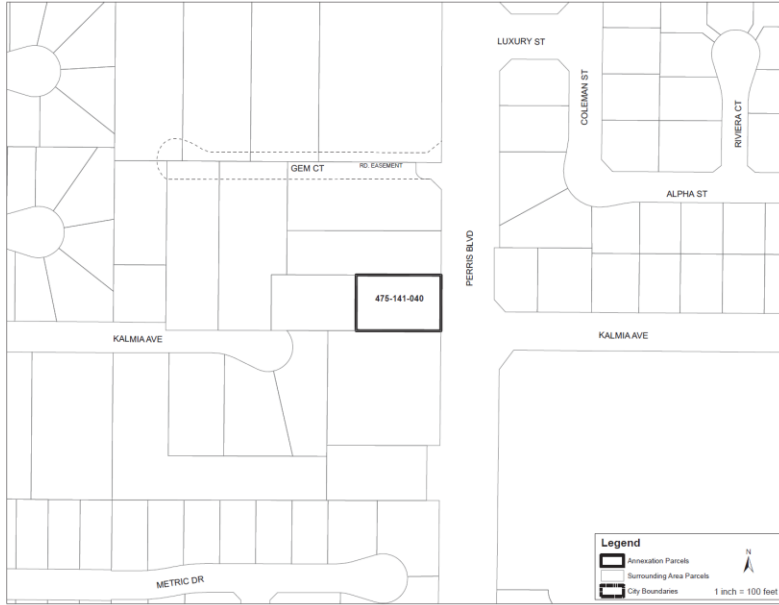

FILED IN THE OFFICE OF THE CITY CLERK OF THE CITY OF MORENO VALLEY THIS _____ DAY OF _____, 202__.

CITY CLERK
CITY OF MORENO VALLEY
RIVERSIDE COUNTY, CALIFORNIA

I HEREBY CERTIFY THAT THE WITHIN MAP SHOWING THE PROPOSED BOUNDARIES OF COMMUNITY FACILITIES DISTRICT NO. 2023-01 (PUBLIC SAFETY SERVICES), CITY OF MORENO VALLEY, COUNTY OF RIVERSIDE, STATE OF CALIFORNIA, WAS APPROVED BY THE CITY COUNCIL OF THE CITY OF MORENO VALLEY, AT A REGULAR MEETING THEREOF, HELD ON THE _____ DAY OF _____, 202__ BY ITS RESOLUTION NO. _____.

CITY CLERK
CITY OF MORENO VALLEY
RIVERSIDE COUNTY, CALIFORNIA

FILED THIS _____ DAY OF _____, 202__ AT THE HOUR OF _____ O'CLOCK _____ M. IN BOOK _____ AT PAGE _____ OF MAPS OF ASSESSMENT AND COMMUNITY FACILITIES DISTRICTS AS INSTRUMENT NO. _____ IN THE OFFICE OF THE COUNTY RECORDER OF THE COUNTY OF RIVERSIDE, STATE OF CALIFORNIA.

ASSESSOR OR DESIGNEE
COUNTY CLERK AND RECORDER
COUNTY OF RIVERSIDE, CALIFORNIA

REFERENCE IS MADE TO THAT BOUNDARY MAP OF THE COMMUNITY FACILITIES DISTRICT NO. 2023-01 (PUBLIC SAFETY SERVICES) OF THE CITY OF MORENO VALLEY, RECORDED WITH THE RIVERSIDE COUNTY RECORDERS OFFICE ON OCTOBER 26, 2023 IN BOOK 92 OF MAPS OF ASSESSMENT AND COMMUNITY FACILITIES DISTRICTS, PAGE 18 AS INSTRUMENT NO. 2023-0315681.

REFERENCE IS FURTHER MADE TO ANNEXATION MAP NO. 2 OF COMMUNITY FACILITIES DISTRICT NO. 2023-01 (PUBLIC SAFETY SERVICES), CITY OF MORENO VALLEY, COUNTY OF RIVERSIDE, STATE OF CALIFORNIA (TERRITORY PROPOSED FOR ANNEXATION IN THE FUTURE, WITH THE CONDITION THAT PARCELS WITHIN THE TERRITORY MAY BE ANNEXED ONLY WITH THE UNANIMOUS APPROVAL OF THE OWNER OR OWNERS OF EACH PARCEL OR PARCELS AT THE TIME THAT PARCEL OR THOSE PARCELS ARE ANNEXED RECORDED WITH THE RIVERSIDE COUNTY RECORDER'S OFFICE ON JANUARY 19, 2024 IN BOOK 92, PAGE 55 OF MAPS OF ASSESSMENT AND COMMUNITY FACILITIES DISTRICTS AS INSTRUMENT NO. 2024-001768 WHICH DESIGNATED THE TERRITORY SHOWN HEREIN AS TERRITORY FOR FUTURE ANNEXATION TO THE COMMUNITY FACILITIES DISTRICT REFERENCED THEREON.

FOR PARTICULARS OF THE LINES AND DIMENSIONS OF ASSESSOR PARCELS, REFERENCE IS MADE TO THE MAPS OF THE ASSESSOR, COUNTY OF RIVERSIDE, STATE OF CALIFORNIA. THE RIVERSIDE COUNTY ASSESSORS MAPS SHALL GOVERN FOR ALL DETAILS CONCERNING THE LINES AND DIMENSIONS OF SUCH LOTS OR PARCELS.

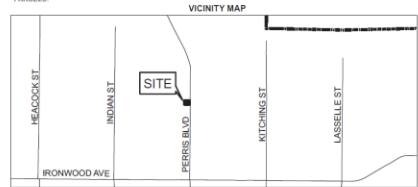

WILLDAN
27303 Via Inductra, Suite 200
Temecula, CA 92590
(951) 987-2000

**AMENDMENT NO. 112 TO BOUNDARIES OF
COMMUNITY FACILITIES DISTRICT NO. 2023-01
(PUBLIC SAFETY SERVICES)**

CITY OF MORENO VALLEY
COUNTY OF RIVERSIDE
STATE OF CALIFORNIA

(THIS MAP AMENDS, BY ADDING THE ADDITIONAL TERRITORY SHOWN HEREON, THE BOUNDARY MAP FOR THE CITY OF MORENO VALLEY COMMUNITY FACILITIES DISTRICT NO. 2023-01 (PUBLIC SAFETY SERVICES), CITY OF MORENO VALLEY, RIVERSIDE COUNTY, STATE OF CALIFORNIA, PRIOR RECORDED AT BOOK 92 OF MAPS OF ASSESSMENT AND COMMUNITY FACILITIES DISTRICTS AT PAGE 18, IN THE OFFICE OF THE COUNTY RECORDER FOR THE COUNTY OF RIVERSIDE, STATE OF CALIFORNIA.)



FILED IN THE OFFICE OF THE CITY CLERK OF THE CITY OF MORENO VALLEY THIS _____ DAY OF _____, 202__.

CITY CLERK
CITY OF MORENO VALLEY
RIVERSIDE COUNTY, CALIFORNIA

I HEREBY CERTIFY THAT THE WITHIN MAP SHOWING THE PROPOSED BOUNDARIES OF COMMUNITY FACILITIES DISTRICT NO. 2023-01 (PUBLIC SAFETY SERVICES), CITY OF MORENO VALLEY, COUNTY OF RIVERSIDE, STATE OF CALIFORNIA, WAS APPROVED BY THE CITY COUNCIL OF THE CITY OF MORENO VALLEY, AT A REGULAR MEETING THEREOF, HELD ON THE _____ DAY OF _____, 202__ BY ITS RESOLUTION NO. _____.

CITY CLERK
CITY OF MORENO VALLEY
RIVERSIDE COUNTY, CALIFORNIA

FILED THIS _____ DAY OF _____, 202__ AT THE HOUR OF _____ O'CLOCK _____ M. IN BOOK _____ AT PAGE _____ OF MAPS OF ASSESSMENT AND COMMUNITY FACILITIES DISTRICTS AS INSTRUMENT NO. _____ IN THE OFFICE OF THE COUNTY RECORDER OF THE COUNTY OF RIVERSIDE, STATE OF CALIFORNIA.

ASSESSOR OR DESIGNEE
COUNTY CLERK AND RECORDER
COUNTY OF RIVERSIDE, CALIFORNIA

REFERENCE IS MADE TO THAT BOUNDARY MAP OF THE COMMUNITY FACILITIES DISTRICT NO. 2023-01 (PUBLIC SAFETY SERVICES) OF THE CITY OF MORENO VALLEY, COUNTY OF RIVERSIDE, STATE OF CALIFORNIA, RECORDED WITH THE RIVERSIDE COUNTY RECORDERS OFFICE ON OCTOBER 26, 2023 IN BOOK 92 OF MAPS OF ASSESSMENT AND COMMUNITY FACILITIES DISTRICTS, PAGE 18 AS INSTRUMENT NO. 2023-0315681.

REFERENCE IS FURTHER MADE TO ANNEXATION MAP NO. 3 OF COMMUNITY FACILITIES DISTRICT NO. 2023-01 (PUBLIC SAFETY SERVICES), CITY OF MORENO VALLEY, COUNTY OF RIVERSIDE, STATE OF CALIFORNIA (TERRITORY PROPOSED FOR ANNEXATION IN THE FUTURE, WITH THE CONDITION THAT PARCELS WITHIN THE TERRITORY MAY BE ANNEXED ONLY WITH THE UNANIMOUS APPROVAL OF THE OWNER OR OWNERS OF EACH PARCEL OR PARCELS AT THE TIME THAT PARCEL OR THOSE PARCELS ARE ANNEXED) RECORDED WITH THE RIVERSIDE COUNTY RECORDER'S OFFICE ON JANUARY 19, 2024 IN BOOK 92, PAGE 56 OF MAPS OF ASSESSMENT AND COMMUNITY FACILITIES DISTRICTS AS INSTRUMENT NO. 2024-001798 WHICH DESIGNATED THE TERRITORY SHOWN HEREIN AS TERRITORY FOR FUTURE ANNEXATION TO THE COMMUNITY FACILITIES DISTRICT REFERENCED THEREON.

FOR PARTICULARS OF THE LINES AND DIMENSIONS OF ASSESSOR PARCELS, REFERENCE IS MADE TO THE MAPS OF THE ASSESSOR, COUNTY OF RIVERSIDE, STATE OF CALIFORNIA. THE RIVERSIDE COUNTY ASSESSORS MAPS SHALL GOVERN FOR ALL DETAILS CONCERNING THE LINES AND DIMENSIONS OF SUCH LOTS OR PARCELS.

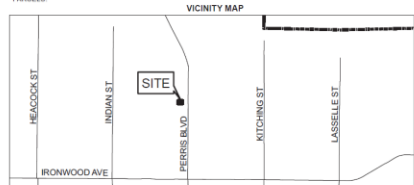

WILLDAN
2750 Via Industria, Suite 200
Temecula, CA 92590
(951) 547-3000