

RESOLUTION NO. CSD 2025-____

A RESOLUTION OF THE BOARD FOR THE MORENO VALLEY COMMUNITY SERVICES DISTRICT OF THE CITY OF MORENO VALLEY, CALIFORNIA, ORDERING THE ANNEXATION OF TERRITORY TO MORENO VALLEY COMMUNITY SERVICES DISTRICT COMMUNITY FACILITIES DISTRICT NO. 2021-01 (PARKS MAINTENANCE) AND APPROVING AMENDED MAP(S) FOR SAID DISTRICT

WHEREAS, by its Resolution No. CSD 2021-22, Board established the Moreno Valley Community Services District Community Facilities District No. 2021-01 (Parks Maintenance) (the “CFD”), pursuant to the Mello-Roos Community Facilities Act of 1982 (Government Code Section 53311 *et seq.*) (the “Act”); and

WHEREAS, by its Ordinance No. CSD 55, the Board authorized an annual special tax to be levied against all non-exempt parcels of real property within the CFD (the “Special Tax”) to fund parks maintenance services; and

WHEREAS, in order to permit landowners to efficiently annex developing parcels to the CFD, the Board, by its Ordinance No. CSD 56 designated the entire territory of the City of Moreno Valley as a future annexation area for the CFD; and

WHEREAS, the landowner(s) of the Parcel(s) listed on Exhibit A to this Resolution, which is attached hereto and incorporated herein by reference, have submitted to the District (a) petition(s) requesting and approving annexation of the listed “Annexation Parcel(s)” to the CFD; and

WHEREAS, the Annexation Parcel(s) are comprised of the territory shown on the boundary map(s) (the “Boundary Map(s)”) entitled “Amendment Numbers: 222, 234, 235, 236, 237, 239, 240, 241, 242, and 245 to Boundaries of Community Facilities District No. 2021-01 (Parks Maintenance), Moreno Valley Community Services District, City of Moreno Valley, County of Riverside, California” which are set forth in Exhibit B to this Resolution, attached hereto and incorporated herein by this reference; and

WHEREAS, the Board desires to annex the Annexation Parcel(s) to the CFD.

NOW, THEREFORE, THE BOARD FOR THE MORENO VALLEY COMMUNITY SERVICES DISTRICT OF THE CITY OF MORENO VALLEY, CALIFORNIA, DOES HEREBY RESOLVE AS FOLLOWS:

1. Recitals. The above recitals are all true and correct and are herein incorporated.
2. Annexation(s) Approved. The Annexation Parcel(s) are hereby added to and part of the CFD with full legal effect and are subject to the Special Tax.
3. Description of Services. The following is a general description of the services

(the “Services”) provided in the CFD:

Maintaining, lighting, and operating parks and park improvements that are owned and operated by the CSD, to the extent such services are in addition to services already provided at the time CFD No. 2021-01 was created and do not supplant existing services.

Fundable services include (i) planting, replanting, mowing, trimming, irrigation and fertilization of grass, trees, shrubs, and other plants and vegetation, (ii) the operation, maintenance, repair, and replacement of irrigation systems and lighting systems, and (iii) the operation maintenance, repair and replacement of any real property or improvements with a useful life of more than five years.

Fundable costs include, but are not limited to: (i) contracted costs for such services, (ii) salaries and benefits of staff, including park rangers, devoted to such services, (iii) expenses related to equipment, apparatus, and supplies related to these services, (iv) administrative and overhead costs, including staff time, associated with providing such services, and (v) lifecycle costs associated with the repair and replacement of facilities and improvements.

4. Amended Boundary Map(s). The Boundary Map(s) attached hereto as Exhibit B are hereby approved. This map amends, and does not supersede, the existing maps of the CFD. The Board directs that said map(s) be filed with the Riverside County Recorder pursuant to Section 3113 of the Streets and Highways Code.

5. Notice of Special Tax Lien(s). The Board directs that an amended notice of special tax lien be recorded pursuant to Section 3117.5 of the Streets and Highways Code with respect to the Annexation Parcel(s) associated with the Boundary Map(s).

6. This Resolution shall be effective immediately upon adoption.

7. The Secretary shall certify to the adoption of this Resolution and shall maintain it on file as a public record this Resolution.

8. Severability. The Board declares that, should any provision, section, paragraph, sentence or word of this Resolution be rendered or declared invalid by any final court action in a court of competent jurisdiction or by reason of any preemptive legislation, the remaining provisions, sections, paragraphs, sentences or words of this Resolution as hereby adopted shall remain in full force and effect.

APPROVED AND ADOPTED this 1st day of April 2025.

Mayor of the City of Moreno Valley,
acting in the capacity as President of the
Board for the Moreno Valley Community
Services District

ATTEST:

City Clerk of the City of Moreno Valley,
acting in the capacity of Secretary of
the Moreno Valley Community
Services District

APPROVED AS TO FORM:

City Attorney of the City of Moreno Valley,
acting in the capacity of General Counsel
of the Moreno Valley Community Services District

RESOLUTION JURAT

STATE OF CALIFORNIA)

COUNTY OF RIVERSIDE) ss.

CITY OF MORENO VALLEY)

I, M. Patricia Rodriguez, Secretary of the Moreno Valley Community Services District, Moreno Valley, California do hereby certify that Resolution No. CSD 2025-____ was duly and regularly adopted by the Board of Directors for the Moreno Valley Community Services District at a regular meeting held on the 1st day of April 2025, by the following vote:

AYES:

NOES:

ABSENT:

ABSTAIN:

(Boardmembers, Vice-President and President)

SECRETARY

(SEAL)

EXHIBIT A

List of Annexation Parcel(s)

Amendment Map Nos.	Assessor's Parcel Numbers
222	474-170-001
234	486-240-008, 486-240-018
235	478-165-022
236	292-272-009
237	292-241-003
239	487-111-026
240	482-020-004
241	486-240-017
242	479-282-003
245	482-060-006

EXHIBIT B

AMENDMENT NO. 222 TO BOUNDARIES OF MORENO VALLEY COMMUNITY SERVICES DISTRICT COMMUNITY FACILITIES DISTRICT NO. 2021-01 (PARKS MAINTENANCE)

SHEET 1 OF 1

**MORENO VALLEY COMMUNITY SERVICES DISTRICT
CITY OF MORENO VALLEY
COUNTY OF RIVERSIDE
STATE OF CALIFORNIA**

(THIS MAP AMENDS, BY ADDING THE ADDITIONAL TERRITORY SHOWN HEREON, THE BOUNDARY MAP FOR MORENO VALLEY COMMUNITY SERVICES DISTRICT COMMUNITY FACILITIES DISTRICT NO. 2021-01 (PARKS MAINTENANCE), CITY OF MORENO VALLEY, RIVERSIDE COUNTY, STATE OF CALIFORNIA, PRIOR RECORDED AT BOOK 89 OF MAPS OF ASSESSMENT AND COMMUNITY FACILITIES DISTRICTS AT PAGE 95, IN THE OFFICE OF THE COUNTY RECORDER FOR THE COUNTY OF RIVERSIDE, STATE OF CALIFORNIA.)

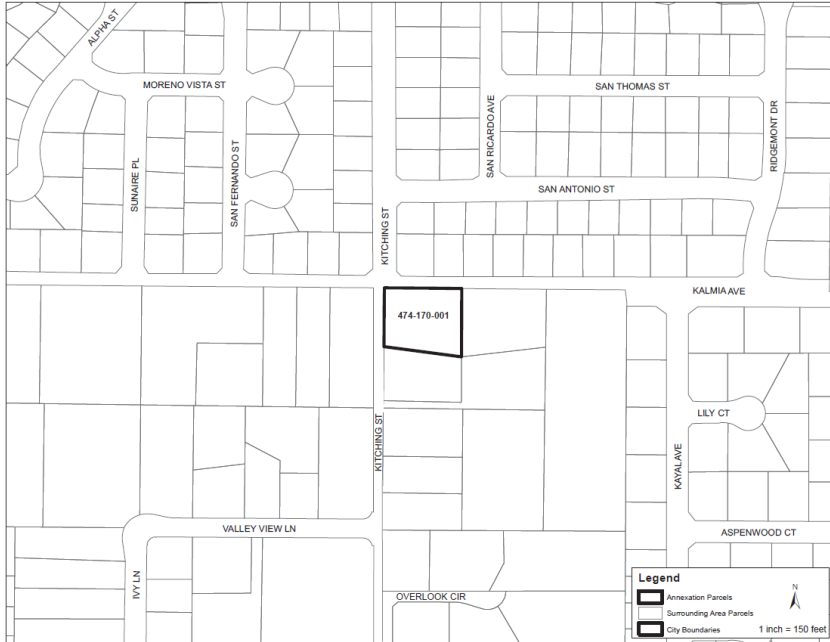

FILED IN THE OFFICE OF THE CITY CLERK OF THE CITY OF MORENO VALLEY THIS _____ DAY OF _____, 20__.

CITY CLERK OF THE CITY OF MORENO VALLEY, ACTING IN THE CAPACITY OF THE SECRETARY OF THE MORENO VALLEY COMMUNITY SERVICES DISTRICT

I HEREBY CERTIFY THAT THE WITHIN MAP SHOWING AMENDED BOUNDARIES OF COMMUNITY FACILITIES DISTRICT NO. 2021-01 (PARKS MAINTENANCE) OF THE MORENO VALLEY COMMUNITY SERVICES DISTRICT, CITY OF MORENO VALLEY, COUNTY OF RIVERSIDE, STATE OF CALIFORNIA, WAS APPROVED BY THE BOARD OF DIRECTORS OF THE MORENO VALLEY COMMUNITY SERVICES DISTRICT AT A REGULAR MEETING THEREOF, HELD ON THE _____ DAY OF _____, 20__ BY ITS RESOLUTION NO. _____.

CITY CLERK OF THE CITY OF MORENO VALLEY, ACTING IN THE CAPACITY OF THE SECRETARY OF THE MORENO VALLEY COMMUNITY SERVICES DISTRICT

FILED THIS _____ DAY OF _____, 20__ AT THE HOUR OF _____ O'CLOCK _____ M. IN THE BOOK _____ PAGE(S) _____ OF MAPS OF ASSESSMENT AND COMMUNITY FACILITIES DISTRICTS AS INSTRUMENT NO. _____ IN THE OFFICE OF THE COUNTY RECORDER OF THE COUNTY OF RIVERSIDE, STATE OF CALIFORNIA.

COUNTY RECORDER
COUNTY OF RIVERSIDE
STATE OF CALIFORNIA

REFERENCE IS MADE TO THAT BOUNDARY MAP OF THE COMMUNITY FACILITIES DISTRICT NO. 2021-01 (PARKS MAINTENANCE) OF THE MORENO VALLEY COMMUNITY SERVICES DISTRICT, CITY OF MORENO VALLEY, COUNTY OF RIVERSIDE, STATE OF CALIFORNIA, RECORDED WITH THE RIVERSIDE COUNTY RECORDERS OFFICE ON MAY 4, 2021 IN BOOK 89 OF MAPS OF ASSESSMENT AND COMMUNITY FACILITIES DISTRICTS, PAGE 95 AS INSTRUMENT NO. 2021-026004.

REFERENCE IS FURTHER MADE TO ANNEXATION MAP NO. 4 OF COMMUNITY FACILITIES DISTRICT NO. 2021-01 (PARKS MAINTENANCE) OF THE MORENO VALLEY COMMUNITY SERVICES DISTRICT, CITY OF MORENO VALLEY, COUNTY OF RIVERSIDE, STATE OF CALIFORNIA (TERRITORY PROPOSED FOR ANNEXATION IN THE FUTURE, WITH THE CONDITION THAT PARCELS WITHIN THE TERRITORY MAY BE ANNEXED ONLY WITH THE UNANIMOUS APPROVAL OF THE OWNER OR OWNERS OF EACH PARCEL OR PARCELS AT THE TIME THAT PARCEL OR THOSE PARCELS ARE ANNEXED) RECORDED WITH THE RIVERSIDE COUNTY RECORDERS OFFICE ON OCTOBER 27, 2021 IN BOOK 87, PAGE 81 OF MAPS OF ASSESSMENT AND COMMUNITY FACILITIES DISTRICTS AS INSTRUMENT NO. 2021-059748 WHICH DESIGNATED THE TERRITORY SHOWN HEREIN AS TERRITORY FOR FUTURE ANNEXATION TO THE COMMUNITY FACILITIES DISTRICT REFERENCED THEREON.

FOR PARTICULARS OF THE LINES AND DIMENSIONS OF ASSESSOR PARCELS, REFERENCE IS MADE TO THE MAPS OF THE ASSESSOR, COUNTY OF RIVERSIDE, STATE OF CALIFORNIA, THE RIVERSIDE COUNTY ASSESSORS MAPS SHALL GOVERN FOR ALL DETAILS CONCERNING THE LINES AND DIMENSIONS OF SUCH LOTS OR PARCELS.

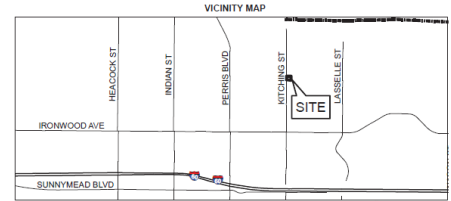

WILLDAN
2736 Via Invereta, Suite 200
Temecula, CA 92590
(951) 937-2020

**AMENDMENT NO. 234 TO BOUNDARIES OF MORENO VALLEY COMMUNITY SERVICES DISTRICT
COMMUNITY FACILITIES DISTRICT NO. 2021-01
(PARKS MAINTENANCE)**

**MORENO VALLEY COMMUNITY SERVICES DISTRICT
CITY OF MORENO VALLEY
COUNTY OF RIVERSIDE
STATE OF CALIFORNIA**

(THIS MAP AMENDS, BY ADDING THE ADDITIONAL TERRITORY SHOWN HEREON, THE BOUNDARY MAP FOR MORENO VALLEY COMMUNITY SERVICES DISTRICT COMMUNITY FACILITIES DISTRICT NO. 2021-01 (PARKS MAINTENANCE), CITY OF MORENO VALLEY, RIVERSIDE COUNTY, STATE OF CALIFORNIA, PRIOR RECORDED AT BOOK 88 OF MAPS OF ASSESSMENT AND COMMUNITY FACILITIES DISTRICTS AT PAGE 66, IN THE OFFICE OF THE COUNTY RECORDER FOR THE COUNTY OF RIVERSIDE, STATE OF CALIFORNIA.)

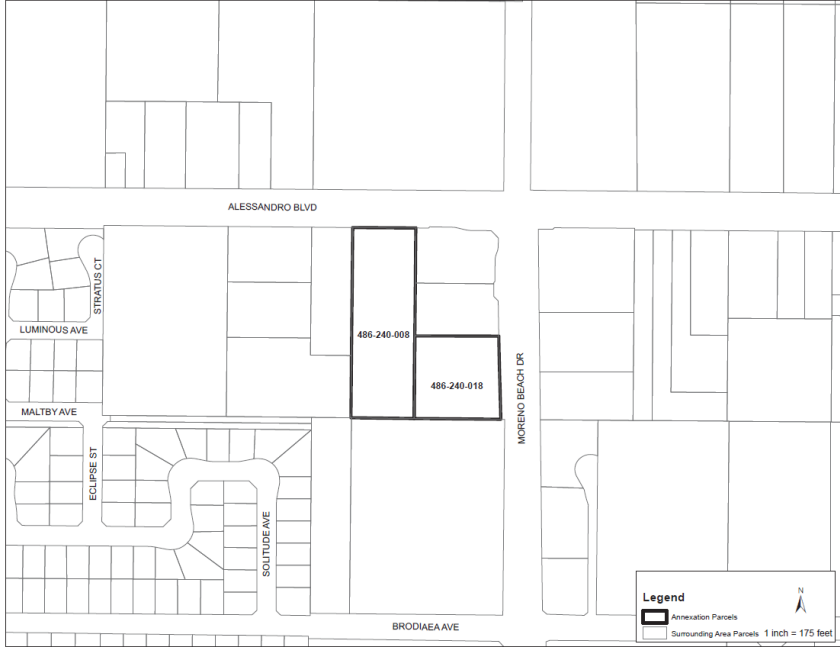

FILED IN THE OFFICE OF THE CITY CLERK OF THE CITY OF MORENO VALLEY THIS ____ DAY OF ____ 20__.

CITY CLERK OF THE CITY OF MORENO VALLEY, ACTING IN THE CAPACITY OF THE SECRETARY OF THE MORENO VALLEY COMMUNITY SERVICES DISTRICT

I HEREBY CERTIFY THAT THE WITHIN MAP SHOWING AMENDED BOUNDARIES OF COMMUNITY FACILITIES DISTRICT NO. 2021-01 (PARKS MAINTENANCE) OF THE MORENO VALLEY COMMUNITY SERVICES DISTRICT, CITY OF MORENO VALLEY, COUNTY OF RIVERSIDE, STATE OF CALIFORNIA, WAS APPROVED BY THE BOARD OF DIRECTORS OF THE MORENO VALLEY COMMUNITY SERVICES DISTRICT AT A REGULAR MEETING THEREOF, HELD ON THE ____ DAY OF ____ 20__ BY ITS RESOLUTION NO. ____.

CITY CLERK OF THE CITY OF MORENO VALLEY, ACTING IN THE CAPACITY OF THE SECRETARY OF THE MORENO VALLEY COMMUNITY SERVICES DISTRICT

FILED THIS ____ DAY OF ____ 20__ AT THE HOUR OF ____ O'CLOCK ____ M. IN THE BOOK ____ PAGE(S) ____ OF MAPS OF ASSESSMENT AND COMMUNITY FACILITIES DISTRICTS AS INSTRUMENT NO. ____ IN THE OFFICE OF THE COUNTY RECORDER OF THE COUNTY OF RIVERSIDE, STATE OF CALIFORNIA.

COUNTY RECORDER
COUNTY OF RIVERSIDE
STATE OF CALIFORNIA

REFERENCE IS MADE TO THAT BOUNDARY MAP OF THE COMMUNITY FACILITIES DISTRICT NO. 2021-01 (PARKS MAINTENANCE) OF THE MORENO VALLEY COMMUNITY SERVICES DISTRICT, RECORDED WITH THE RIVERSIDE COUNTY RECORDER'S OFFICE ON MAY 4, 2021 IN BOOK 88 OF MAPS OF ASSESSMENT AND COMMUNITY FACILITIES DISTRICTS, PAGE 66 AS INSTRUMENT NO. 2021-0208004.

REFERENCE IS FURTHER MADE TO ANNEXATION MAP NO. 4 OF COMMUNITY FACILITIES DISTRICT NO. 2021-01 (PARKS MAINTENANCE) OF THE MORENO VALLEY COMMUNITY SERVICES DISTRICT, CITY OF MORENO VALLEY, COUNTY OF RIVERSIDE, STATE OF CALIFORNIA, TERRITORY PROPOSED FOR ANNEXATION IN THE FUTURE, WITH THE CONDITION THAT PARCELS WITHIN THE TERRITORY MAY BE ANNEXED ONLY WITH THE UNANIMOUS APPROVAL OF THE OWNER OR OWNERS OF EACH PARCEL OR PARCELS AT THE TIME THAT PARCEL OR THOSE PARCELS ARE ANNEXED, RECORDED WITH THE RIVERSIDE COUNTY RECORDER'S OFFICE ON OCTOBER 27, 2021 IN BOOK 87, PAGE 81 OF MAPS OF ASSESSMENT AND COMMUNITY FACILITIES DISTRICTS AS INSTRUMENT NO. 2021-0625742 WHICH DESIGNATED THE TERRITORY SHOWN HEREIN AS TERRITORY FOR FUTURE ANNEXATION TO THE COMMUNITY FACILITIES DISTRICT REFERENCED THEREON.

FOR PARTICULARS OF THE LINES AND DIMENSIONS OF ASSESSOR PARCELS, REFERENCE IS MADE TO THE MAPS OF THE ASSESSOR, COUNTY OF RIVERSIDE, STATE OF CALIFORNIA. THE RIVERSIDE COUNTY ASSESSOR'S MAPS SHALL GOVERN FOR ALL DETAILS CONCERNING THE LINES AND DIMENSIONS OF SUCH LOTS OR PARCELS.

VICINITY MAP



**AMENDMENT NO. 235 TO BOUNDARIES OF MORENO VALLEY COMMUNITY SERVICES DISTRICT
COMMUNITY FACILITIES DISTRICT NO. 2021-01
(PARKS MAINTENANCE)**

**MORENO VALLEY COMMUNITY SERVICES DISTRICT
CITY OF MORENO VALLEY
COUNTY OF RIVERSIDE
STATE OF CALIFORNIA**

(THIS MAP AMENDS, BY ADDING THE ADDITIONAL TERRITORY SHOWN HEREON, THE BOUNDARY MAP FOR MORENO VALLEY COMMUNITY SERVICES DISTRICT COMMUNITY FACILITIES DISTRICT NO. 2021-01 (PARKS MAINTENANCE), CITY OF MORENO VALLEY, RIVERSIDE COUNTY, STATE OF CALIFORNIA, PRIOR RECORDED AT BOOK 86 OF MAPS OF ASSESSMENT AND COMMUNITY FACILITIES DISTRICTS AT PAGE 65, IN THE OFFICE OF THE COUNTY RECORDER FOR THE COUNTY OF RIVERSIDE, STATE OF CALIFORNIA.)

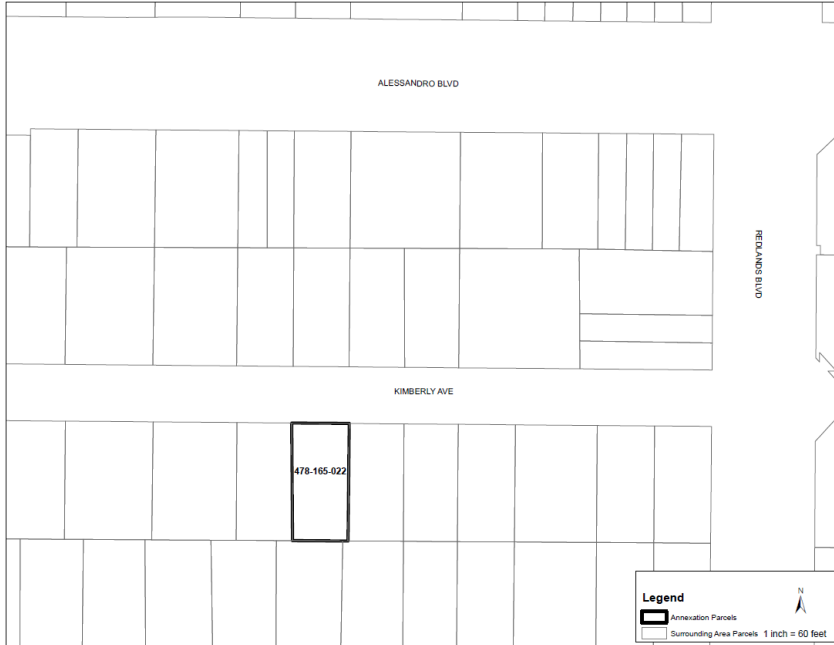

FILED IN THE OFFICE OF THE CITY CLERK OF THE CITY OF MORENO VALLEY THIS _____ DAY OF _____, 20____.

CITY CLERK OF THE CITY OF MORENO VALLEY, ACTING IN THE CAPACITY OF THE SECRETARY OF THE MORENO VALLEY COMMUNITY SERVICES DISTRICT

I HEREBY CERTIFY THAT THE WITHIN MAP SHOWING AMENDED BOUNDARIES OF COMMUNITY FACILITIES DISTRICT NO. 2021-01 (PARKS MAINTENANCE), OF THE MORENO VALLEY COMMUNITY SERVICES DISTRICT, CITY OF MORENO VALLEY, COUNTY OF RIVERSIDE, STATE OF CALIFORNIA, WAS APPROVED BY THE BOARD OF DIRECTORS OF THE MORENO VALLEY COMMUNITY SERVICES DISTRICT AT A REGULAR MEETING THEREOF, HELD ON THE _____ DAY OF _____, 20____ BY ITS RESOLUTION NO. _____.

CITY CLERK OF THE CITY OF MORENO VALLEY, ACTING IN THE CAPACITY OF THE SECRETARY OF THE MORENO VALLEY COMMUNITY SERVICES DISTRICT

FILED THIS _____ DAY OF _____, 20____ AT THE HOUR OF _____ O'CLOCK _____ M. IN THE BOOK _____ PAGE(S) _____ OF MAPS OF ASSESSMENT AND COMMUNITY FACILITIES DISTRICTS AS INSTRUMENT NO. _____ IN THE OFFICE OF THE COUNTY RECORDER OF THE COUNTY OF RIVERSIDE, STATE OF CALIFORNIA.

COUNTY RECORDER
COUNTY OF RIVERSIDE
STATE OF CALIFORNIA

REFERENCE IS MADE TO THAT BOUNDARY MAP OF THE COMMUNITY FACILITIES DISTRICT NO. 2021-01 (PARKS MAINTENANCE) OF THE MORENO VALLEY COMMUNITY SERVICES DISTRICT, RECORDED WITH THE RIVERSIDE COUNTY RECORDER'S OFFICE ON MAY 4, 2021 IN BOOK 86 OF MAPS OF ASSESSMENT AND COMMUNITY FACILITIES DISTRICTS, PAGE 65 AS INSTRUMENT NO. 2021-0209004.

REFERENCE IS FURTHER MADE TO ANNEXATION MAP NO. 4 OF COMMUNITY FACILITIES DISTRICT NO. 2021-01 (PARKS MAINTENANCE) OF THE MORENO VALLEY COMMUNITY SERVICES DISTRICT, CITY OF MORENO VALLEY, COUNTY OF RIVERSIDE, STATE OF CALIFORNIA (TERRITORY PROPOSED FOR ANNEXATION IN THE FUTURE, WITH THE CONDITION THAT PARCELS WITHIN THE TERRITORY MAY BE ANNEXED ONLY WITH THE UNANIMOUS APPROVAL OF THE OWNER OR OWNERS OF EACH PARCEL OR PARCELS AT THE TIME THAT PARCEL, OR THOSE PARCELS ARE ANNEXED), RECORDED WITH THE RIVERSIDE COUNTY RECORDER'S OFFICE ON OCTOBER 27, 2021 IN BOOK 87, PAGE 81 OF MAPS OF ASSESSMENT AND COMMUNITY FACILITIES DISTRICTS AS INSTRUMENT NO. 2021-0058743 WHICH DESIGNATED THE TERRITORY SHOWN HEREIN AS TERRITORY FOR FUTURE ANNEXATION TO THE COMMUNITY FACILITIES DISTRICT REFERENCED THEREON.

FOR PARTICULARS OF THE LINES AND DIMENSIONS OF ASSESSOR PARCELS, REFERENCE IS MADE TO THE MAPS OF THE ASSESSOR, COUNTY OF RIVERSIDE, STATE OF CALIFORNIA. THE RIVERSIDE COUNTY ASSESSOR'S MAPS SHALL GOVERN FOR ALL DETAILS CONCERNING THE LINES AND DIMENSIONS OF SUCH LOTS OR PARCELS.

VICINITY MAP

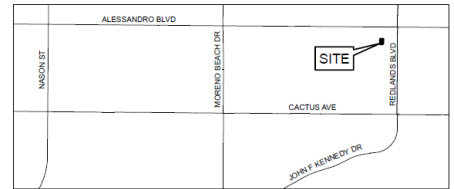

WILLDAN
27368 Via Industria, Suite 200
Riverside, CA 92509
(951) 507-2000

**AMENDMENT NO. 236 TO BOUNDARIES OF MORENO VALLEY COMMUNITY SERVICES DISTRICT
COMMUNITY FACILITIES DISTRICT NO. 2021-01
(PARKS MAINTENANCE)**

**MORENO VALLEY COMMUNITY SERVICES DISTRICT
CITY OF MORENO VALLEY
COUNTY OF RIVERSIDE
STATE OF CALIFORNIA**

(THIS MAP AMENDS, BY ADDING THE ADDITIONAL TERRITORY SHOWN HEREON, THE BOUNDARY MAP FOR MORENO VALLEY COMMUNITY SERVICES DISTRICT COMMUNITY FACILITIES DISTRICT NO. 2021-01 (PARKS MAINTENANCE), CITY OF MORENO VALLEY, RIVERSIDE COUNTY, STATE OF CALIFORNIA, PRIOR RECORDED AT BOOK 88 OF MAPS OF ASSESSMENT AND COMMUNITY FACILITIES DISTRICTS AT PAGE 95, IN THE OFFICE OF THE COUNTY RECORDER FOR THE COUNTY OF RIVERSIDE, STATE OF CALIFORNIA.)



FILED IN THE OFFICE OF THE CITY CLERK OF THE CITY OF MORENO VALLEY THIS ____ DAY OF ____ 20__

CITY CLERK OF THE CITY OF MORENO VALLEY, ACTING IN THE CAPACITY OF THE SECRETARY OF THE MORENO VALLEY COMMUNITY SERVICES DISTRICT

I HEREBY CERTIFY THAT THE WITHIN MAP SHOWING AMENDED BOUNDARIES OF COMMUNITY FACILITIES DISTRICT NO. 2021-01 (PARKS MAINTENANCE), OF THE MORENO VALLEY COMMUNITY SERVICES DISTRICT, CITY OF MORENO VALLEY, COUNTY OF RIVERSIDE, STATE OF CALIFORNIA, WAS APPROVED BY THE BOARD OF DIRECTORS OF THE MORENO VALLEY COMMUNITY SERVICES DISTRICT AT A REGULAR MEETING THEREOF, HELD ON THE ____ DAY OF ____ 20__ BY ITS RESOLUTION NO. _____

CITY CLERK OF THE CITY OF MORENO VALLEY, ACTING IN THE CAPACITY OF THE SECRETARY OF THE MORENO VALLEY COMMUNITY SERVICES DISTRICT

FILED THIS ____ DAY OF ____ 20__ AT THE HOUR OF ____ O'CLOCK ____ M. IN THE BOOK ____ PAGE(S) ____ OF MAPS OF ASSESSMENT AND COMMUNITY FACILITIES DISTRICTS AS INSTRUMENT NO. ____ IN THE OFFICE OF THE COUNTY RECORDER OF THE COUNTY OF RIVERSIDE, STATE OF CALIFORNIA.

COUNTY RECORDER
COUNTY OF RIVERSIDE
STATE OF CALIFORNIA

REFERENCE IS MADE TO THAT BOUNDARY MAP OF THE COMMUNITY FACILITIES DISTRICT NO. 2021-01 (PARKS MAINTENANCE) OF THE MORENO VALLEY COMMUNITY SERVICES DISTRICT, RECORDED WITH THE RIVERSIDE COUNTY RECORDER'S OFFICE ON MAY 4, 2021 IN BOOK 88 OF MAPS OF ASSESSMENT AND COMMUNITY FACILITIES DISTRICTS, PAGE 95 AS INSTRUMENT NO. 2021-028004.

REFERENCE IS FURTHER MADE TO ANNEXATION MAP NO. 4 OF COMMUNITY FACILITIES DISTRICT NO. 2021-01 (PARKS MAINTENANCE) OF THE MORENO VALLEY COMMUNITY SERVICES DISTRICT, CITY OF MORENO VALLEY, COUNTY OF RIVERSIDE, STATE OF CALIFORNIA, TERRITORY PROPOSED FOR ANNEXATION IN THE FUTURE, WITH THE CONDITION THAT PARCELS WITHIN THE TERRITORY MAY BE ANNEXED ONLY WITH THE UNANIMOUS APPROVAL OF THE OWNER OR OWNERS OF EACH PARCEL OR PARCELS AT THE TIME THAT PARCEL OR THOSE PARCELS ARE ANNEXED, RECORDED WITH THE RIVERSIDE COUNTY RECORDER'S OFFICE ON OCTOBER 27, 2021 IN BOOK 87, PAGE 81 OF MAPS OF ASSESSMENT AND COMMUNITY FACILITIES DISTRICTS AS INSTRUMENT NO. 2021-045742 WHICH DESIGNATED THE TERRITORY SHOWN HEREIN AS TERRITORY FOR FUTURE ANNEXATION TO THE COMMUNITY FACILITIES DISTRICT REFERENCED THEREON.

FOR PARTICULARS OF THE LINES AND DIMENSIONS OF ASSESSOR PARCELS, REFERENCE IS MADE TO THE MAPS OF THE ASSESSOR, COUNTY OF RIVERSIDE, STATE OF CALIFORNIA, THE RIVERSIDE COUNTY ASSESSOR'S MAPS SHALL GOVERN FOR ALL DETAILS CONCERNING THE LINES AND DIMENSIONS OF SUCH LOTS OR PARCELS.

VICINITY MAP

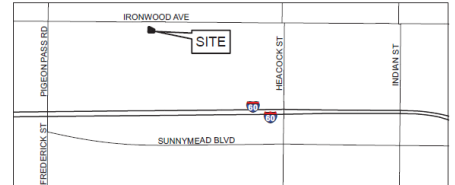

Legend

 1 inch = 100 feet

WILLDAN
 2788 Via Industria, Suite 200
 Temecula, CA 92590
 (951) 987-3500

**AMENDMENT NO. 237 TO BOUNDARIES OF MORENO VALLEY COMMUNITY SERVICES DISTRICT
COMMUNITY FACILITIES DISTRICT NO. 2021-01
(PARKS MAINTENANCE)**

MORENO VALLEY COMMUNITY SERVICES DISTRICT
CITY OF MORENO VALLEY
COUNTY OF RIVERSIDE
STATE OF CALIFORNIA

(THIS MAP AMENDS, BY ADDING THE ADDITIONAL TERRITORY SHOWN HEREON, THE BOUNDARY MAP FOR MORENO VALLEY COMMUNITY SERVICES DISTRICT COMMUNITY FACILITIES DISTRICT NO. 2021-01 (PARKS MAINTENANCE), CITY OF MORENO VALLEY, RIVERSIDE COUNTY, STATE OF CALIFORNIA, PRIOR RECORDED AT BOOK 89 OF MAPS OF ASSESSMENT AND COMMUNITY FACILITIES DISTRICTS AT PAGE 60, IN THE OFFICE OF THE COUNTY RECORDER FOR THE COUNTY OF RIVERSIDE, STATE OF CALIFORNIA.)

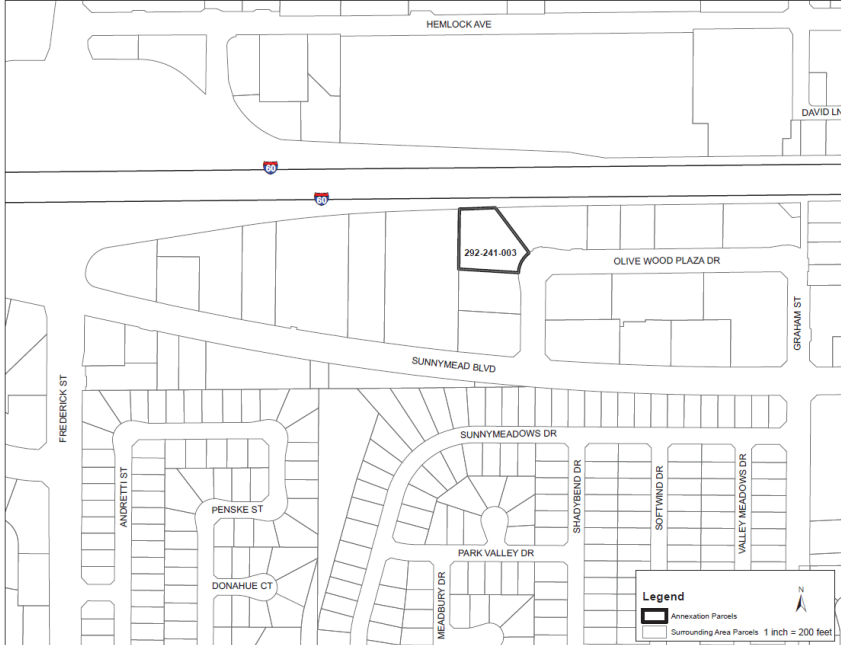

FILED IN THE OFFICE OF THE CITY CLERK OF THE CITY OF MORENO VALLEY THIS _____ DAY OF _____, 20____.

CITY CLERK OF THE CITY OF MORENO VALLEY, ACTING IN THE CAPACITY OF THE SECRETARY OF THE MORENO VALLEY COMMUNITY SERVICES DISTRICT

I HEREBY CERTIFY THAT THE WITHIN MAP SHOWING AMENDED BOUNDARIES OF COMMUNITY FACILITIES DISTRICT NO. 2021-01 (PARKS MAINTENANCE), OF THE MORENO VALLEY COMMUNITY SERVICES DISTRICT, CITY OF MORENO VALLEY, COUNTY OF RIVERSIDE, STATE OF CALIFORNIA, WAS APPROVED BY THE BOARD OF DIRECTORS OF THE MORENO VALLEY COMMUNITY SERVICES DISTRICT AT A REGULAR MEETING THEREOF, HELD ON THE _____ DAY OF _____, 20____, BY ITS RESOLUTION NO. _____.

CITY CLERK OF THE CITY OF MORENO VALLEY, ACTING IN THE CAPACITY OF THE SECRETARY OF THE MORENO VALLEY COMMUNITY SERVICES DISTRICT

FILED THIS _____ DAY OF _____, 20____, AT THE HOUR OF _____ O'CLOCK _____ M. IN THE BOOK _____ PAGE(S) _____ OF MAPS OF ASSESSMENT AND COMMUNITY FACILITIES DISTRICTS AS INSTRUMENT NO. _____ IN THE OFFICE OF THE COUNTY RECORDER OF THE COUNTY OF RIVERSIDE, STATE OF CALIFORNIA.

COUNTY RECORDER
COUNTY OF RIVERSIDE
STATE OF CALIFORNIA

REFERENCE IS MADE TO THAT BOUNDARY MAP OF THE COMMUNITY FACILITIES DISTRICT NO. 2021-01 (PARKS MAINTENANCE) OF THE MORENO VALLEY COMMUNITY SERVICES DISTRICT, RECORDED WITH THE RIVERSIDE COUNTY RECORDERS OFFICE ON MAY 4, 2021 IN BOOK 89 OF MAPS OF ASSESSMENT AND COMMUNITY FACILITIES DISTRICTS, PAGE 60 AS INSTRUMENT NO. 2021-028004.

REFERENCE IS FURTHER MADE TO ANNEXATION MAP NO. 4 OF COMMUNITY FACILITIES DISTRICT NO. 2021-01 (PARKS MAINTENANCE) OF THE MORENO VALLEY COMMUNITY SERVICES DISTRICT, CITY OF MORENO VALLEY, COUNTY OF RIVERSIDE, STATE OF CALIFORNIA, TERRITORY PROPOSED FOR ANNEXATION IN THE FUTURE, WITH THE CONDITION THAT PARCELS WITHIN THE TERRITORY MAY BE ANNEXED ONLY WITH THE UNANIMOUS APPROVAL OF THE OWNER OR OWNERS OF EACH PARCEL OR PARCELS AT THE TIME THAT PARCEL OR THOSE PARCELS ARE ANNEXED, RECORDED WITH THE RIVERSIDE COUNTY RECORDERS OFFICE ON OCTOBER 27, 2021 IN BOOK 87, PAGE 81 OF MAPS OF ASSESSMENT AND COMMUNITY FACILITIES DISTRICTS AS INSTRUMENT NO. 2021-005742 WHICH DESIGNATED THE TERRITORY SHOWN HEREON AS TERRITORY FOR FUTURE ANNEXATION TO THE COMMUNITY FACILITIES DISTRICT REFERENCED THEREON.

FOR PARTICULARS OF THE LINES AND DIMENSIONS OF ASSESSOR PARCELS, REFERENCE IS MADE TO THE MAPS OF THE ASSESSOR, COUNTY OF RIVERSIDE, STATE OF CALIFORNIA. THE RIVERSIDE COUNTY ASSESSOR'S MAPS SHALL GOVERN FOR ALL DETAILS CONCERNING THE LINES AND DIMENSIONS OF SUCH LOTS OR PARCELS.

VICINITY MAP

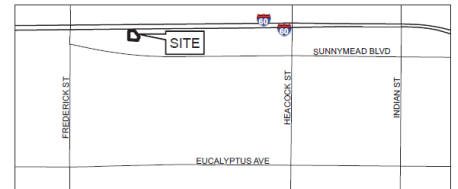

WILLDAN
27368 Via Induarte, Suite 200
Brea, CA 92603
(951) 857-2620

**AMENDMENT NO. 239 TO BOUNDARIES OF MORENO VALLEY COMMUNITY SERVICES DISTRICT
COMMUNITY FACILITIES DISTRICT NO. 2021-01
(PARKS MAINTENANCE)**

**MORENO VALLEY COMMUNITY SERVICES DISTRICT
CITY OF MORENO VALLEY
COUNTY OF RIVERSIDE
STATE OF CALIFORNIA**

(THIS MAP AMENDS, BY ADDING THE ADDITIONAL TERRITORY SHOWN HEREON, THE BOUNDARY MAP FOR MORENO VALLEY COMMUNITY SERVICES DISTRICT COMMUNITY FACILITIES DISTRICT NO. 2021-01 (PARKS MAINTENANCE), CITY OF MORENO VALLEY, RIVERSIDE COUNTY, STATE OF CALIFORNIA, PRIOR RECORDED AT BOOK 86 OF MAPS OF ASSESSMENT AND COMMUNITY FACILITIES DISTRICTS AT PAGE 68, IN THE OFFICE OF THE COUNTY RECORDER FOR THE COUNTY OF RIVERSIDE, STATE OF CALIFORNIA.)

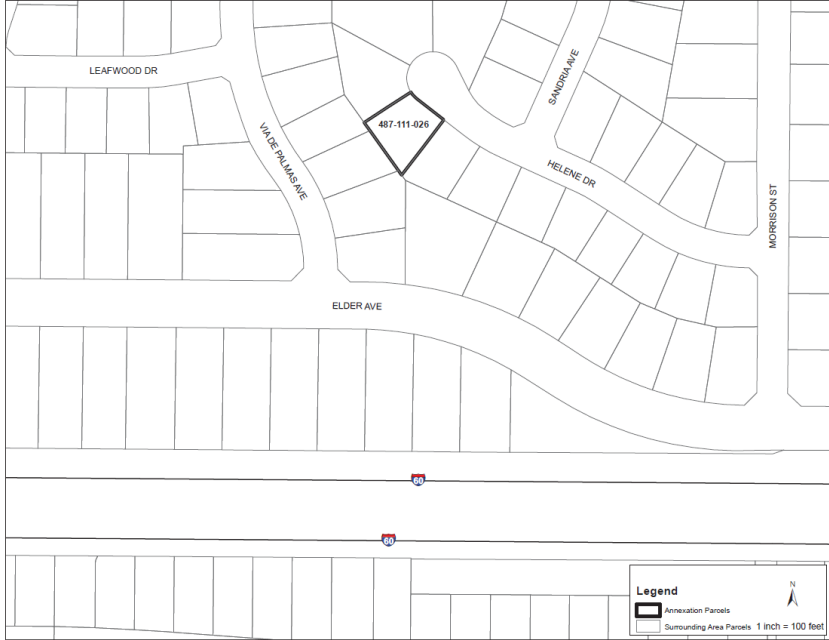

FILED IN THE OFFICE OF THE CITY CLERK OF THE CITY OF MORENO VALLEY THIS ____ DAY OF _____, 20__.

CITY CLERK OF THE CITY OF MORENO VALLEY, ACTING IN THE CAPACITY OF THE SECRETARY OF THE MORENO VALLEY COMMUNITY SERVICES DISTRICT

I HEREBY CERTIFY THAT THE WITHIN MAP SHOWING AMENDED BOUNDARIES OF COMMUNITY FACILITIES DISTRICT NO. 2021-01 (PARKS MAINTENANCE), OF THE MORENO VALLEY COMMUNITY SERVICES DISTRICT, CITY OF MORENO VALLEY, COUNTY OF RIVERSIDE, STATE OF CALIFORNIA, WAS APPROVED BY THE BOARD OF DIRECTORS OF THE MORENO VALLEY COMMUNITY SERVICES DISTRICT AT A REGULAR MEETING THEREOF, HELD ON THE ____ DAY OF _____, 20__ BY ITS RESOLUTION NO. _____.

CITY CLERK OF THE CITY OF MORENO VALLEY, ACTING IN THE CAPACITY OF THE SECRETARY OF THE MORENO VALLEY COMMUNITY SERVICES DISTRICT

FILED THIS ____ DAY OF _____, 20__ AT THE HOUR OF ____ O'CLOCK ____ M. IN THE BOOK ____ PAGE(S) ____ OF MAPS OF ASSESSMENT AND COMMUNITY FACILITIES DISTRICTS AS INSTRUMENT NO. _____ IN THE OFFICE OF THE COUNTY RECORDER OF THE COUNTY OF RIVERSIDE, STATE OF CALIFORNIA.

COUNTY RECORDER
COUNTY OF RIVERSIDE
STATE OF CALIFORNIA

REFERENCE IS MADE TO THAT BOUNDARY MAP OF THE COMMUNITY FACILITIES DISTRICT NO. 2021-01 (PARKS MAINTENANCE) OF THE MORENO VALLEY COMMUNITY SERVICES DISTRICT, RECORDED WITH THE RIVERSIDE COUNTY RECORDER'S OFFICE ON MAY 4, 2021 IN BOOK 86 OF MAPS OF ASSESSMENT AND COMMUNITY FACILITIES DISTRICTS, PAGE 68 AS INSTRUMENT NO. 2021-0280004.

REFERENCE IS FURTHER MADE TO ANNEXATION MAP NO. 4 OF COMMUNITY FACILITIES DISTRICT NO. 2021-01 (PARKS MAINTENANCE) OF THE MORENO VALLEY COMMUNITY SERVICES DISTRICT, CITY OF MORENO VALLEY, COUNTY OF RIVERSIDE, STATE OF CALIFORNIA TERRITORY PROPOSED FOR ANNEXATION IN THE FUTURE, WITH THE CONDITION THAT PARCELS WITHIN THE TERRITORY MAY BE ANNEXED ONLY WITH THE UNANIMOUS APPROVAL OF THE OWNER OR OWNERS OF EACH PARCEL, OR PARCELS AT THE TIME THAT PARCEL OR THOSE PARCELS ARE ANNEXED) RECORDED WITH THE RIVERSIDE COUNTY RECORDER'S OFFICE ON OCTOBER 27, 2021 IN BOOK 87, PAGE 81 OF MAPS OF ASSESSMENT AND COMMUNITY FACILITIES DISTRICTS AS INSTRUMENT NO. 2021-053742 WHICH DESIGNATED THE TERRITORY SHOWN HEREIN AS TERRITORY FOR FUTURE ANNEXATION TO THE COMMUNITY FACILITIES DISTRICT REFERENCED THEREON.

FOR PARTICULARS OF THE LINES AND DIMENSIONS OF ASSESSOR PARCELS, REFERENCE IS MADE TO THE MAPS OF THE ASSESSOR, COUNTY OF RIVERSIDE, STATE OF CALIFORNIA. THE RIVERSIDE COUNTY ASSESSOR'S MAPS SHALL GOVERN FOR ALL DETAILS CONCERNING THE LINES AND DIMENSIONS OF SUCH LOTS OR PARCELS.

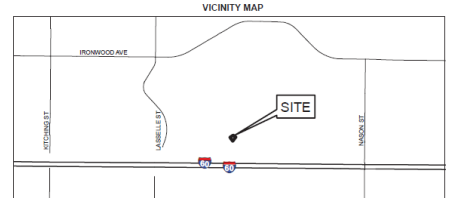

WILLDAN
27364 Via Industrial, Suite 200
Temecula, CA 92590
(951) 967-0000

**AMENDMENT NO. 240 TO BOUNDARIES OF MORENO VALLEY COMMUNITY SERVICES DISTRICT
COMMUNITY FACILITIES DISTRICT NO. 2021-01
(PARKS MAINTENANCE)**

**MORENO VALLEY COMMUNITY SERVICES DISTRICT
CITY OF MORENO VALLEY
COUNTY OF RIVERSIDE
STATE OF CALIFORNIA**

(THIS MAP AMENDS, BY ADDING THE ADDITIONAL TERRITORY SHOWN HEREON, THE BOUNDARY MAP FOR MORENO VALLEY COMMUNITY SERVICES DISTRICT COMMUNITY FACILITIES DISTRICT NO. 2021-01 (PARKS MAINTENANCE), CITY OF MORENO VALLEY, RIVERSIDE COUNTY, STATE OF CALIFORNIA, PRIOR RECORDED AT BOOK 88 OF MAPS OF ASSESSMENT AND COMMUNITY FACILITIES DISTRICTS AT PAGE 95, IN THE OFFICE OF THE COUNTY RECORDER FOR THE COUNTY OF RIVERSIDE, STATE OF CALIFORNIA.)

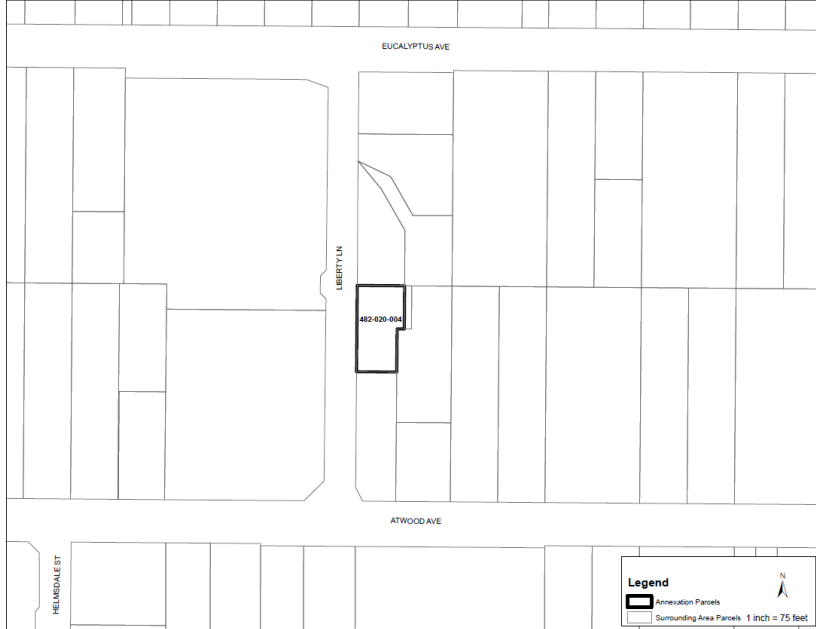

FILED IN THE OFFICE OF THE CITY CLERK OF THE CITY OF MORENO VALLEY THIS ____ DAY OF _____, 20__.

CITY CLERK OF THE CITY OF MORENO VALLEY, ACTING IN THE CAPACITY OF THE SECRETARY OF THE MORENO VALLEY COMMUNITY SERVICES DISTRICT

I HEREBY CERTIFY THAT THE WITHIN MAP SHOWING AMENDED BOUNDARIES OF COMMUNITY FACILITIES DISTRICT NO. 2021-01 (PARKS MAINTENANCE) OF THE MORENO VALLEY COMMUNITY SERVICES DISTRICT, CITY OF MORENO VALLEY, COUNTY OF RIVERSIDE, STATE OF CALIFORNIA, WAS APPROVED BY THE BOARD OF DIRECTORS OF THE MORENO VALLEY COMMUNITY SERVICES DISTRICT AT A REGULAR MEETING THEREOF, HELD ON THE ____ DAY OF _____, 20__, BY ITS RESOLUTION NO. _____.

CITY CLERK OF THE CITY OF MORENO VALLEY, ACTING IN THE CAPACITY OF THE SECRETARY OF THE MORENO VALLEY COMMUNITY SERVICES DISTRICT

FILED THIS ____ DAY OF _____, 20__ AT THE HOUR OF ____ O'CLOCK ____ M. IN THE BOOK ____ OF MAPS OF ASSESSMENT AND COMMUNITY FACILITIES DISTRICTS AS INSTRUMENT NO. _____ IN THE OFFICE OF THE COUNTY RECORDER OF THE COUNTY OF RIVERSIDE, STATE OF CALIFORNIA.

COUNTY RECORDER
COUNTY OF RIVERSIDE
STATE OF CALIFORNIA

REFERENCE IS MADE TO THAT BOUNDARY MAP OF THE COMMUNITY FACILITIES DISTRICT NO. 2021-01 (PARKS MAINTENANCE) OF THE MORENO VALLEY COMMUNITY SERVICES DISTRICT, RECORDED WITH THE RIVERSIDE COUNTY RECORDER'S OFFICE ON MAY 4, 2021 IN BOOK 88 OF MAPS OF ASSESSMENT AND COMMUNITY FACILITIES DISTRICTS, PAGE 95 AS INSTRUMENT NO. 2021-0200204.

REFERENCE IS FURTHER MADE TO ANNEXATION MAP NO. 4 OF COMMUNITY FACILITIES DISTRICT NO. 2021-01 (PARKS MAINTENANCE) OF THE MORENO VALLEY COMMUNITY SERVICES DISTRICT, CITY OF MORENO VALLEY, COUNTY OF RIVERSIDE, STATE OF CALIFORNIA (TERRITORY PROPOSED FOR ANNEXATION IN THE FUTURE, WITH THE CONDITION THAT PARCELS WITHIN THE TERRITORY MAY BE ANNEXED ONLY WITH THE UNANIMOUS APPROVAL OF THE OWNER OR OWNERS OF EACH PARCEL OR PARCELS AT THE TIME THAT PARCEL OR THOSE PARCELS ARE ANNEXED) RECORDED WITH THE RIVERSIDE COUNTY RECORDER'S OFFICE ON OCTOBER 27, 2021 IN BOOK 87, PAGE 81 OF MAPS OF ASSESSMENT AND COMMUNITY FACILITIES DISTRICTS AS INSTRUMENT NO. 2021-0552742, WHICH DESIGNATED THE TERRITORY SHOWN HEREON AS TERRITORY FOR FUTURE ANNEXATION TO THE COMMUNITY FACILITIES DISTRICT REFERENCED THEREON.

FOR PARTICULARS OF THE LINES AND DIMENSIONS OF ASSESSOR PARCELS, REFERENCE IS MADE TO THE MAPS OF THE ASSESSOR, COUNTY OF RIVERSIDE, STATE OF CALIFORNIA. THE RIVERSIDE COUNTY ASSESSOR'S MAPS SHALL GOVERN FOR ALL DETAILS CONCERNING THE LINES AND DIMENSIONS OF SUCH LOTS OR PARCELS.

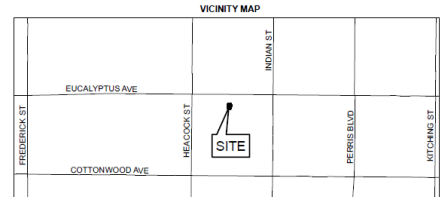

WILLDAN
27861 Via Industriosa, Suite 200
Terrebonne, CA 92556
(951) 842-8000

**AMENDMENT NO. 241 TO BOUNDARIES OF MORENO VALLEY COMMUNITY SERVICES DISTRICT
COMMUNITY FACILITIES DISTRICT NO. 2021-01
(PARKS MAINTENANCE)**

**MORENO VALLEY COMMUNITY SERVICES DISTRICT
CITY OF MORENO VALLEY
COUNTY OF RIVERSIDE
STATE OF CALIFORNIA**

(THIS MAP AMENDS, BY ADDING THE ADDITIONAL TERRITORY SHOWN HEREON, THE BOUNDARY MAP FOR MORENO VALLEY COMMUNITY SERVICES DISTRICT COMMUNITY FACILITIES DISTRICT NO. 2021-01 (PARKS MAINTENANCE), CITY OF MORENO VALLEY, RIVERSIDE COUNTY, STATE OF CALIFORNIA, PRIOR RECORDED AT BOOK 88 OF MAPS OF ASSESSMENT AND COMMUNITY FACILITIES DISTRICTS AT PAGE 68, IN THE OFFICE OF THE COUNTY RECORDER FOR THE COUNTY OF RIVERSIDE, STATE OF CALIFORNIA.)



FILED IN THE OFFICE OF THE CITY CLERK OF THE CITY OF MORENO VALLEY THIS _____ DAY OF _____, 20____.

CITY CLERK OF THE CITY OF MORENO VALLEY, ACTING IN THE CAPACITY OF THE SECRETARY OF THE MORENO VALLEY COMMUNITY SERVICES DISTRICT

I HEREBY CERTIFY THAT THE WITHIN MAP SHOWING AMENDED BOUNDARIES OF COMMUNITY FACILITIES DISTRICT NO. 2021-01 (PARKS MAINTENANCE), OF THE MORENO VALLEY COMMUNITY SERVICES DISTRICT, CITY OF MORENO VALLEY, COUNTY OF RIVERSIDE, STATE OF CALIFORNIA, WAS APPROVED BY THE BOARD OF DIRECTORS OF THE MORENO VALLEY COMMUNITY SERVICES DISTRICT AT A REGULAR MEETING THEREOF, HELD ON THE _____ DAY OF _____, 20____, BY ITS RESOLUTION NO. _____.

CITY CLERK OF THE CITY OF MORENO VALLEY, ACTING IN THE CAPACITY OF THE SECRETARY OF THE MORENO VALLEY COMMUNITY SERVICES DISTRICT

FILED THIS _____ DAY OF _____, 20____, AT THE HOUR OF _____ O'CLOCK _____ M. IN THE BOOK _____ PAGE(S) _____ OF MAPS OF ASSESSMENT AND COMMUNITY FACILITIES DISTRICTS AS INSTRUMENT NO. _____ IN THE OFFICE OF THE COUNTY RECORDER OF THE COUNTY OF RIVERSIDE, STATE OF CALIFORNIA.

COUNTY RECORDER
COUNTY OF RIVERSIDE
STATE OF CALIFORNIA

REFERENCE IS MADE TO THAT BOUNDARY MAP OF THE COMMUNITY FACILITIES DISTRICT NO. 2021-01 (PARKS MAINTENANCE) OF THE MORENO VALLEY COMMUNITY SERVICES DISTRICT, RECORDED WITH THE RIVERSIDE COUNTY RECORDER'S OFFICE ON MAY 4, 2021 IN BOOK 88 OF MAPS OF ASSESSMENT AND COMMUNITY FACILITIES DISTRICTS, PAGE 68 AS INSTRUMENT NO. 2021-0289004.

REFERENCE IS FURTHER MADE TO ANNEXATION MAP NO. 4 OF COMMUNITY FACILITIES DISTRICT NO. 2021-01 (PARKS MAINTENANCE) OF THE MORENO VALLEY COMMUNITY SERVICES DISTRICT, CITY OF MORENO VALLEY, COUNTY OF RIVERSIDE, STATE OF CALIFORNIA, TERRITORY PROPOSED FOR ANNEXATION IN THE FUTURE, WITH THE CONDITION THAT PARCELS WITHIN THE TERRITORY MAY BE ANNEXED ONLY WITH THE UNANIMOUS APPROVAL OF THE OWNER OR OWNERS OF EACH PARCEL OR PARCELS AT THE TIME THAT PARCEL OR THOSE PARCELS ARE ANNEXED) RECORDED WITH THE RIVERSIDE COUNTY RECORDER'S OFFICE ON OCTOBER 27, 2021 IN BOOK 87, PAGE 81 OF MAPS OF ASSESSMENT AND COMMUNITY FACILITIES DISTRICTS AS INSTRUMENT NO. 2021-063742 WHICH DESIGNATED THE TERRITORY SHOWN HEREIN AS TERRITORY FOR FUTURE ANNEXATION TO THE COMMUNITY FACILITIES DISTRICT REFERENCED THEREON.

FOR PARTICULARS OF THE LINES AND DIMENSIONS OF ASSESSOR PARCELS, REFERENCE IS MADE TO THE MAPS OF THE ASSESSOR, COUNTY OF RIVERSIDE, STATE OF CALIFORNIA. THE RIVERSIDE COUNTY ASSESSOR'S MAPS SHALL GOVERN FOR ALL DETAILS CONCERNING THE LINES AND DIMENSIONS OF SUCH LOTS OR PARCELS.

VICINITY MAP



**AMENDMENT NO. 242 TO BOUNDARIES OF MORENO VALLEY COMMUNITY SERVICES DISTRICT
COMMUNITY FACILITIES DISTRICT NO. 2021-01
(PARKS MAINTENANCE)**

**MORENO VALLEY COMMUNITY SERVICES DISTRICT
CITY OF MORENO VALLEY
COUNTY OF RIVERSIDE
STATE OF CALIFORNIA**

(THIS MAP AMENDS, BY ADDING THE ADDITIONAL TERRITORY SHOWN HEREON, THE BOUNDARY MAP FOR MORENO VALLEY COMMUNITY SERVICES DISTRICT COMMUNITY FACILITIES DISTRICT NO. 2021-01 (PARKS MAINTENANCE), CITY OF MORENO VALLEY, RIVERSIDE COUNTY, STATE OF CALIFORNIA, PRIOR RECORDED AT BOOK 88 OF MAPS OF ASSESSMENT AND COMMUNITY FACILITIES DISTRICTS AT PAGE 86, IN THE OFFICE OF THE COUNTY RECORDER FOR THE COUNTY OF RIVERSIDE, STATE OF CALIFORNIA.)

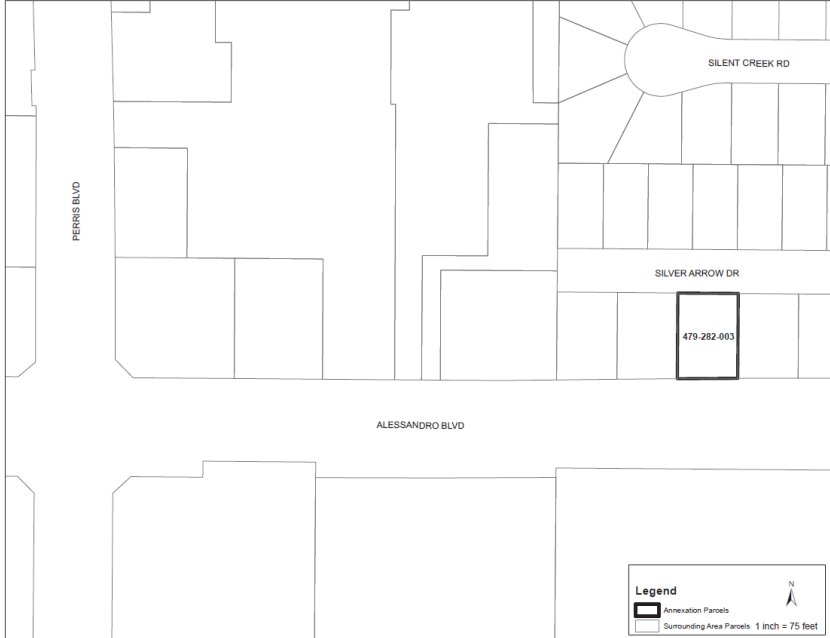

FILED IN THE OFFICE OF THE CITY CLERK OF THE CITY OF MORENO VALLEY THIS ____ DAY OF ____ 20__.

CITY CLERK OF THE CITY OF MORENO VALLEY, ACTING IN THE CAPACITY OF THE SECRETARY OF THE MORENO VALLEY COMMUNITY SERVICES DISTRICT.

I HEREBY CERTIFY THAT THE WITHIN MAP SHOWING AMENDED BOUNDARIES OF COMMUNITY FACILITIES DISTRICT NO. 2021-01 (PARKS MAINTENANCE), OF THE MORENO VALLEY COMMUNITY SERVICES DISTRICT, CITY OF MORENO VALLEY, COUNTY OF RIVERSIDE, STATE OF CALIFORNIA, WAS APPROVED BY THE BOARD OF DIRECTORS OF THE MORENO VALLEY COMMUNITY SERVICES DISTRICT AT A REGULAR MEETING THEREOF, HELD ON THE ____ DAY OF ____ 20__ BY ITS RESOLUTION NO. ____.

CITY CLERK OF THE CITY OF MORENO VALLEY, ACTING IN THE CAPACITY OF THE SECRETARY OF THE MORENO VALLEY COMMUNITY SERVICES DISTRICT.

FILED THIS ____ DAY OF ____ 20__ AT THE HOUR OF ____ O'CLOCK ____ M. IN THE BOOK ____ PAGE(S) ____ OF MAPS OF ASSESSMENT AND COMMUNITY FACILITIES DISTRICTS AS INSTRUMENT NO. ____ IN THE OFFICE OF THE COUNTY RECORDER OF THE COUNTY OF RIVERSIDE, STATE OF CALIFORNIA.

COUNTY RECORDER
COUNTY OF RIVERSIDE
STATE OF CALIFORNIA

REFERENCE IS MADE TO THAT BOUNDARY MAP OF THE COMMUNITY FACILITIES DISTRICT NO. 2021-01 (PARKS MAINTENANCE) OF THE MORENO VALLEY COMMUNITY SERVICES DISTRICT, RECORDED WITH THE RIVERSIDE COUNTY RECORDERS OFFICE ON MAY 4, 2021 IN BOOK 88 OF MAPS OF ASSESSMENT AND COMMUNITY FACILITIES DISTRICTS, PAGE 86 AS INSTRUMENT NO. 2021-028004.

REFERENCE IS FURTHER MADE TO ANNEXATION MAP NO. 4 OF COMMUNITY FACILITIES DISTRICT NO. 2021-01 (PARKS MAINTENANCE) OF THE MORENO VALLEY COMMUNITY SERVICES DISTRICT, CITY OF MORENO VALLEY, COUNTY OF RIVERSIDE, STATE OF CALIFORNIA (TERRITORY PROPOSED FOR ANNEXATION IN THE FUTURE, WITH THE CONDITION THAT PARCELS WITHIN THE TERRITORY MAY BE ANNEXED ONLY WITH THE UNANIMOUS APPROVAL OF THE OWNER OR OWNERS OF EACH PARCEL OR PARCELS AT THE TIME THAT PARCEL OR THOSE PARCELS ARE ANNEXED) RECORDED WITH THE RIVERSIDE COUNTY RECORDERS OFFICE ON OCTOBER 27, 2021 IN BOOK 87, PAGE 81 OF MAPS OF ASSESSMENT AND COMMUNITY FACILITIES DISTRICTS AS INSTRUMENT NO. 2021-005742 WHICH DESIGNATED THE TERRITORY SHOWN HEREIN AS TERRITORY FOR FUTURE ANNEXATION TO THE COMMUNITY FACILITIES DISTRICT REFERENCED THEREON.

FOR PARTICULARS OF THE LINES AND DIMENSIONS OF ASSESSOR PARCELS, REFERENCE IS MADE TO THE MAPS OF THE ASSESSOR, COUNTY OF RIVERSIDE, STATE OF CALIFORNIA. THE RIVERSIDE COUNTY ASSESSOR'S MAPS SHALL GOVERN FOR ALL DETAILS CONCERNING THE LINES AND DIMENSIONS OF SUCH LOTS OR PARCELS.

VICINITY MAP

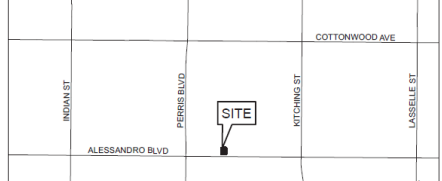

WILLDAN
2786 Via Industria, Suite 200
Torrance, CA 90503
(561) 901-2600

**AMENDMENT NO. 245 TO BOUNDARIES OF MORENO VALLEY COMMUNITY SERVICES DISTRICT
COMMUNITY FACILITIES DISTRICT NO. 2021-01
(PARKS MAINTENANCE)**

**MORENO VALLEY COMMUNITY SERVICES DISTRICT
CITY OF MORENO VALLEY
COUNTY OF RIVERSIDE
STATE OF CALIFORNIA**

(THIS MAP AMENDS, BY ADDING THE ADDITIONAL TERRITORY SHOWN HEREON, THE BOUNDARY MAP FOR MORENO VALLEY COMMUNITY SERVICES DISTRICT COMMUNITY FACILITIES DISTRICT NO. 2021-01 (PARKS MAINTENANCE), CITY OF MORENO VALLEY, RIVERSIDE COUNTY, STATE OF CALIFORNIA, PRIOR RECORDED AT BOOK 86 OF MAPS OF ASSESSMENT AND COMMUNITY FACILITIES DISTRICTS AT PAGE 96, IN THE OFFICE OF THE COUNTY RECORDER FOR THE COUNTY OF RIVERSIDE, STATE OF CALIFORNIA.)

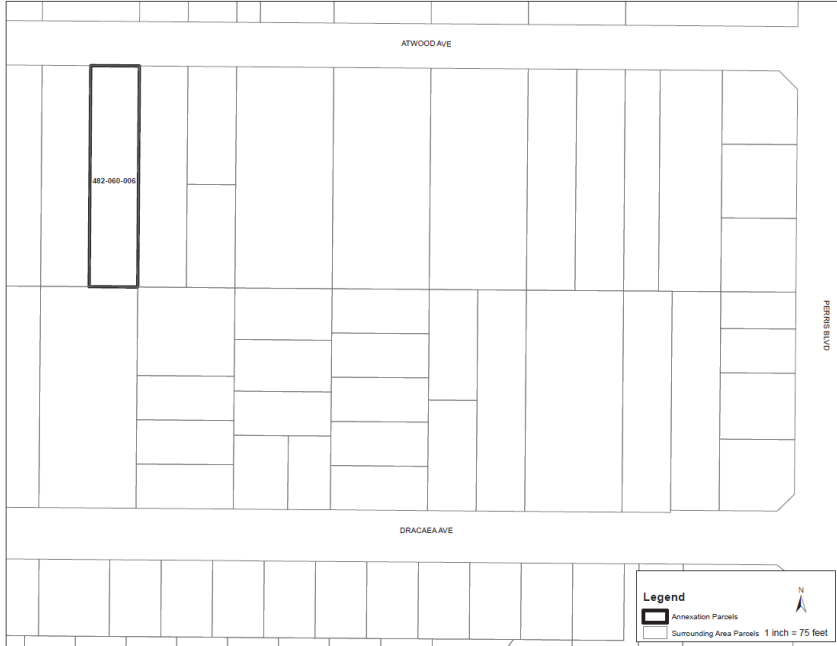

FILED IN THE OFFICE OF THE CITY CLERK OF THE CITY OF MORENO VALLEY THIS ____ DAY OF ____ 20__.

CITY CLERK OF THE CITY OF MORENO VALLEY, ACTING IN THE CAPACITY OF THE SECRETARY OF THE MORENO VALLEY COMMUNITY SERVICES DISTRICT

I HEREBY CERTIFY THAT THE WITHIN MAP SHOWING AMENDED BOUNDARIES OF COMMUNITY FACILITIES DISTRICT NO. 2021-01 (PARKS MAINTENANCE) OF THE MORENO VALLEY COMMUNITY SERVICES DISTRICT, CITY OF MORENO VALLEY, COUNTY OF RIVERSIDE, STATE OF CALIFORNIA, WAS APPROVED BY THE BOARD OF DIRECTORS OF THE MORENO VALLEY COMMUNITY SERVICES DISTRICT AT A REGULAR MEETING THEREOF, HELD ON THE ____ DAY OF ____ 20__ BY ITS RESOLUTION NO. ____.

CITY CLERK OF THE CITY OF MORENO VALLEY, ACTING IN THE CAPACITY OF THE SECRETARY OF THE MORENO VALLEY COMMUNITY SERVICES DISTRICT

FILED THIS ____ DAY OF ____ 20__ AT THE HOUR OF ____ O'CLOCK ____ M IN THE BOOK ____ PAGE(S) ____ OF MAPS OF ASSESSMENT AND COMMUNITY FACILITIES DISTRICTS AS INSTRUMENT NO. ____ IN THE OFFICE OF THE COUNTY RECORDER OF THE COUNTY OF RIVERSIDE, STATE OF CALIFORNIA.

COUNTY RECORDER
COUNTY OF RIVERSIDE
STATE OF CALIFORNIA

REFERENCE IS MADE TO THAT BOUNDARY MAP OF THE COMMUNITY FACILITIES DISTRICT NO. 2021-01 (PARKS MAINTENANCE) OF THE MORENO VALLEY COMMUNITY SERVICES DISTRICT, RECORDED WITH THE RIVERSIDE COUNTY RECORDER'S OFFICE ON MAY 4, 2021 IN BOOK 86 OF MAPS OF ASSESSMENT AND COMMUNITY FACILITIES DISTRICTS, PAGE 96 AS INSTRUMENT NO. 2021-028004.

REFERENCE IS FURTHER MADE TO ANNEXATION MAP NO. 4 OF COMMUNITY FACILITIES DISTRICT NO. 2021-01 (PARKS MAINTENANCE) OF THE MORENO VALLEY COMMUNITY SERVICES DISTRICT, CITY OF MORENO VALLEY, COUNTY OF RIVERSIDE, STATE OF CALIFORNIA (TERRITORY PROPOSED FOR ANNEXATION IN THE FUTURE, WITH THE CONDITION THAT PARCELS WITHIN THE TERRITORY MAY BE ANNEXED ONLY WITH THE UNANIMOUS APPROVAL OF THE OWNER OR OWNERS OF EACH PARCEL OR PARCELS AT THE TIME THAT PARCEL OR THOSE PARCELS ARE ANNEXED) RECORDED WITH THE RIVERSIDE COUNTY RECORDER'S OFFICE ON OCTOBER 27, 2021 IN BOOK 87, PAGE 81 OF MAPS OF ASSESSMENT AND COMMUNITY FACILITIES DISTRICTS AS INSTRUMENT NO. 2021-0656742 WHICH DESIGNATED THE TERRITORY SHOWN HEREIN AS TERRITORY FOR FUTURE ANNEXATION TO THE COMMUNITY FACILITIES DISTRICT REFERENCED THEREON.

FOR PARTICULARS OF THE LINES AND DIMENSIONS OF ASSESSOR PARCELS, REFERENCE IS MADE TO THE MAPS OF THE ASSESSOR, COUNTY OF RIVERSIDE, STATE OF CALIFORNIA. THE RIVERSIDE COUNTY ASSESSOR'S MAPS SHALL GOVERN FOR ALL DETAILS CONCERNING THE LINES AND DIMENSIONS OF SUCH LOTS OR PARCELS.

VICINITY MAP

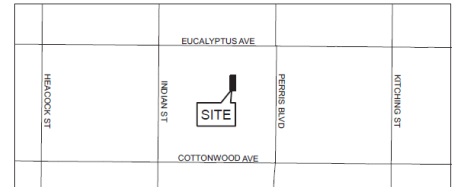

WILLDAN
27861 Via Montezuma, Suite 200
Temecula, CA 92590
(951) 997-1089